

SANGGAR DANSA DI YOGYAKARTA

KERANGKA POLA PIKIR

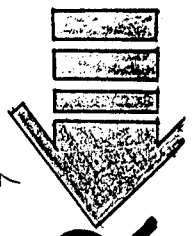

PENGERTIAN DANCE
DI
SANGGAR DANSA
YOGYAKARTA

SARANA PENDIDIKAN INFORMAL
YG MEMBUKA KELAS DANSA
BAGI PEMULA HINGGA TINGKAT MAHIR

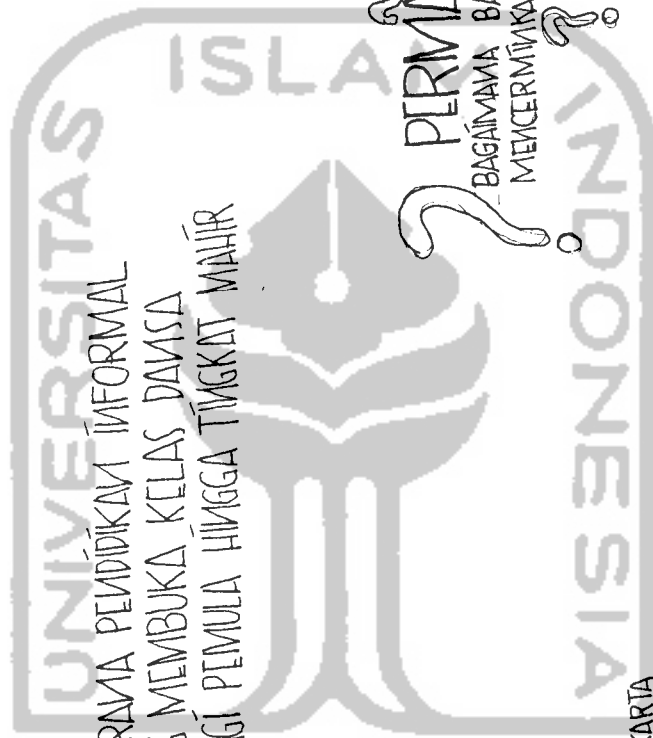

PERMASALAHAN?
BAGAIMANA BANGUNAN SANGGAR YANG DAPAT
MENCERMINKAN CITRA GERAKAN DANSA?

LATAR BELAKANG

SEMAKIN BANYAK PEMINAT DANSA DI YOGYAKARTA
MENDORONG MUNCULNYA SANGGAR-2 DANSA MAMUJI
SANGGAR-2 TSB BELUM DPT MEMAMPUNG KEG. DANSA DGN
BAIK KRNI MASIH DI SATUKAN DGN KEG BALET DAN SEJAM



LOKASI TERPILIH

■ KOTA MADIYA
YOGYAKARTA

■ KOTA PENDIDIKAN
YG SEKOR PENDUKUNG
FASILITAS PENDIDIKAN
BERKEMBANG PESACE

■ JL. GOTOING ROYONG
DI KAWASAN PENDIDIKAN
DAN HUMILAN

JLN. TILMUBAN UGAMA
JL. MAGELANG
- JL. A.M. SAMGAJI

MRPKAN JALUR
BERCIERA PARWISATA



CITRA

"SEBETULNYA HANYA MENUNJUKAN SUATU GAMBAR-AN (IMAGE) SUATU KEJAN PENGHAYATAN YANG MENANGKAP ARTI BAGI SESEORANG"

WASU CITRA, YB MANGULHIJAYA

ZAMAN TEKNOLOGI MODERN MEMBAWA PERUBAHAN? PULA PADA PRINSIP? BERARSITEKTUR

WASU CITRA, YB MANGULHIJAYA

perancangan yang dilakukan mengacu pada langkah desain ANTHONY C. ANTONIADES dengan memaknai dan mengartikulasikannya kedalam bangunan dengan penjabaran makna dan gerak yang kemudian dapat diwujudkan ke dalam bentuk melalui elemen-elemen dalam alam ARSITEKTUR

anthony c. antoniades, poetic of Architecture



TOKOH ALIRAN ACUAN DISAIN ← NEO MODERN ADL SANGGAR DANSA DI YOGYAKARTA AMEIER

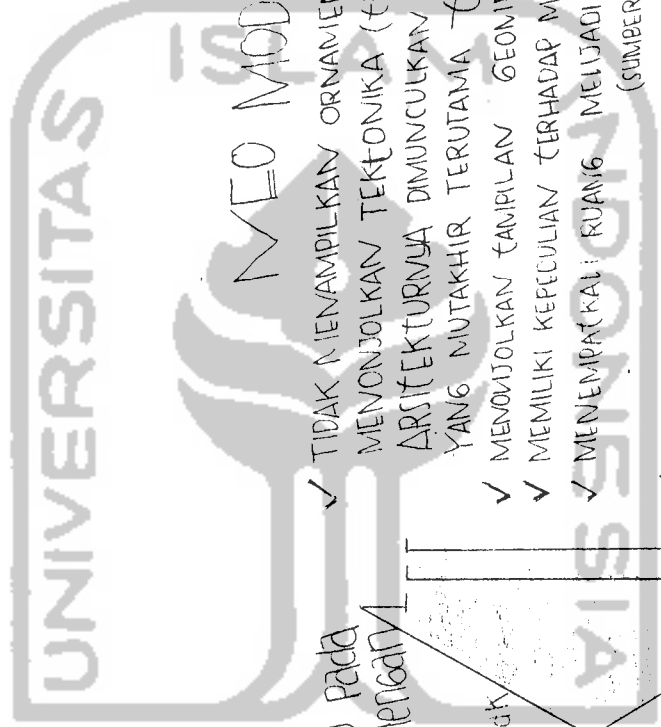

NEO MODERN

- ✓ TIDAK MENAMPILKAN ORNAMEN DAN DEKORASI LAMA, TETAPI MENONJOLKAN TEKNIKA (THE ART OF CONSTRUCTION) ARSITEKTURNYA DIMUNCULKAN DENGAN NEMAMERKAN KECANGGIHAN YANG MUTAKHIR TERUTAMA TEKNOLOGI
- ✓ MENONJOLKAN TAMPILAN GEOMETRI DAN CENDERUNG MINIMALIS
- ✓ MEMILIKI KECECULAN TERHADAP MASA KINI (THE PRESENT)
- ✓ MENEMPATKAN RUANG MELAJADI UJUR YANG DOMINAN (SUMBER: www.geocities.com/artfreoks/2150/5050a.html)
- ✓ GERAKAN NEO MODERN MEMPERHATIKAN SIRKULASI YANG MENJADI SOLUSI TAMPILAN PADA PEMBANGUNAN BANGUNAN NEO MODERN
- ✓ ARSITEKTUR NEO MODERN MENGUSAHAKAN UNTUK MEMEBAT SOLUSI TAMPILAN YANG DITEMUKAN MELALU PAHAM MODERN, NAMUN LEBIH KEPADA PENEMPATAN APLIKASI TEKNOLOGI YANG CANGGHIH UNTUK MENDUKUNG TAMPILAN YANG ESTETIK
- ✓ MENUNJUKAN INTEGRITAS SOSIAL YANG MERUPAKAN HAL DALAM BANGUNANYA (BANGUNAN BERSIFAT OPEN PLANNED)
- ✓ MENGANUT GAYA ABSTRAK ABADI

(sumber: www.geocities.com/505-0530-2/5050a.html / ketompok 12/ BAB 3 .htm)

(sumber: www.geocities.com/505-0530-2/5050a.html / ketompok 12/ BAB 3 .htm)

ACUAN DESAIN



1987
The Eye Center Oregon Health Sciences University
Portland, Oregon



1986-95
City Hall and Central Library
The Hague, The Netherlands

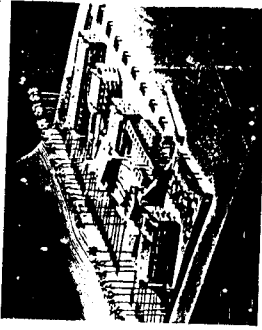

1987
Santa Monica Beach Hotel
Santa Monica, California



1987-92
Royal Dutch Paper Mills Headquarters
Hilversum, The Netherlands

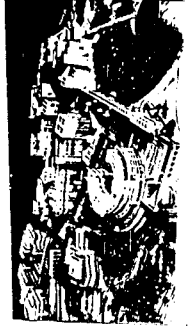

1985-97
The Getty Center
Los Angeles, California

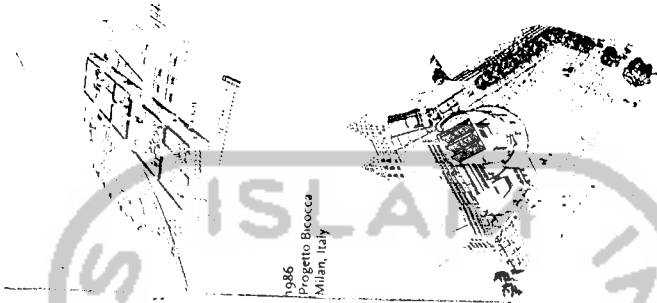

1986
Progetto Bioccca
Milan, Italy

1986-93
Exhibition and Assembly Building
Jhm, Germany



1986
Rachevsky House I
Dallas, Texas

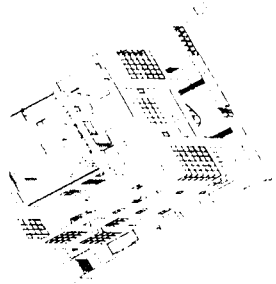

1980
Condominiums
Beverly Hills, California



1980-83
High Museum of Art
Atlanta, Georgia



1978-82
Clifty Creek Elementary School
Columbus, Indiana

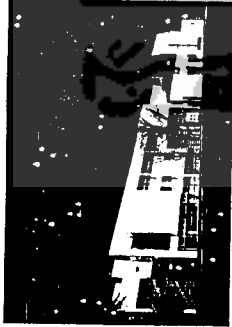

1978-81
The Hartford Seminary
Hartford, Connecticut

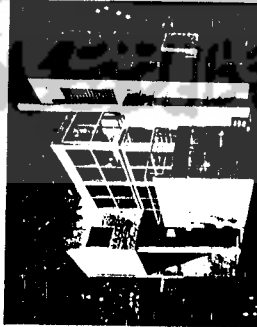

1979-81
Giovanni House
Pittsburgh, Pennsylvania

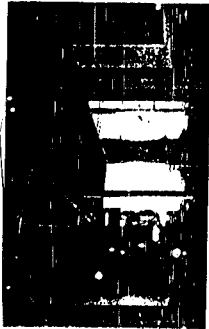

1977
New York School Exhibition Structure
State Museum Albany Mall, New York

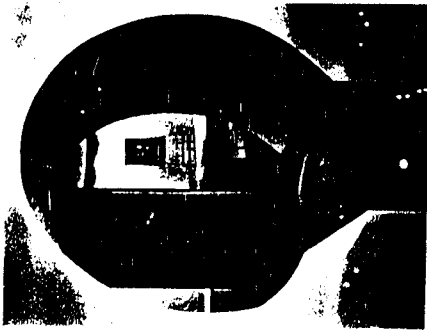

1977-78
Aye Simon Reading Room, Solomon R. Guggenheim
Museum, New York, New York



■ TAMPILAN DOMINAN BENTUK GEOMETRI
 ■ TIDAK MEMONJOLKAN WARNA DAN TEKSTUR
 ■ TIDAK MEMAMPILKAN ORNAMEN
 ■ MEMEMPATKAN RUANG SBRG UNSUR YG DOMINAN
 SANGGAR DANSA DI YOGYAKARTA

RICHARD MEIER

SANGGAR 2 DAMSA DI YOGYAKARTA

UDJEN I E...

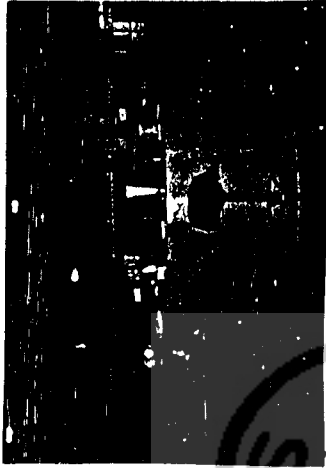

COOKIES

RECEPTIONIST
MENJADI SATU DGN RUANG
TUNGGU DAN MINI BAR
↓
KURANG NYAMAN,
TIDAK ADA PRIVACY

MINI BAR
DILENGKAPI
MEJA DAN KURSI
UNTUK MEMUJANG KEBUTUHAN PEMAKAI

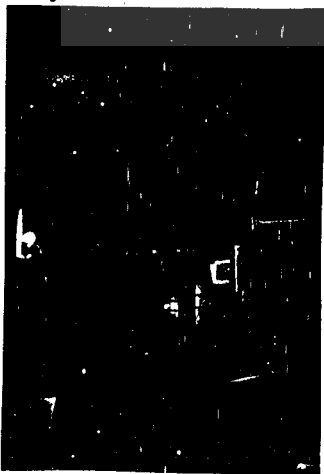

COOKIES

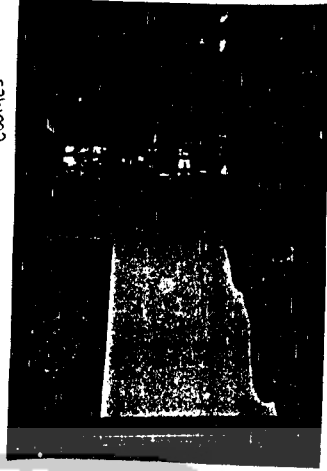

COOKIES

MEMERLUHKAN
LOCER
SBG TEMPAT MENYIMPAN
TAS, BAJU, SANDAL / SEPATU
SELAMA MELAKUKAN KEG. DANSA

KURANG MEMBERIKAN RASA AMAN
BAGI PEMAKAI, KRNI TIDAK ADA
RUANG KHUSUS YG SESUAI
STANDART



COOKIES

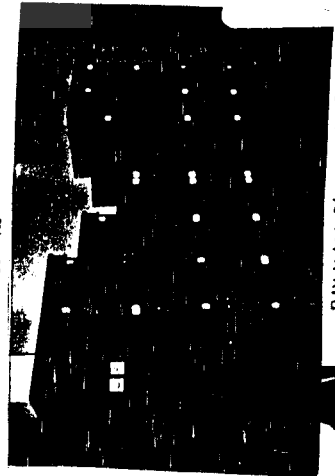

RUANG KANTOR
DILENGKAPI SOFA DAN MEJA KERJA, MTDKAM
RUANGAN INI BERKESAM FORMAL

SEBAGAI
PEMONTJOLAN
KEBERADAAN BGM

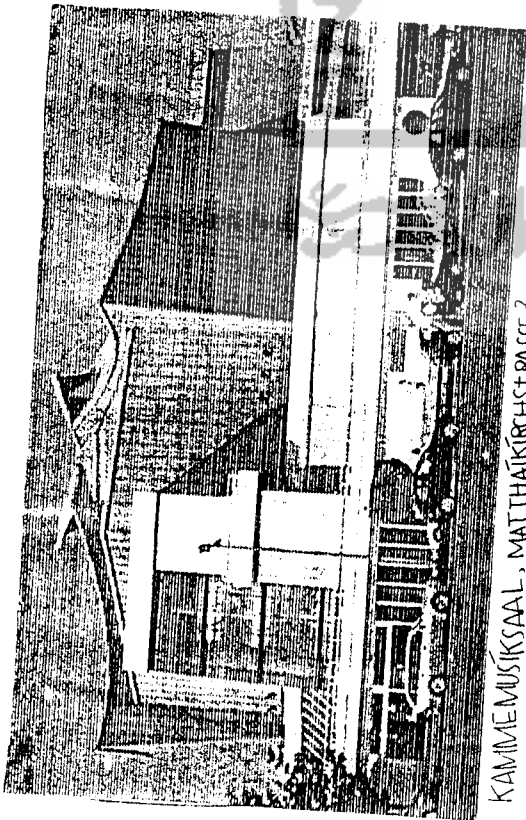

KAMME MUSIKSAL, MATTHAIKIRCHSTRASSE 3,
BERLIN-TIERGARTEN, GERMANY



BENTUK KOTAK SFG
REFLEKSI GERAKAN DANISA

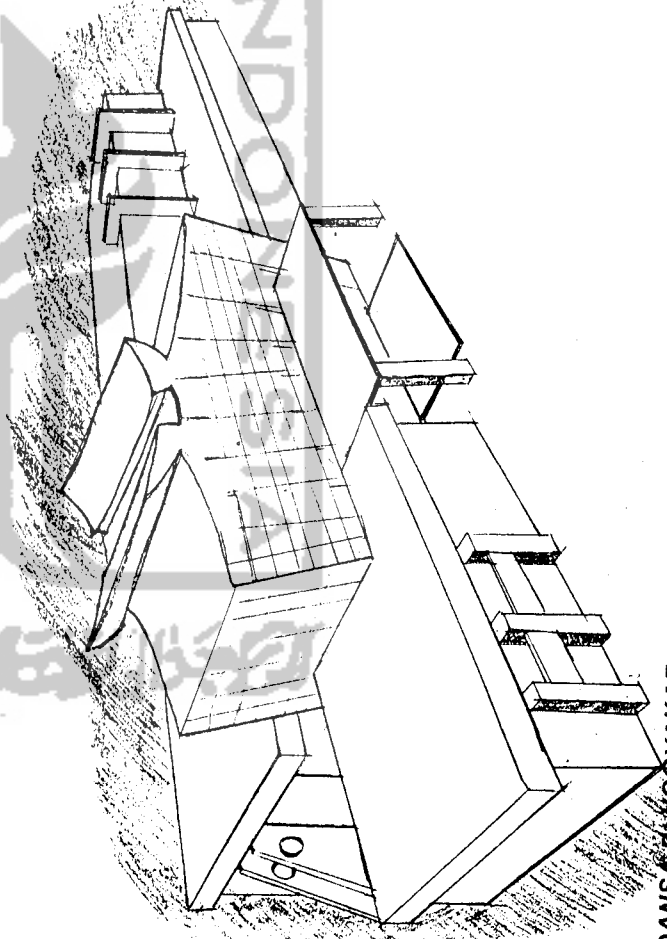
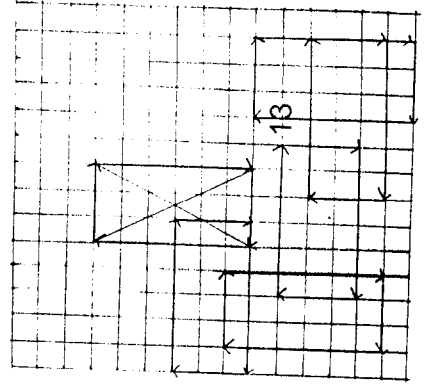

SANGGAR DANSA PUSKOP YAKARTA



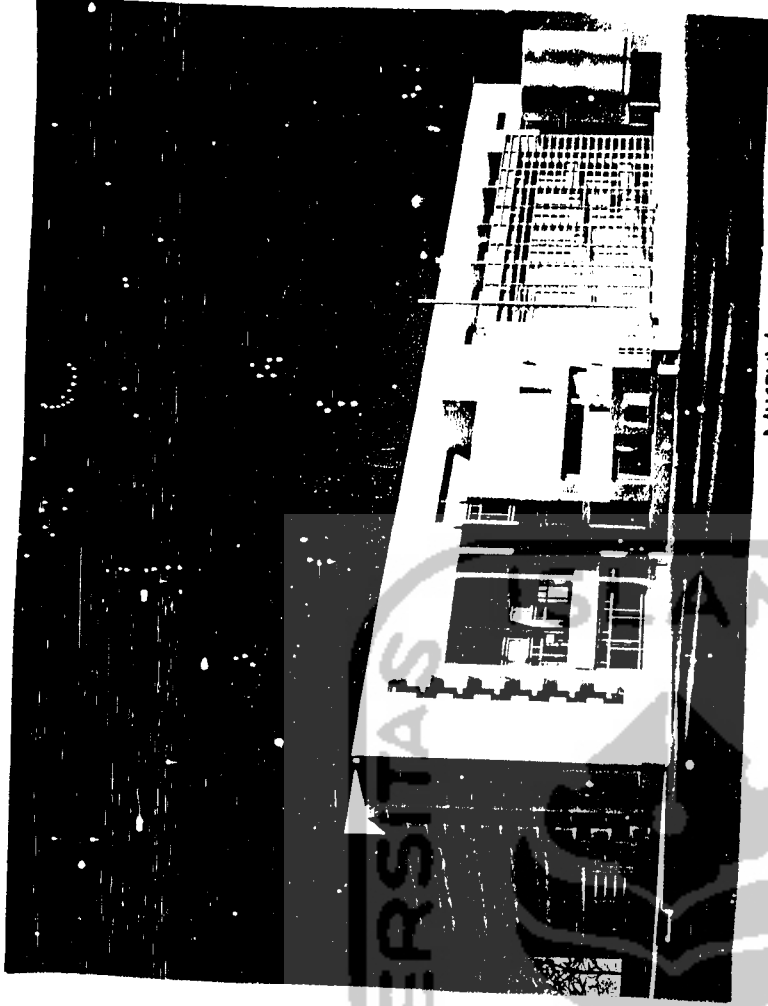

MUSEUM OF CONTEMPORARY ART
RICHARD MEIER

TIDAK MEMAMPILKAN ORNAMEN
MEMONJOLKAN CAMPILAN
GEOMETRI & CENDERUNG MINIMALIS

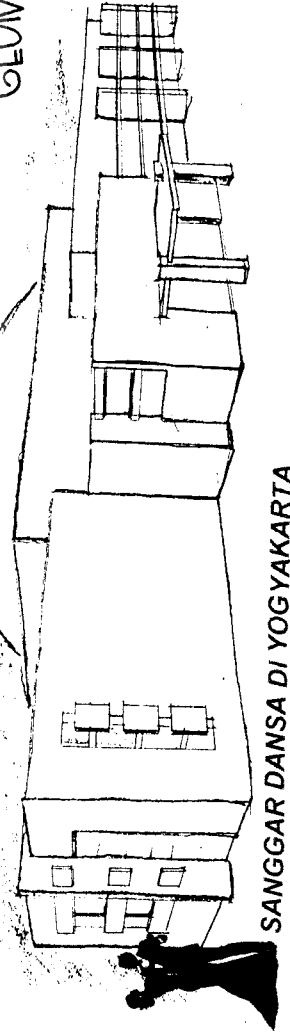

SANGGAR DANSA DI YOGYAKARTA

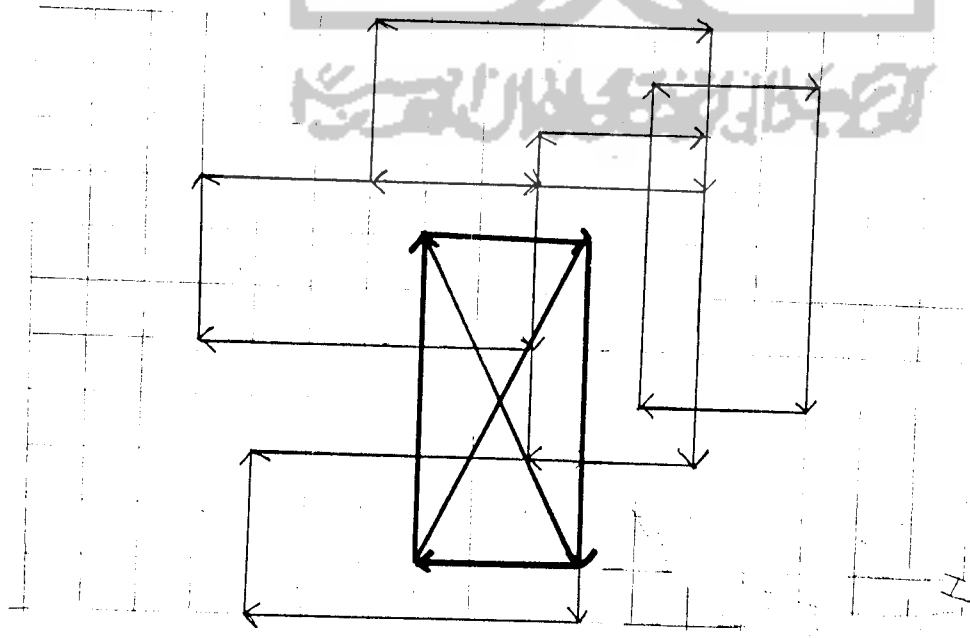
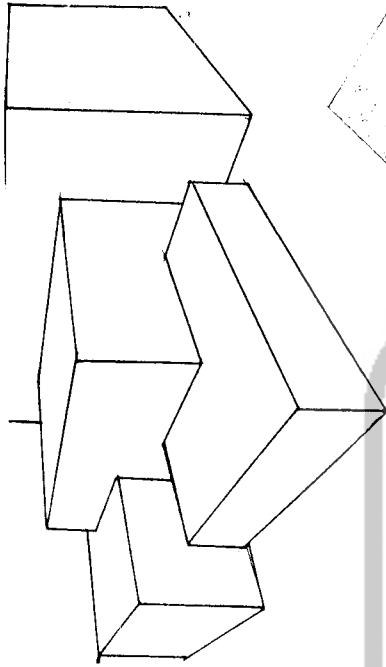

POLA DASAR GERAKAN DANCE
 MEMBENTUK PERSEGI PANJANG, BERPUTAR
 SAMA JARUM JAM.



SANGGAR DANCE DI YOGYAKARTA

MENYUSUN PERSEGI PANJANG
 DGN ORGANISASI GRID

SUATU GRID DIBENTUK DGN POLA
 TERATUR DR TITIK2 YG MEMENTUKAN
 PERTEMUAN2 DR 2 PASANG GARIS2 SEJAJAR.
 POLA TPI NOTO 1 SET YG TETAP / KAWASAN TITIK2
 ACUAN 2 GARIS2 DLM RUMAH YG MEMUNGKINKAN
 RUMAH2 SUATU ORGANISASI GRID DPT MEMILIKI HUB
 BERGAMA, WALAUPUN BEDA UKURAN, BENTUK 2 FUNGSI
 [PK. CHIMING]

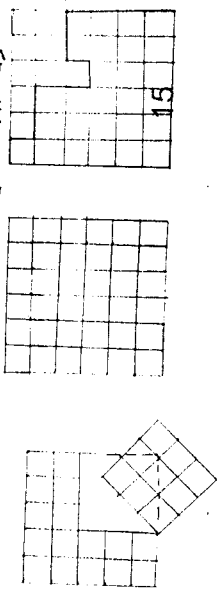

ALTERNATIF BENTUK

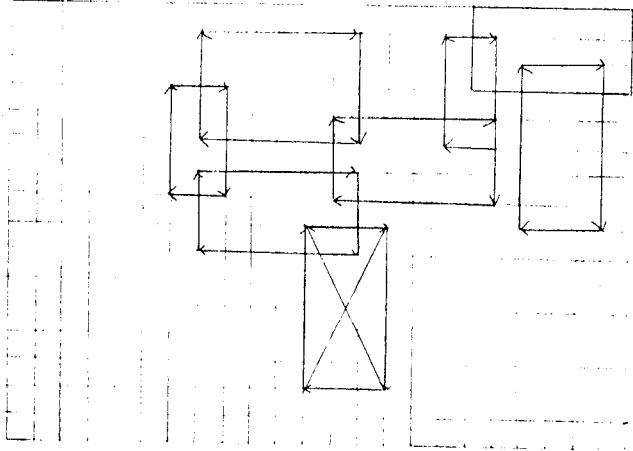

GERAKAN DASAR JAWA

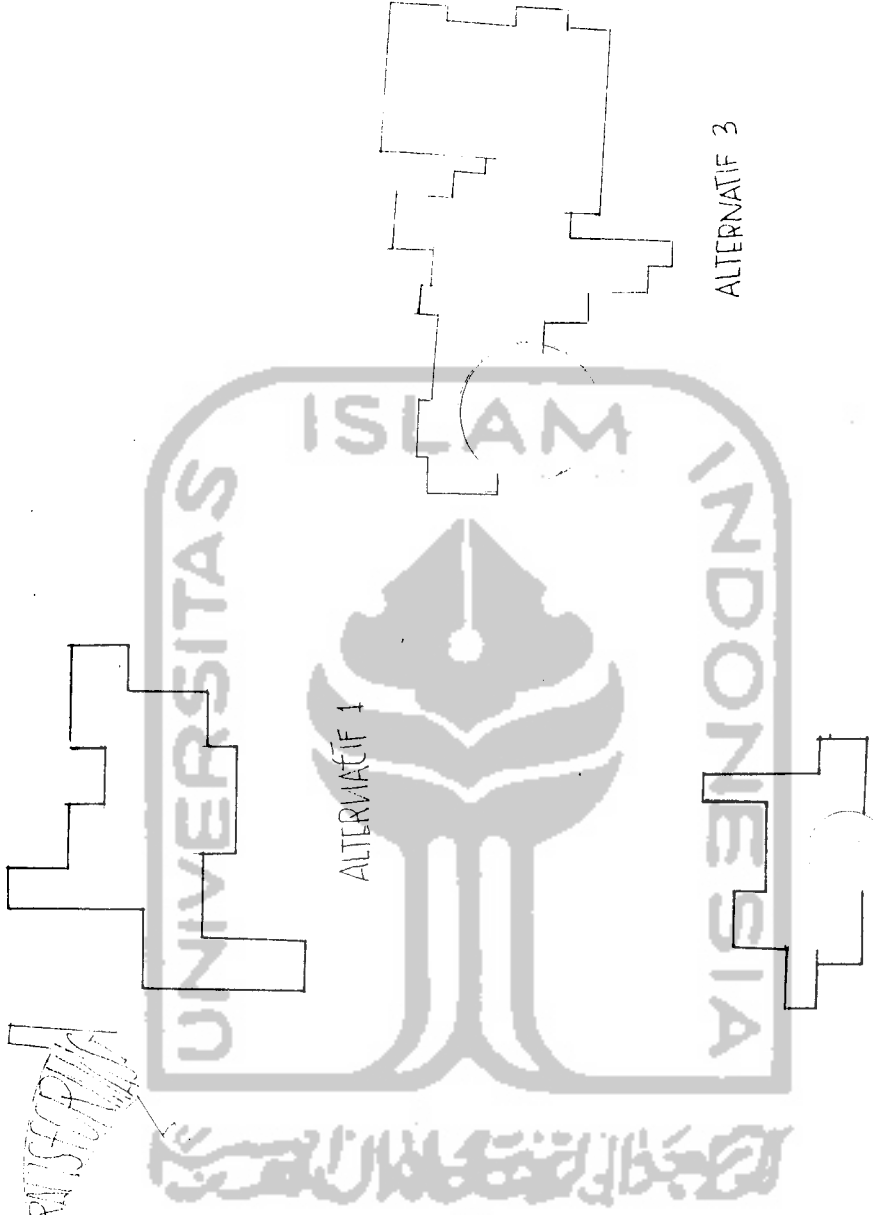

ALTERNATIF
BENTUK 1

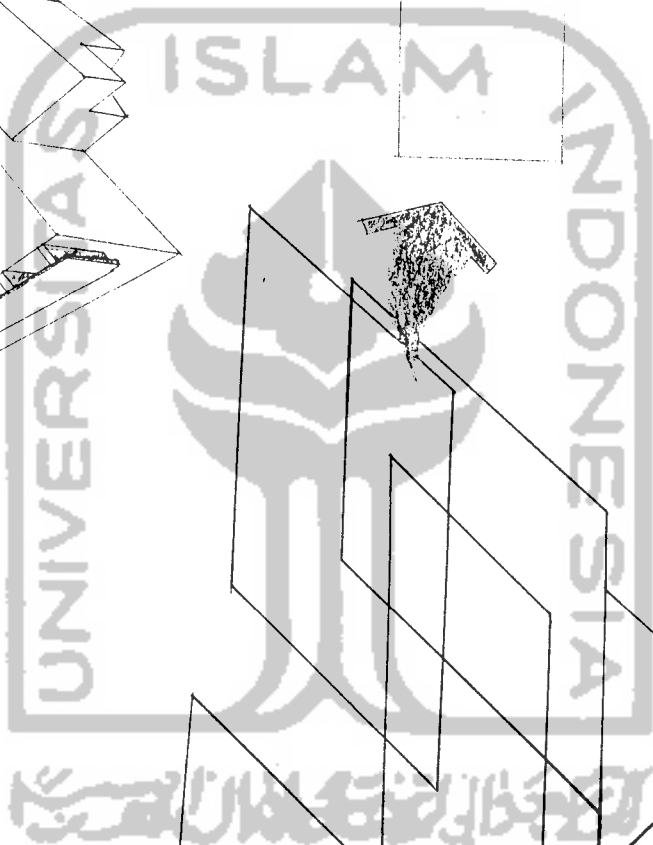
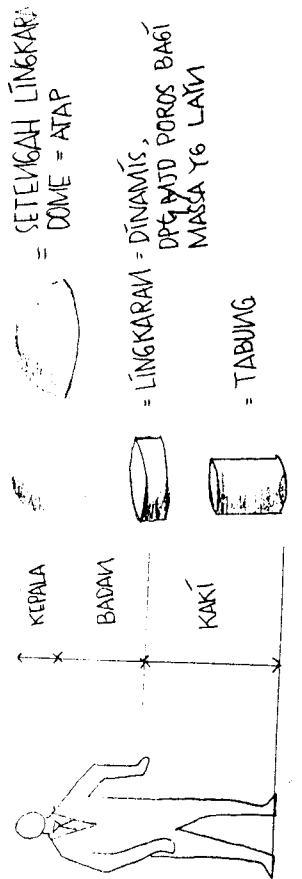
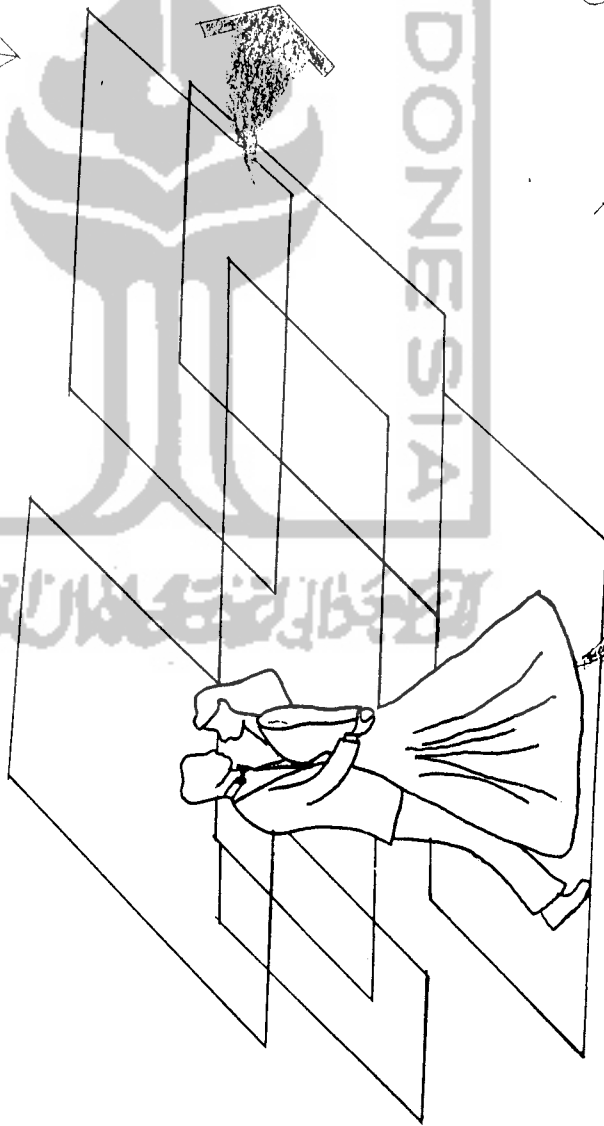
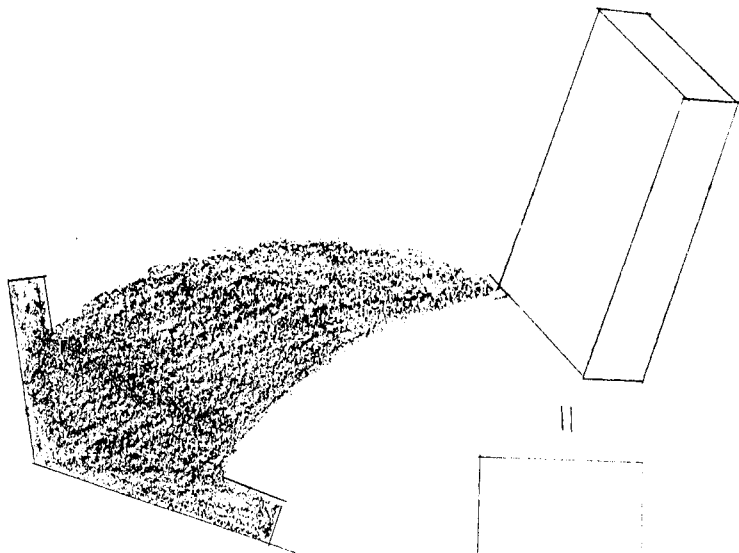
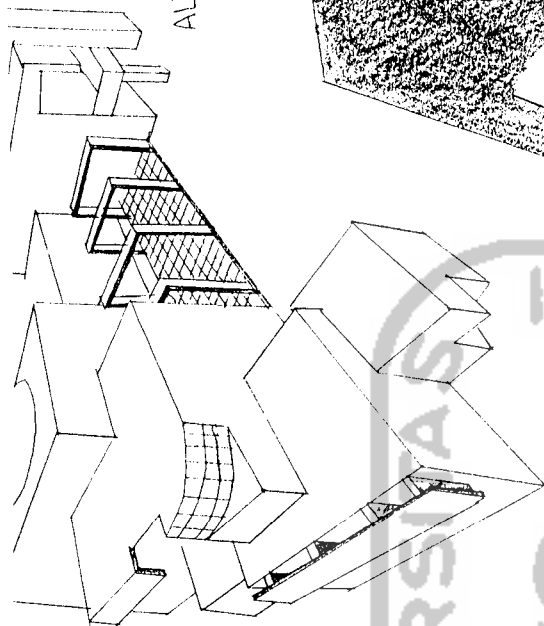

SANGGAR DANCE DI YOGYAKARTA

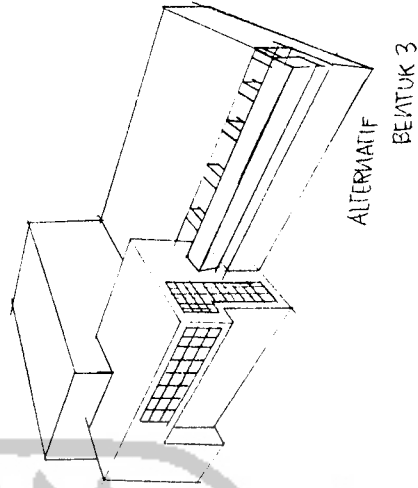
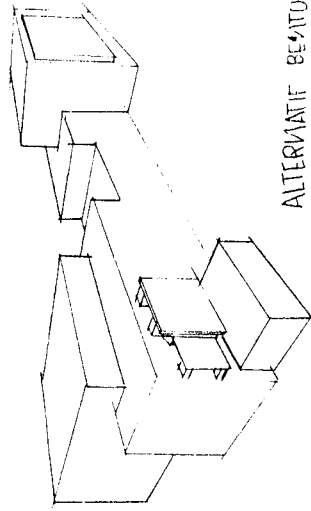
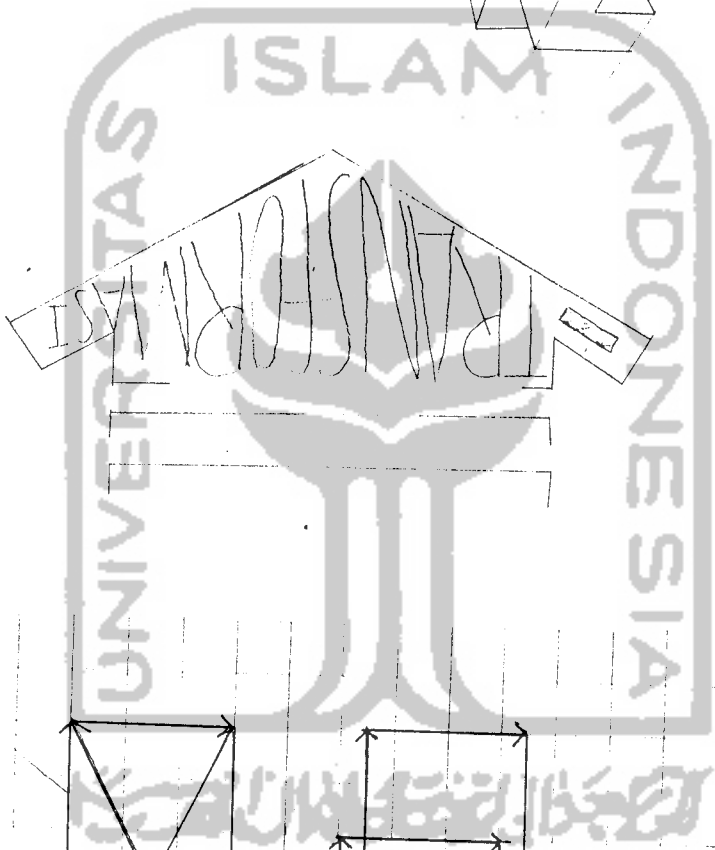
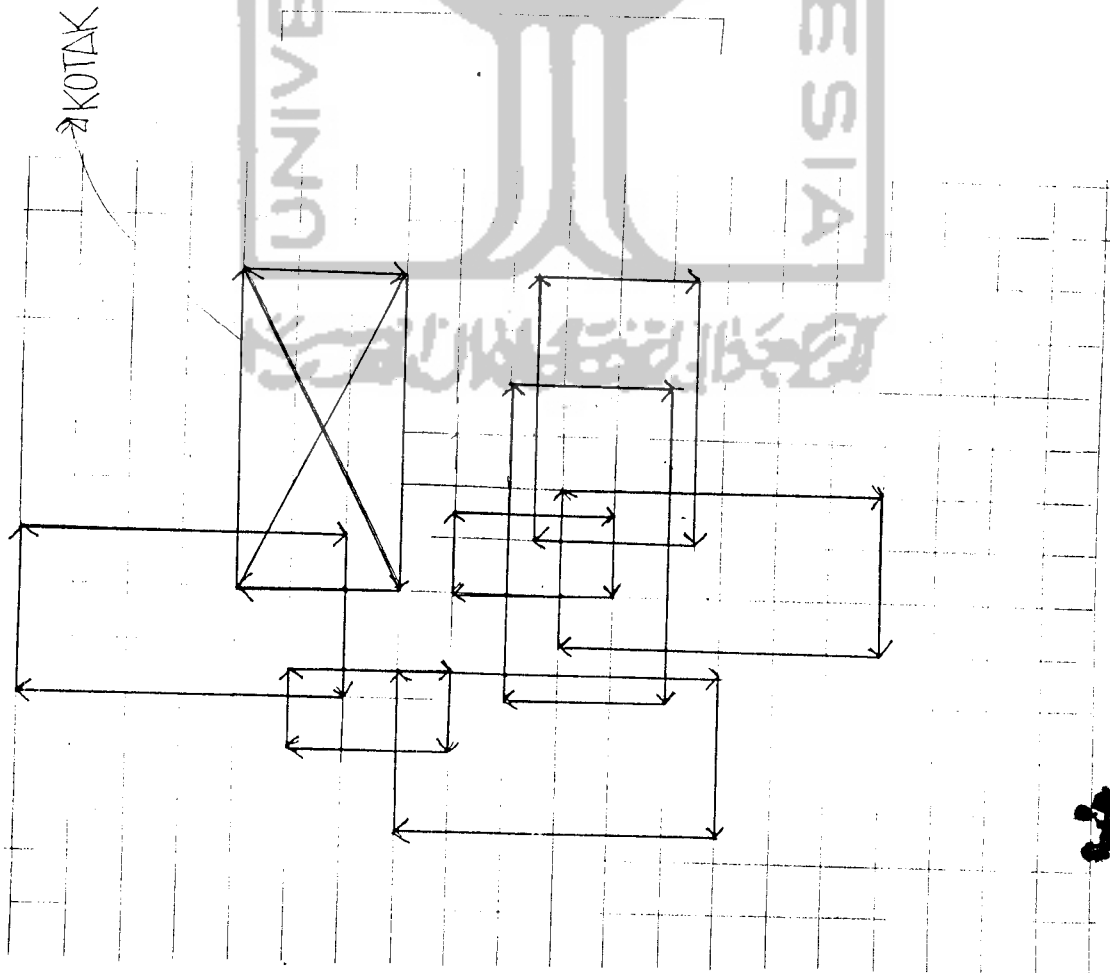

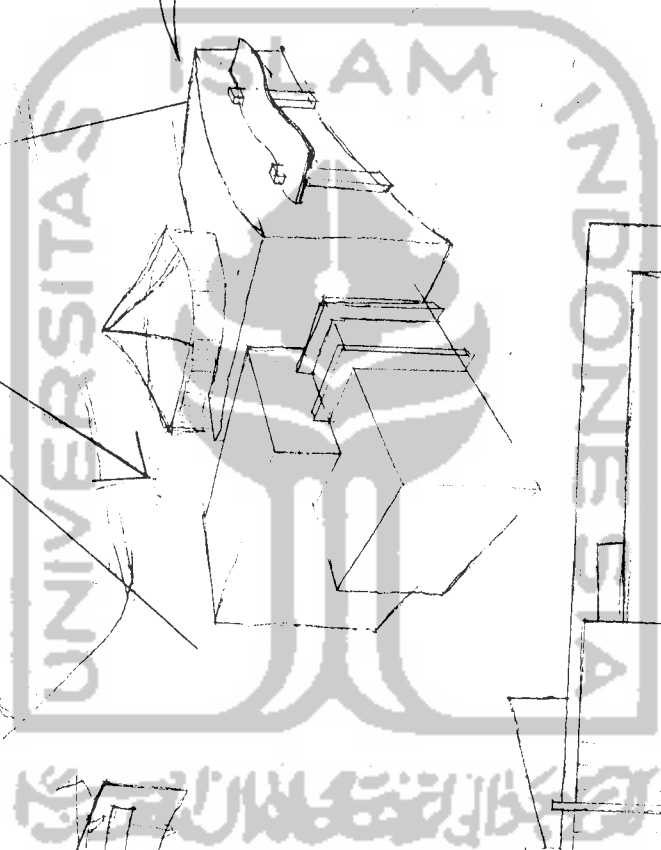
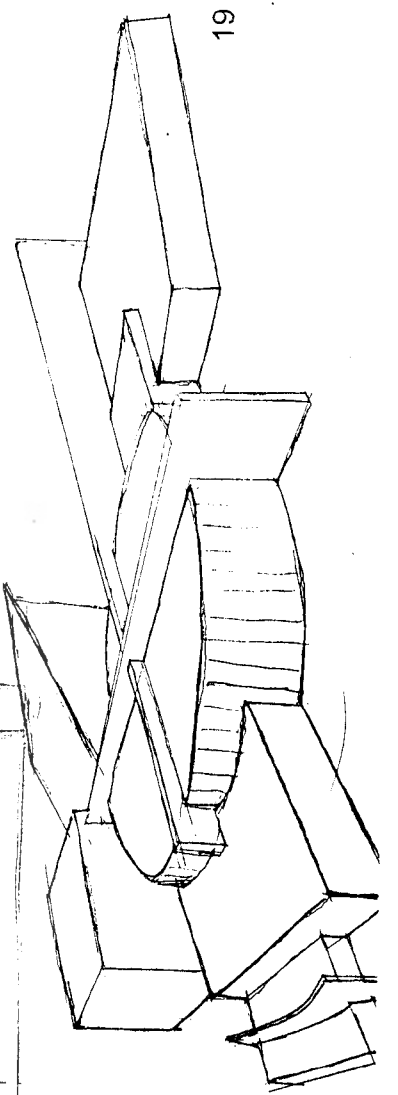
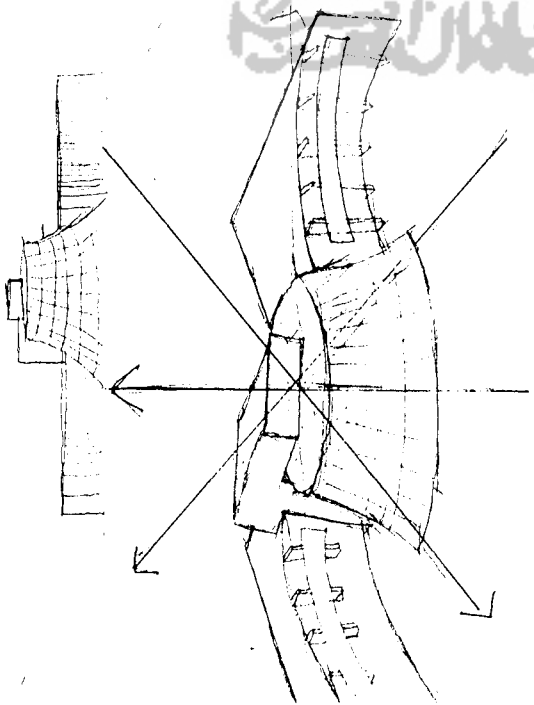
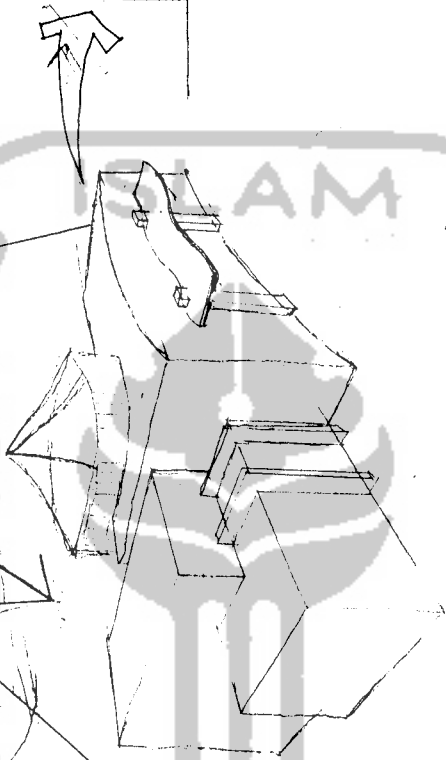
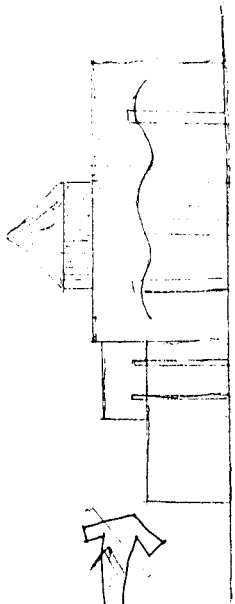
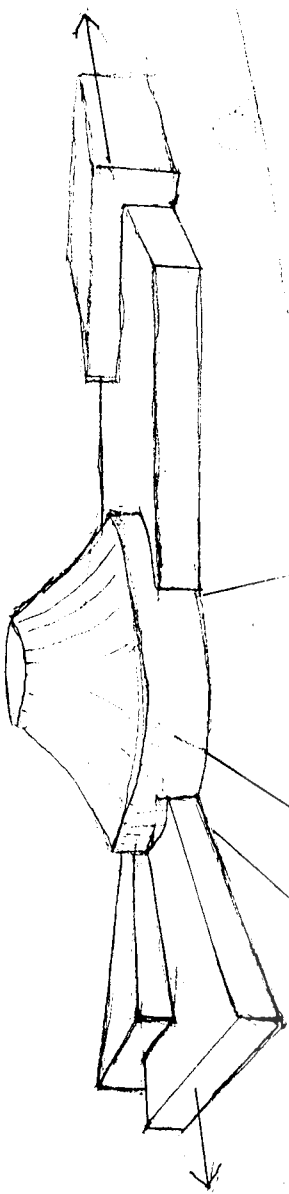

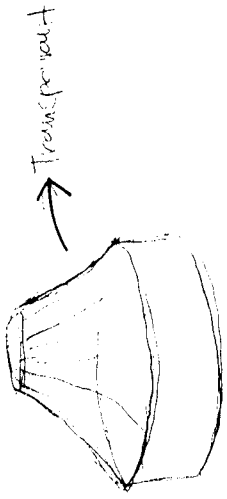

Transparansi

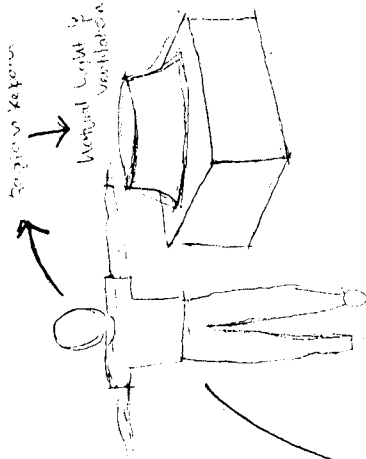

Region Kerman

Natural Light & Ventilation

Berhutan
Lingkungan

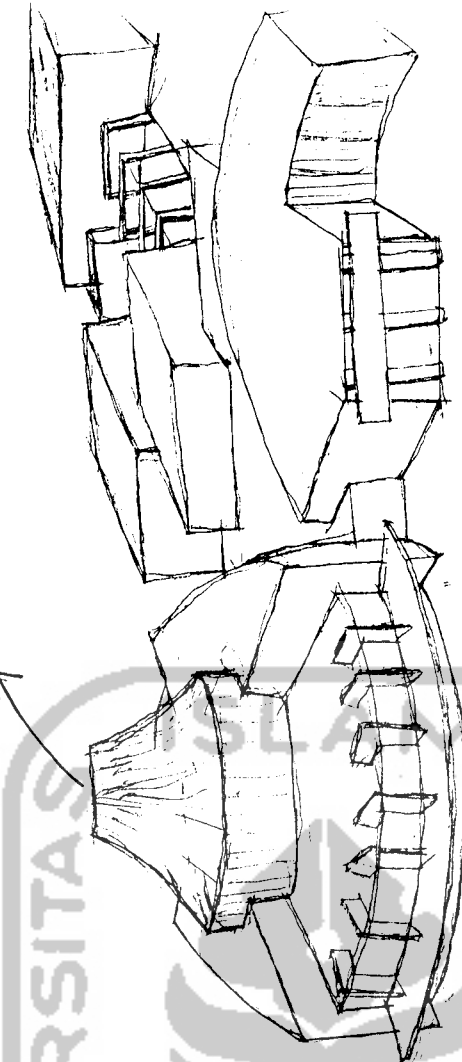

Transparansi

Entrance

Transparansi
Perforasi

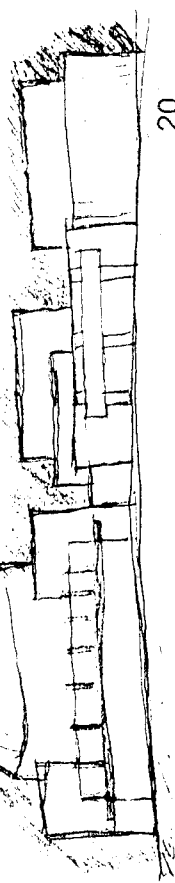

Pemecahan dinding
untuk memberikan
nilai estetik &
kondusifitas ruang.

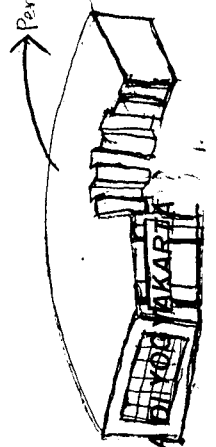

SANGGAR DANCE
KARPA

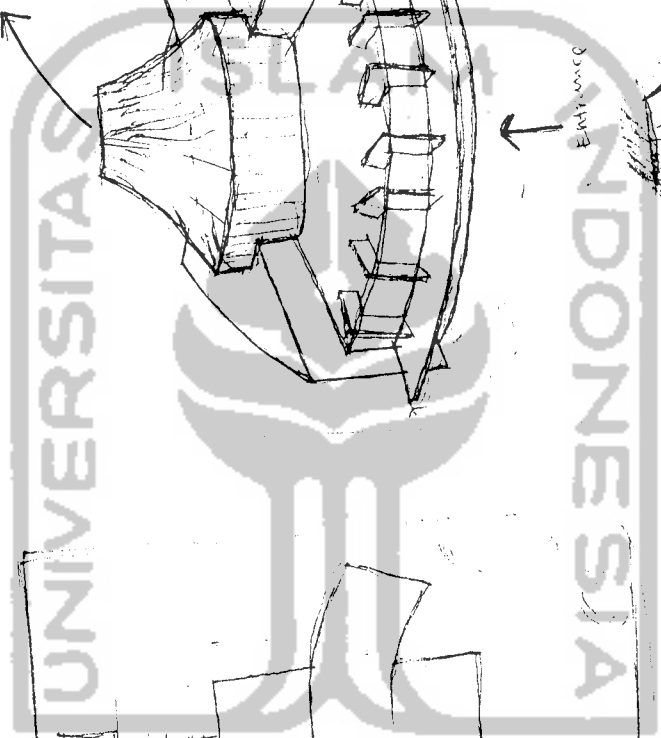

CURRICULUM OF DANCE SCHOOL

SAGE HILL SCHOOL

ARTS (REQUIRED : 2 YEARS)

NO.	OBJECT	INFORMATION
FULL YEAR COURSES :		
1.	INTRODUCTION MUSIC (NON PERFORMING CLASS)	
2.	FRESHMAN CHOIR	
3.	WOMEN'S ENSEMBLE	
4.	CONCERT CHOIR	
5.	CHAMBER SINGERS	BY AUDITION ONLY, MEETS AFTER SCHOOL 3 DAYS A WEEK, MUST ALSO BE ENROLLED IN CONCERT CHOIR
6.	JAZZ BAND ENSEMBLE	
7.	STRING ENSEMBLE	BY AUDITION ONLY
8.	FUNDAMENTALS OF ART I	
9.	FUNDAMENTALS OF ART II	
10.	FUNDAMENTALS OF ART III	BY INVITATION ONLY, AP PORTFOLIO PREPARATION
11.	AP STUDIO ART	
12.	DIGITAL ART I	ART I PREREQUISITE
13.	DIGITAL ART II	DIGITAL ART I PREREQUISITE OR TEACHER RECOMMENDATION
14.	DIGITAL ART III	
15.	DANCE I	
16.	DANCE II	
17.	DANCE III	
18.	DANCE ENSEMBLE	BY ADDITIONAL ONLY, MEETS 3-5 DAYS PER WEEK AFTER SCHOOL FROM 3-5 P.M. WITH ADDITIONAL REHEARSAL TIME REQUIRED AS NEEDED BEFORE PERFORMANCE DATES
19.	THEATRE I	
20.	THEATRE II	
21.	THEATRE III	MUSICAL THEATRE, NO PREREQUISITE BUT RECOMMENDED THAT STUDENT SINGS
22.	THE ENSEMBLE SANGGAR-DANSA DI YOGYAKARTA	BY INVITATION ONLY, DURING SCHOOL DAY

ENGLISH (REQUIRED : 4 YEARS)

NO.	OBJECT	INFORMATION
FULL YEAR COURSES :		
1.	ENGLISH I	INTRODUCTION TO LITERARY GENRES
2.	ENGLISH II	WORLD LITERATURE
3.	ENGLISH III	AMERICAN LITERATURE
4.	ENGLISH IV	AP ENGLISH OR SENIOR ENGLISH

ELECTIVE MAY INCLUDE : UNDERSTANDING STORY AND THE HUMAN EXPERIENCE, DON QUIXOTE AND THE RENAISSANCE. TRAVEL LITERATURE AND LITERATURE OF THE SEA, PLAYWRITING AND ADAPTATION. + ADVANCED COMPOSITION AND CREATIVE WRITING. THE INDIVIDUAL IN SOCIETY AND LITERATURE OF THE GOLDEN STATE

HISTORY (REQUIRED : 3 YEARS)

NO.	OBJECT	INFORMATION
FULL YEAR COURSES :		
1.	ANCIENT WORLD HISTORY	
2.	AP UNITED STATES HISTORY	
3.	UNITED STATES HISTORY	
4.	AP AMERICAN GOV.	
5.	WORLD SINCE 1945 + ART HISTORY	
6.	AP EUROPEAN HISTORY	
7.	EUROPEAN HISTORY + PSYCHOLOGY	
8.	AFRICAN HISTORY + ECONOMICS	

PHYSICAL EDUCATION (REQUIRED 3 YEARS : 9TH AND 10TH GRADES REQUIRED)

NO.	OBJECT	INFORMATION
INTERSCHOLASTIC ATHLETIC PARTICIPATION		
1.	DANCE I	
2.	DANCE II	
3.	DANCE III	
4.	DANCE ENSEMBLE	
5.	PHYSICAL EDUCATION	

MATHEMATICS (REQUIRED : THROUGH JUNIOR YEAR AND ALGEBRA II)

NO.	OBJECT	INFORMATION
FULL YEAR COURSES		
1.	ALGEBRA I	
2.	GEOMETRY	

COMPUTER SCIENCE*

ELECTIVES :

INTRODUCTION TO PROGRAMMING

AP JAVA.A

*ELECTIVES ARE INTENDED FOR STUDENTS WHO HAVE SATISFIED GRADUATION REQUIREMENTS IN ONE OR MORE SUBJECTS.

NEWLY ADDED COURSES, YET UNAPPROVED BY THE UNIVERSITY OF CALIFORNIA

+ APPROVED AS AN ELECTIVE (" G ") BY THE UC

3.	ACCELERATED GEOMETRY
4.	ALGEBRA II
5.	ACCELERATED ALGEBRA II
6.	PRECALCULUS
7.	ACCELERATED PRECALCULUS
8.	STATISTIC
9.	DISCRETE MATH & PROBLEM SOLVING
10.	CALCULUS
11.	AP CALCULUS AB
12.	MULTIVARIABLE CALCULUS
13.	AP STATISTIC

SCIENCE (REQUIRED : 3 YEARS LABORATORY SCIENCE)

No.	OBJECT	INFORMATION
	FULL YEAR COURSES :	
	# CONCEPTUAL PHYSICS	
1.	BIOLOGY	
2.	CHEMISTRY	
3.	PHYSICS	
4.	PHYSICAL SCIENCE	
5.	AP ENVIRONMENTAL SCIENCE	
	# MARINE SCIENCE	
1.	AP BIOLOGY	
2.	AP CHEMISTRY	
3.	AP PHYSICS B	
4.	AP PHYSICS C	

WORLD LANGUAGES (REQUIRED : THROUGH JUNIOR YEAR & LEVEL III)

No.	OBJECT	INFORMATION
	FULL YEAR COURSES	
1.	CHINESE I - IV	
2.	FRENCH I - IV	
3.	AP FRENCH LANGUAGE	
4.	AP FRENCH LITERATURE	
5.	LATIN I - AP. LATIN	
6.	SPANISH LANGUAGE	
7.	SPANISH LITERATURE	

SANGGAR DANSA DI YOGYAKARTA

WUKRIWULUMI UT WAIN WUMAIN DAINSA

STUDIO	WAKTU	SENIN	SELASA	RABU	KAMIS	JUM'AT	SABTU
1	09.00 - 11.00	CHA CHA I	RUMBA I	CHA CHA I	RUMBA I	CHA CHA I	RUMBA I
	12.30 - 14.30	TANGO I	PASO DOBLE I	TANGO I	PASO DOBLE I	TANGO I	PASO DOBLE I
	15.30 - 17.30	WALTZ I	SAMBA I	WALTZ I	SAMBA I	WALTZ I	SAMBA I
	18.00 - 20.00	VINNESE W I	QUICKSTEP I	VINNESE W I	QUICKSTEP I	VINNESE W I	QUICKSTEP I
2	09.00 - 11.00	CHA CHA II	RUMBA II	CHA CHA II	RUMBA II	CHA CHA II	RUMBA II
	12.30 - 14.30	TANGO II	PASO DOBLE II	TANGO II	PASO DOBLE II	TANGO II	PASO DOBLE II
	15.30 - 17.30	WALTZ II	SAMBA II	WALTZ II	SAMBA II	WALTZ II	SAMBA II
	18.00 - 20.00	VINNESE W II	QUICKSTEP II	VINNESE W II	QUICKSTEP II	VINNESE W II	QUICKSTEP II
3	09.00 - 11.00	CHA CHA III	RUMBA III	CHA CHA III	RUMBA III	CHA CHA III	RUMBA III
	12.30 - 14.30	TANGO III	PASO DOBLE III	TANGO III	PASO DOBLE III	TANGO III	PASO DOBLE III
	15.30 - 17.30	WALTZ III	SAMBA III	WALTZ III	SAMBA III	WALTZ III	SAMBA III
	18.00 - 20.00	VINNESE W III	QUICKSTEP III	VINNESE W III	QUICKSTEP III	VINNESE W III	QUICKSTEP III
4	09.00 - 11.00	CHA CHA IV	RUMBA IV	CHA CHA IV	RUMBA IV	CHA CHA IV	RUMBA IV
	12.30 - 14.30	TANGO IV	PASO DOBLE IV	TANGO IV	PASO DOBLE IV	TANGO IV	PASO DOBLE IV
	15.30 - 17.30	WALTZ IV	SAMBA IV	WALTZ IV	SAMBA IV	WALTZ IV	SAMBA IV
	18.00 - 20.00	VINNESE W IV	QUICKSTEP IV	VINNESE W IV	QUICKSTEP IV	VINNESE W IV	QUICKSTEP IV
5	09.00 - 11.00	JIVE I	JIVE III	JIVE I	JIVE III	JIVE I	JIVE III
	12.30 - 14.30	SALSA I	SALSA III	SALSA I	SALSA III	SALSA I	SALSA III
	15.30 - 17.30	JIVE II	JIVE IV	JIVE II	JIVE IV	JIVE II	JIVE IV
	18.00 - 20.00	SALSA II	SALSA IV	SALSA II	SALSA IV	SALSA II	SALSA IV
6	SANGGAR DANSA DI YOGYAKARTA						
	PRIVAT	PRIVAT	PRIVAT	PRIVAT	PRIVAT	PRIVAT	PRIVAT



KELAS	WAKTU	SENIN	SELASA	RABU	KAMIS	JUM'AT	SABTU
1	09.00 - 11.00	INTRODUCTION	FUNDAMENTAL	PHYSICAL	INTRODUCTION	DIGITAL ART	FUNDAMENTAL
		MUSIC	OF ART	EDUCATION	MUSIC		OF ART
	12.30 - 14.30	INTRODUCTION	FUNDAMENTAL	PHYSICAL	INTRODUCTION	DIGITAL ART	FUNDAMENTAL
		MUSIC	OF ART	EDUCATION	MUSIC		OF ART
	15.30 - 17.30	INTRODUCTION	FUNDAMENTAL	DIGITAL ART	INTRODUCTION	PHYSICAL	FUNDAMENTAL
		MUSIC	OF ART		MUSIC	EDUCATION	OF ART
	18.00 - 20.00	INTRODUCTION	FUNDAMENTAL	DIGITAL ART	INTRODUCTION	PHYSICAL	FUNDAMENTAL
		MUSIC	OF ART		MUSIC	EDUCATION	OF ART

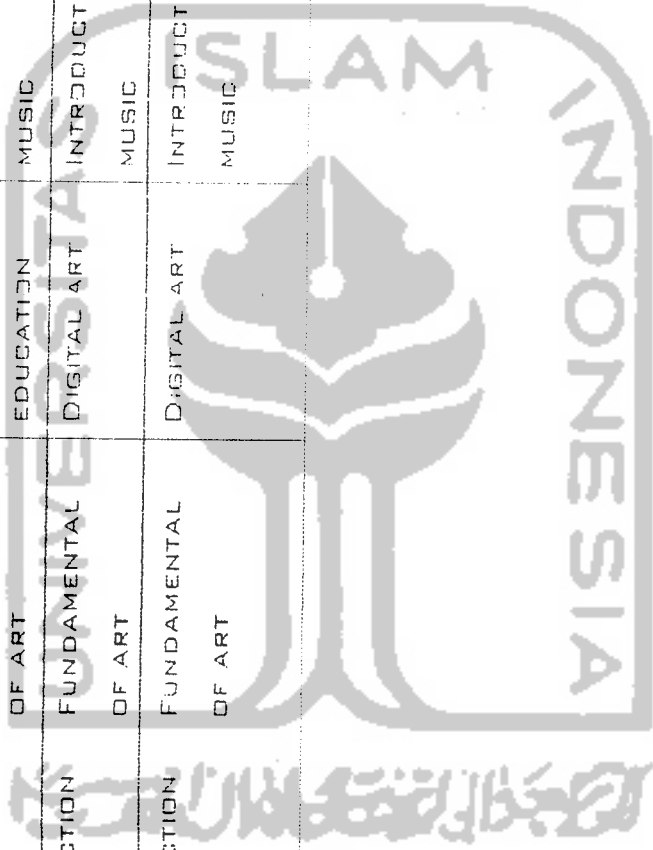

JADWAL PENGGUNAAN BALLROOM

WAKTU	SENIN	SELASA	RABU	KAMIS	JUM'AT	SABTU
09.00 - 11.00	JIVE III	VINNESE W III	SALSA III		QUICK STEP III	
12.30 - 14.30	JIVE IV	VINNESE W IV	SALSA IV		QUICK STEP IV	
15.30 - 14.30	RUMBA III	CHA - CHA III	PASO DOBLE III	TANGO III	SAMBA III	WALTZ III
18.30 - 20.00	RUMBA IV	CHA - CHA IV	PASO DOBLE IV	TANGO IV	SAMBA IV	WALTZ IV



ADMINISTRASI
 MENGELOLA SELURUH KEPERLUAN ADMINISTRASI
 BAIK SISWA, PENGAJAR MAUPUN PEGAWAI.
 BEKERJA DLM SATU RUMAH KANTOR (OFFICE)

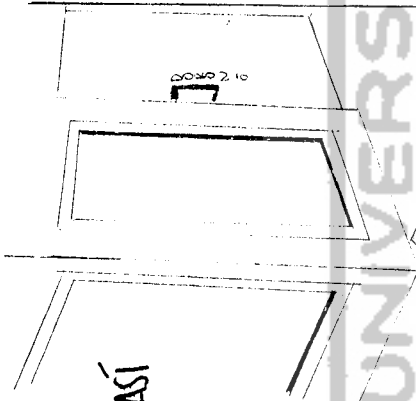
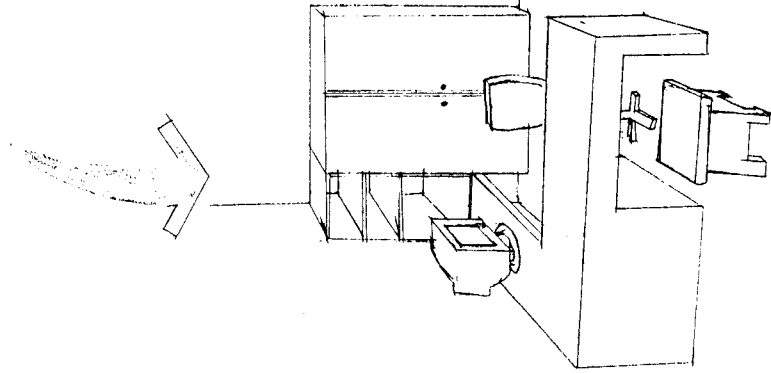

PEGAWAI

CLEANING SERVICE, FASILITAS PENDUKUNG
 DIKELOLA OLEH PEGAWAI YG MEMANG DI PEKERJAAN
 UTK MENGELOLA HAL TSB.

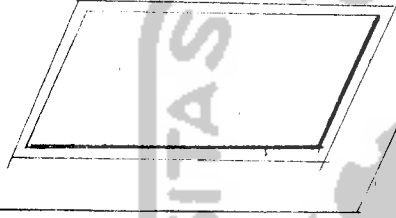

PEGAJAR
 MEMBERIKAN MATERI
 PELAJARAN KPD SISWA =

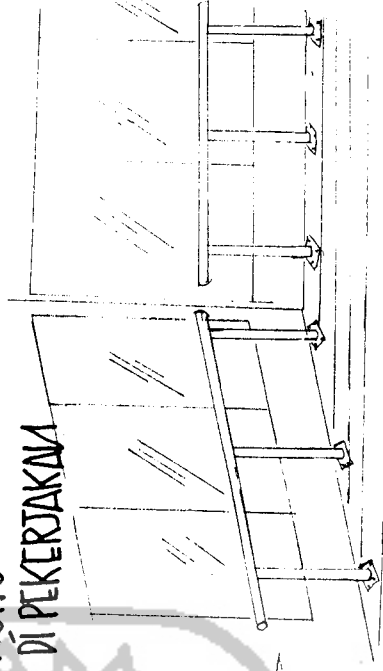

SISWA

MELAKUKAN KEGIATAN BELAJAR
 BAIK DI RUANG KELAS MAUPUN DI STUDIO



IDENTIFIKASI PELAKU

JENIS KEGIATAN	MASAM KEGIATAN	PELAKU KEGIATAN	KEBUTUHAN RUANG
OFFICE	KEG. ADMINISTRASI	PIMPINAN, SEKRETARIS, KEUANGAN, ADMINISTRASI, RECEPTIONIST	R. PIMPINAN, R. SEKRETARIS, R. KEUANGAN, R. ADMINISTRASI, R. RECEPTIONIST
SANGGAR	• KEG. PENGAJAR • KEG. SISWA	GURU DANCE, DOKTER AHLI GIZI, DOKTER AHLI TULANG SISWA	R. GURU CLASSROOM, STUDIO, DRESSING R. LIBRARY, AUDIO ROOM
ONE STOP SERVICE	JUAL-BELI	PENGELOLA, KARTAMANI	R. KRYWI, R. PENGELOLA, MIAMI MARKET, SALON, KAMITIN, DAPUR, GUDANG, LAVATORY, MUSHOLA



IDENTIFIKASI-AKTIVITAS

ADMINISTRASI

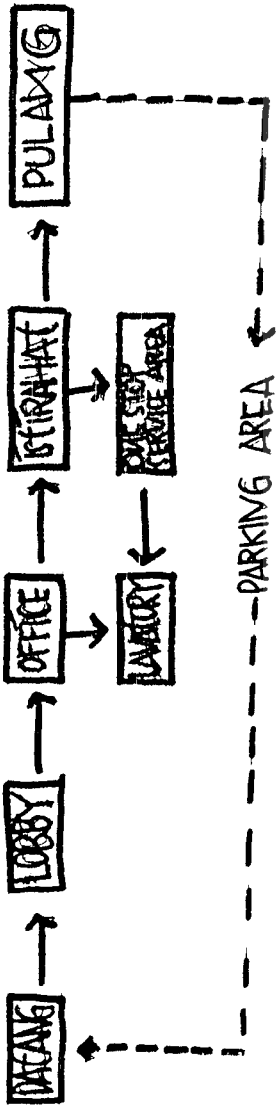

PENGAJAR

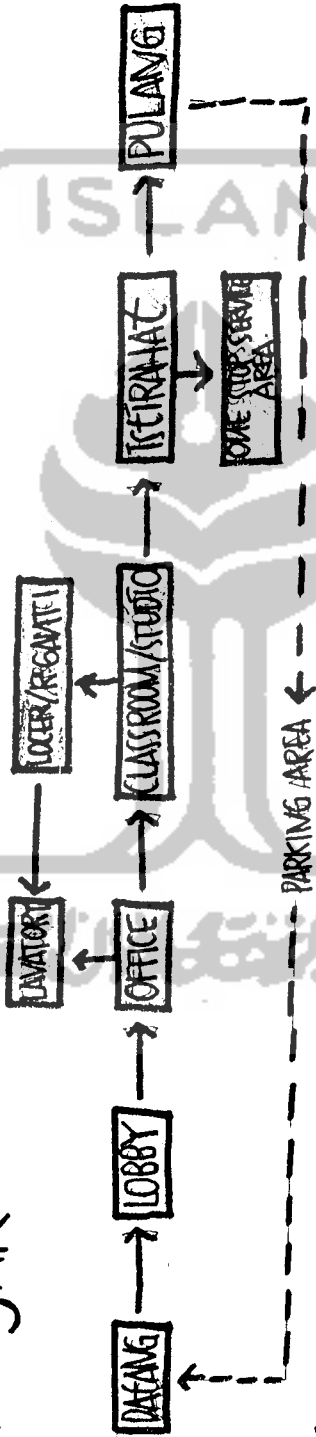

SISWA

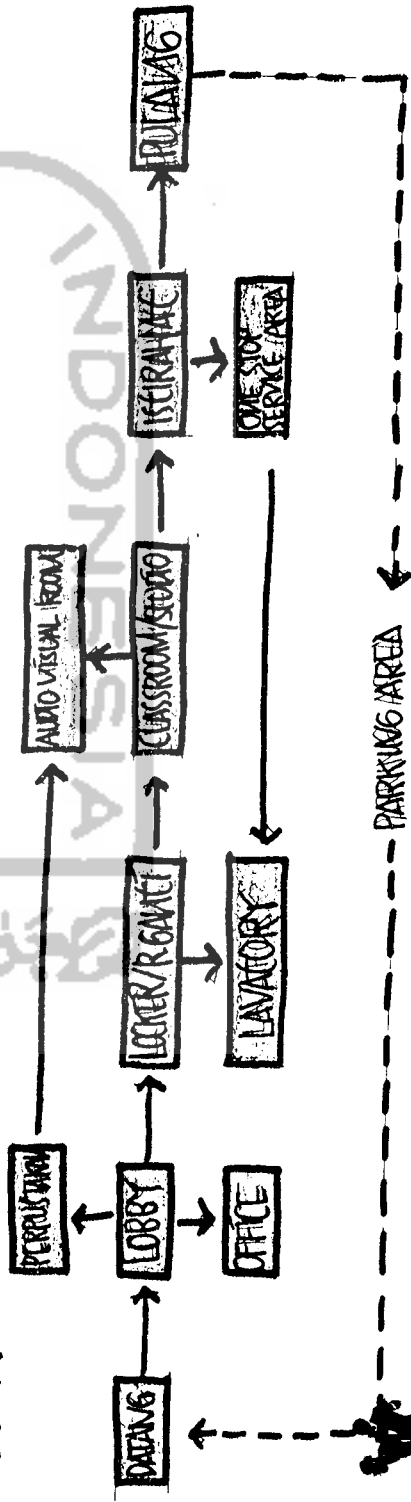

ONE STOP SERVICE

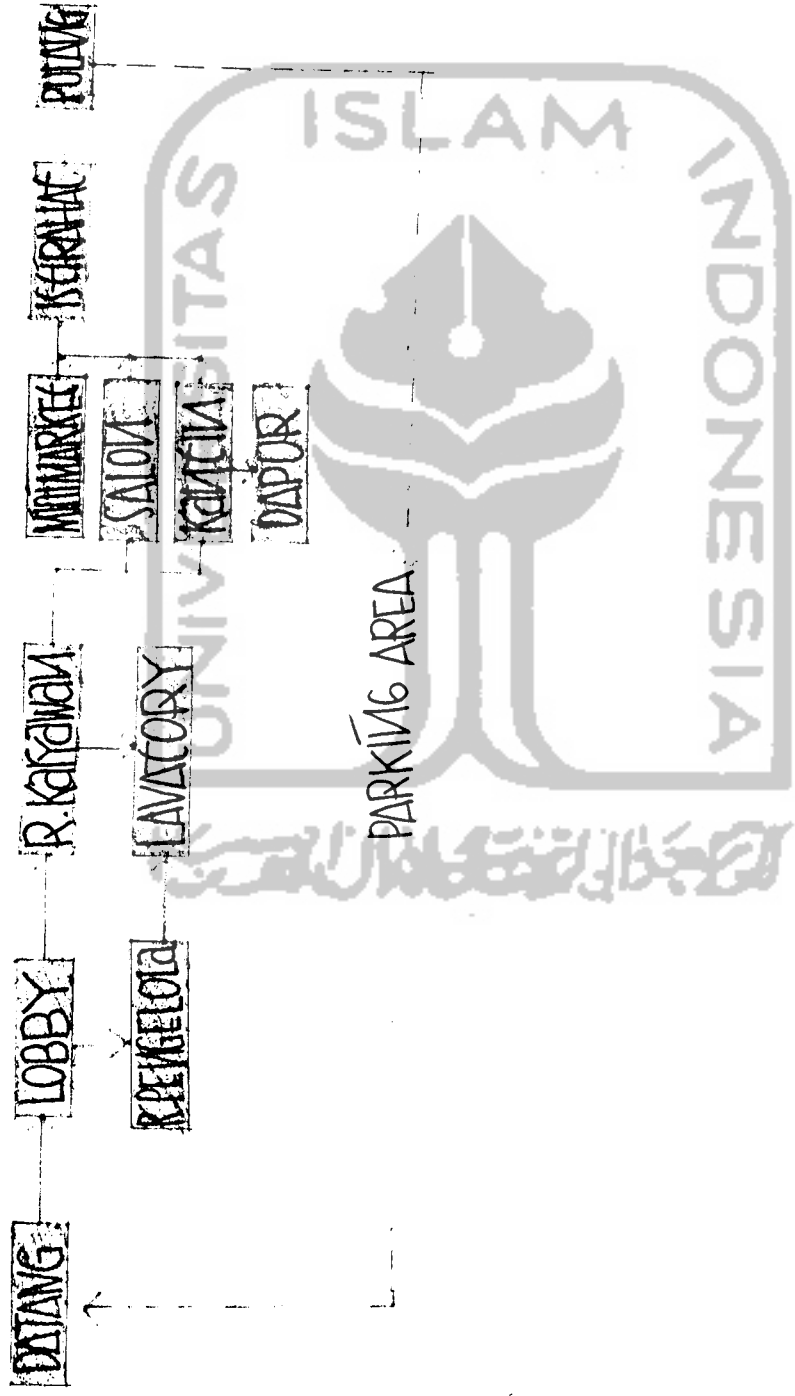

OFFICE

NO	KEBUTUHAN RUANG	JUMLAH	LUAS	LUAS TOTAL	KAPASITAS
1	OFFICE (SEKERTJAB/KEBUNGAN/ADMINISTRASI)	1	80 M ²	80 M ²	10 ORANG, 6 M ² /ORNG
2	HEAD OFFICE	1	15 M ²	15 M ²	1 ORG, 15 M ² /ORG MEMERIKAKAN KELOMPOK
3	RECEPTIONIST	1	6 M ²	6 M ²	1 ORG
4	LOBBY	1	100 M ²	100 M ²	30 ORG
TOTAL LUAS:				203 M ²	

IDENTIFIKASI RUANG

SCHOOL

NO	KEBUTUHAN RUANG	JUMLAH	LUAS	LUAS TOTAL	KAPASITAS
1	R. GURU	1	80 M ²	80 M ²	10 ORANG, 8 M ² /ORG
2	CLASSROOM	1	96 M ²	96 M ²	40 ORG → (12 x 8) m
3	STUDIO	6	80 M ²	480 M ²	10 ORG / KELAS
4	LIBRARY	1	1250 M ²	1250 M ²	50 ORG
5	AUDIO VISUAL	1	600 M ²	600 M ²	10 ORG
6	LOCKER/DRESSING ROOM	6	36 M ²	216 M ²	20 ORG / RUANG → 1,8 M ² /ORG
TOTAL LUAS:				2722 M ²	



ONE STOP SERVICE

NO	KEBUTUHAN RUANG	JUMLAH	LUAS	LUAS TOTAL	KAPASITAS
1	R TUNGGU	1	96 M ²	96 M ²	2 ORG
2	MINI MARKET	1	90 M ²	90 M ²	25 ORG (10 M x 9 M)
3	KANTIN	1	225 M ²	225 M ²	25 MEJA, 100 KURSI
4	DAPUR	1	200 M ²	200 M ²	3 ORG (8 x 25 M)
5	SALON	1	50 M ²	50 M ²	10 ORG → 4 PEGAWAI, 6 PENUNJUNG
6	R. KARYAWAN	1	40 M ²	40 M ²	15 ORG
7	GUDANG	1	40 M ²	40 M ²	3 ORG
8	MUSHOLA	1	96 M ²	96 M ²	(12 M x 8 M)
9	SECURITY	2	9 M ²	18 M ²	2 ORG
10	LAVATORY	6	50 M ²	300 M ²	10 ORG / RUANG
11	BALL ROOM	1	1150 M ²	1150 M ²	(40 M x 28 M) 100 ORG

TOTAL LUAS: 1150 M²



■ SITE DIPERLUHUKAN SESUAI BESARNYA
 LUAS LAHAN YANG DPT MEMAMPUNG
 AKTIFITAS BANGUNAN

■ DEKAT DGN PUSAT KOTA DAN MTD
 JALUR AKSES MENUJU KAWASAN
 KOMERSIAL, PEREKONOMIAN, WISATA
 PERKAWASAN DAN PENDIDIKAN
 ■ JARINGAN INFRASTRUKTUR YANG
 SUDAH TERTATA DENGAN BAIK,
 MENGOPTIMALKAN KEBERADAAN SITE



ANALISA SITE

KEBISINGAN
 KEBISINGAN TERBESAR DATANG DARI JL GOTONG-ROYONG
 KRN MERUPAKAN LAJULINTAS UTAMA TEMBUSAN
 DARI JL. AM. SANGATI
 → TEMPATKAN BANGUNAN SEJAUH MUNGKIN
 DARI JALAN

→ GUNAKAN PONDORUMAHAMAN UNTUK
 MENYARING KEBISINGAN

→ GUNAKAN RUANG PENYANGGA, MIS: GUDANG
 UTK MELINDUNGI RUANG YG TENANG

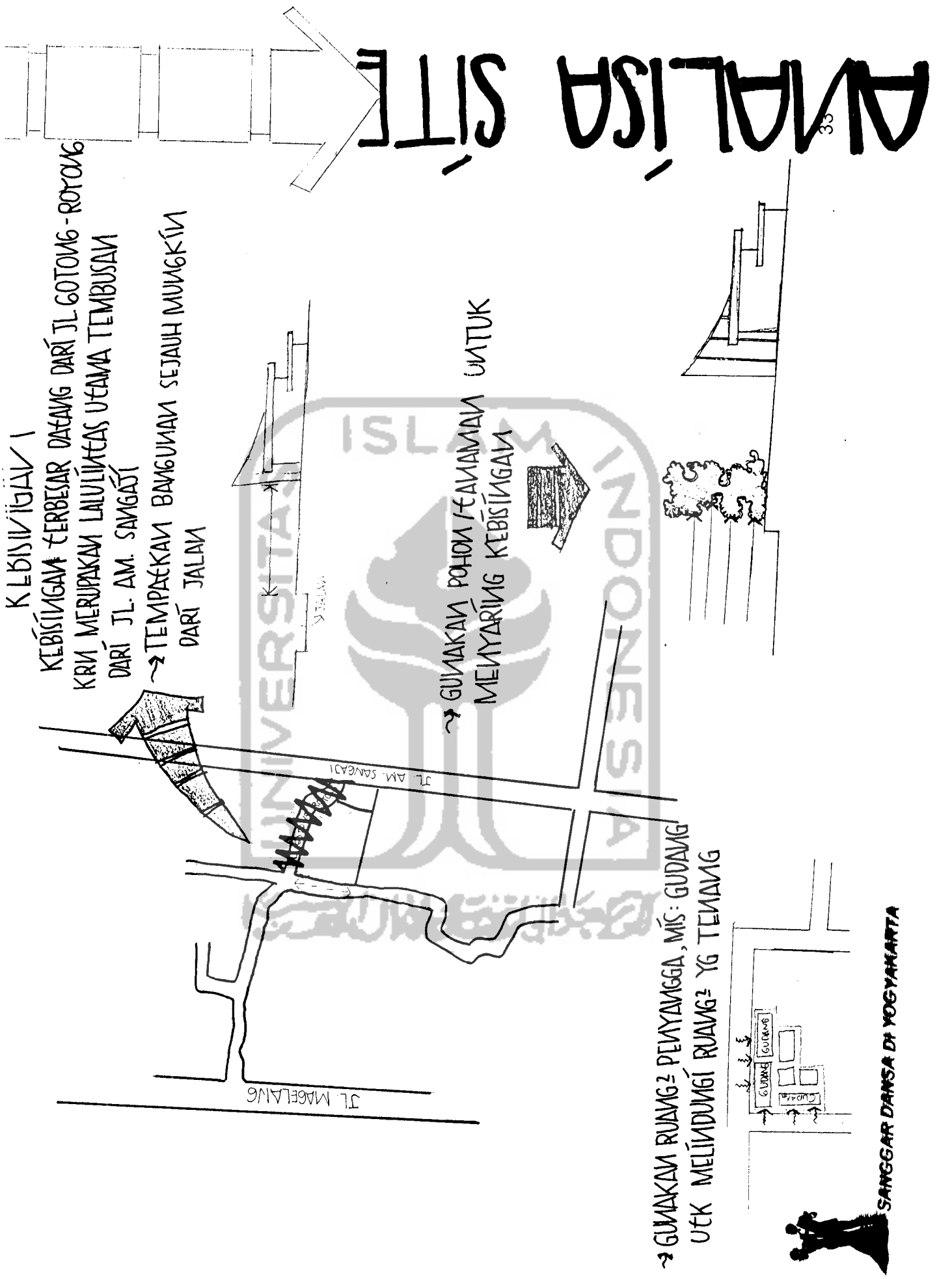

LALU-LINTAS KENDARAAN

↔ LALU LINTAS BESAR

↔ LALU LINTAS SEDANG

LALU-LINTAS KENDARAAN DI LUAR TAPAK.
 • GUNAKAN GANG (LALU LINTAS SEDANG) UNTUK
 SIRKULASI TAPAK SEKELILING & JI PARKIR

• MASUKI TAPAK ■ PADA
 TITIK TERJAUH DR
 PERSIMPANGAN

• BUAT POLA BARU MELALUI
 TAPAK BILA PERLU

LALU LINTAS KENDARAAN DI DLM TAPAK

• PERKUAT SUASANA YANG DIALAMI PENGENDARA

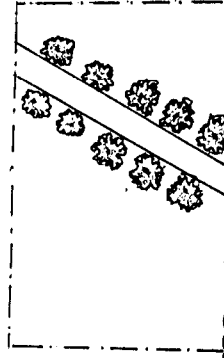
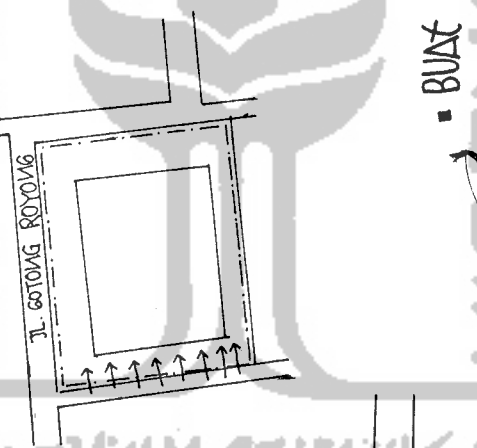
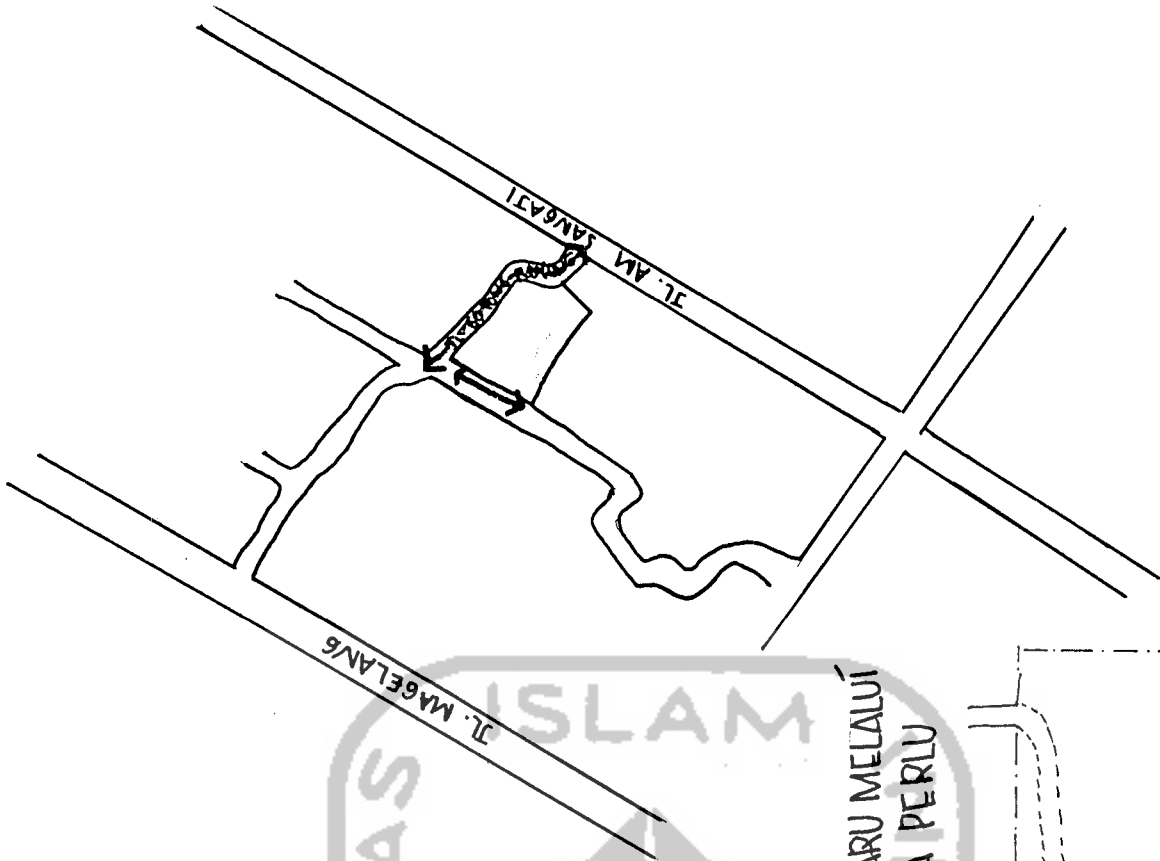

SANGGAR BANGSA BHYOGYAKARTA

ANNA ISA CHT

PEMAMDAGAN DARI CARAK

→ SEMUA BANGUNAN LAIN HARUS MEYAJIKAN CITRA UMUM

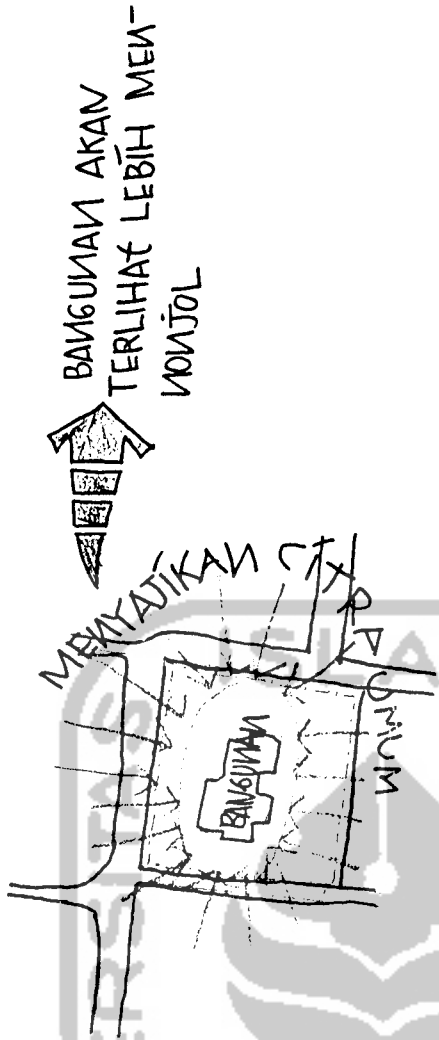
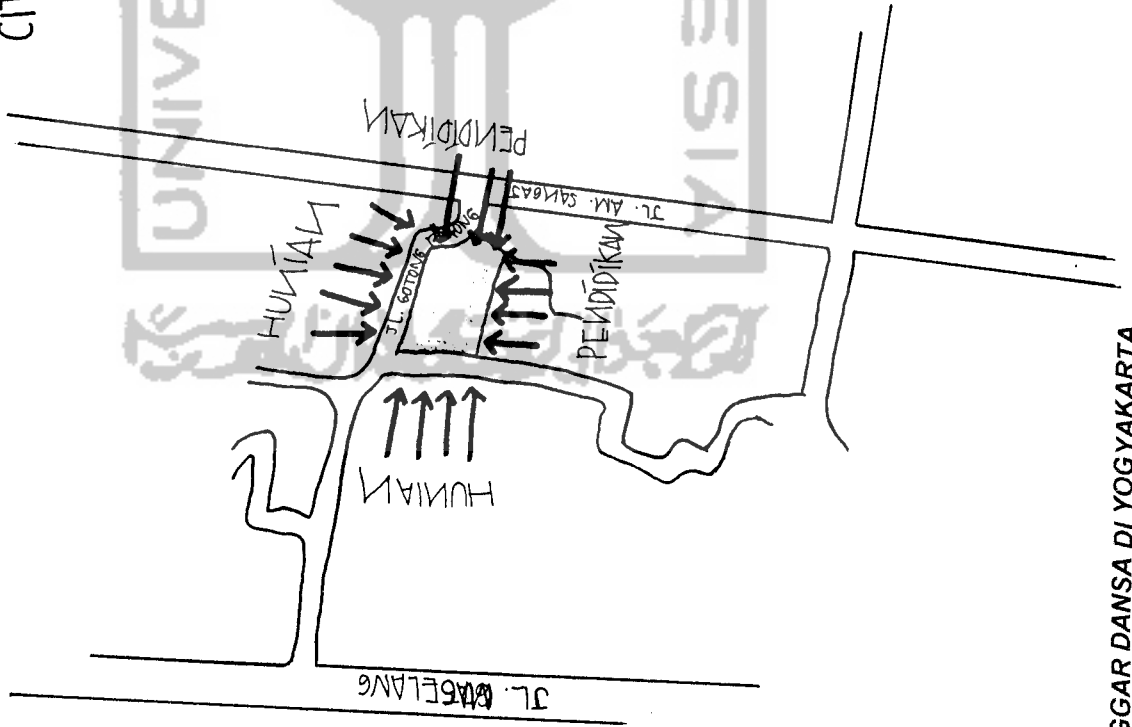

→ CIRIKAM: JALUR PEMAMDAGAN DENGAN PERTAMANAN

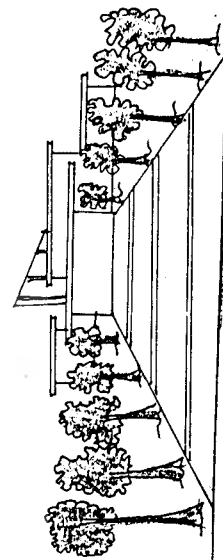

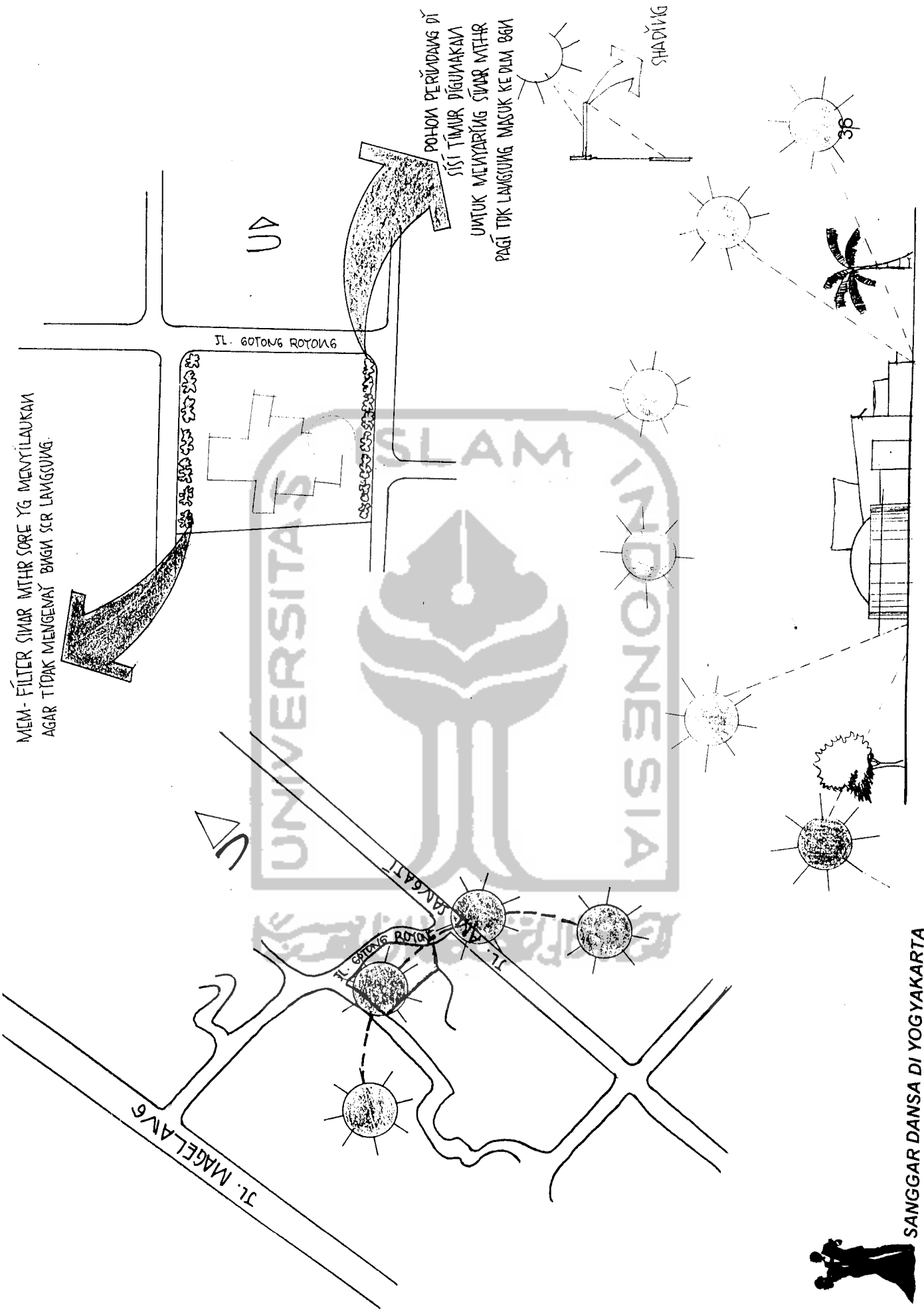

SANGGAR DANCE DI YOGYAKARTA

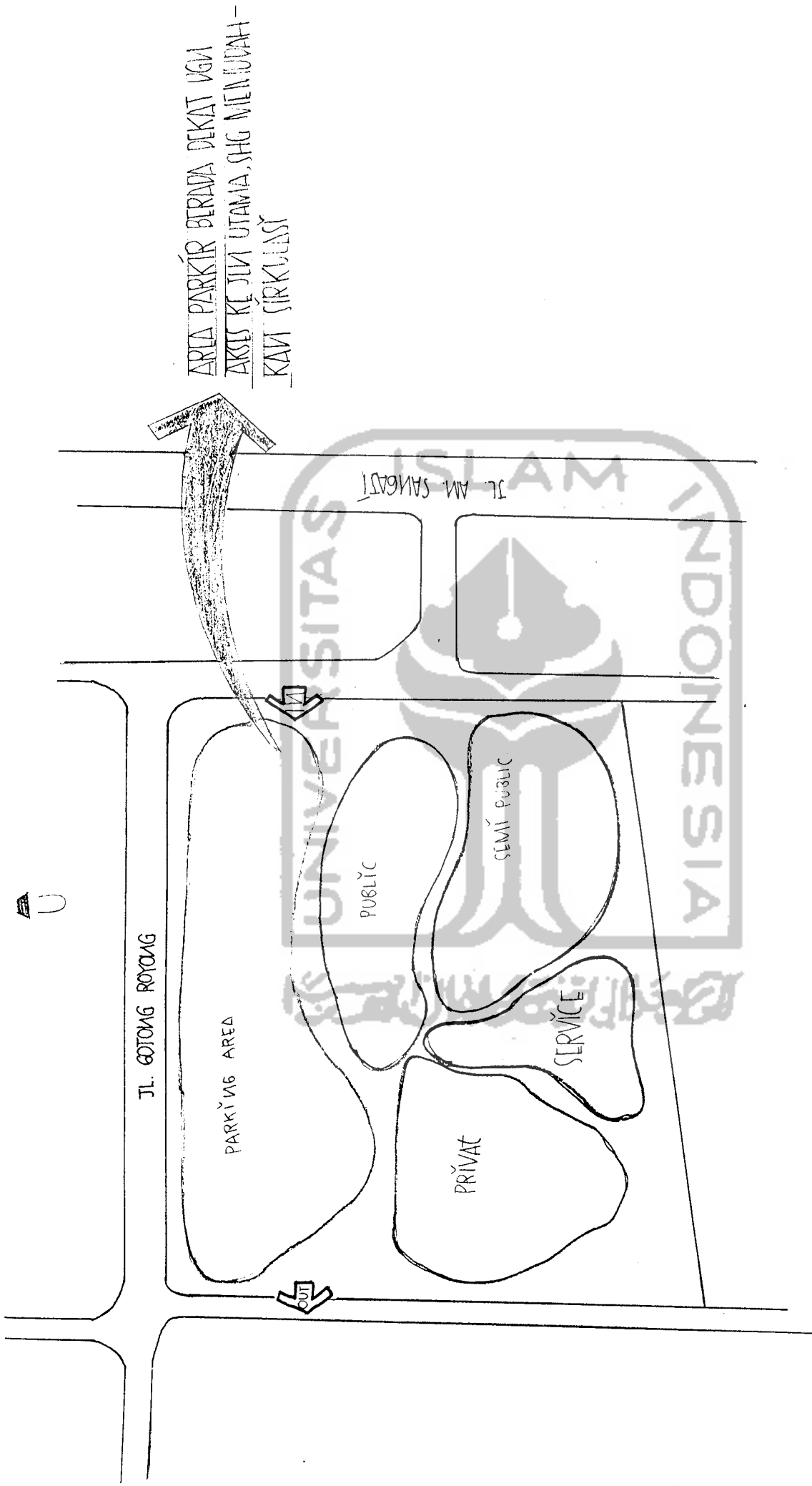

ZONING

100% PERSEKUTUAN
DAN JALAN SIKULASI
KENDARAAN

SISTEM SIKULASI DAMI PARKIR
1 SIKULASI KENDARAAN
JL UNTUK KENDARAAN 1 ARUH AGAR TOK TJD
KEMACETAN

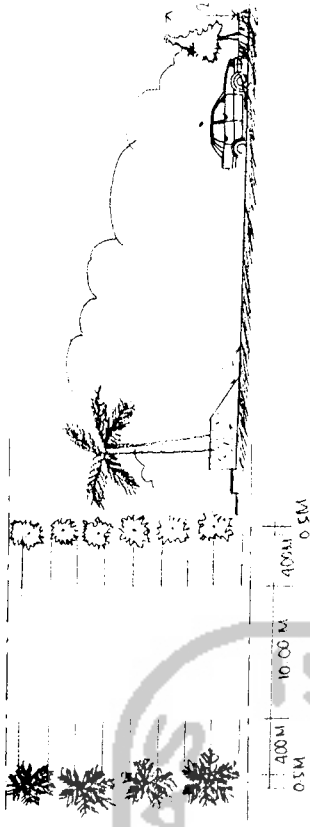

2 SIKULASI PEDALAI KAKI
PEDESTRIAN DIJAUH BERDAMPYAKAN DAN SIKULASI KENDARAAN
AGAR MENYERIKAI KEMAMPUAN 26 PEDALAI KAKI

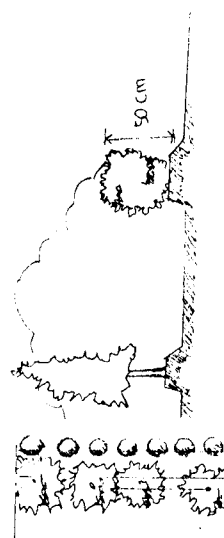

PALM (SBG VEGETAS DOMINAN)

PERKERASAN DGM BATU ALAM

SIKULASI KENDARAAN SERVICE
MORILE BOX UNTUK SUPPLY
KEBUTUHAN KANTIN



SIRKULASI KENDARAAN
PUBLIK



SANGGAR DANSA DI YOGYAKARTA

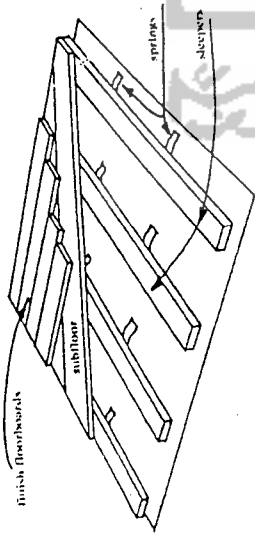

GBR. RESILIENT SLEEPER SYSTEM

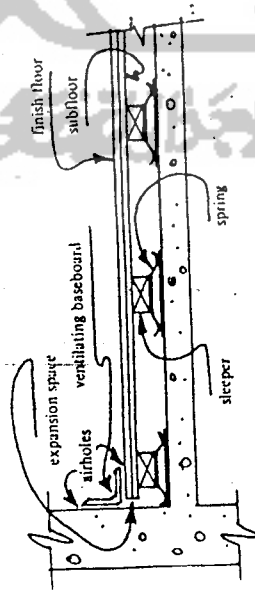

POTONGAN RESILIENT SLEEPER SYSTEM

JENIS LANTAI STUDIO :

1. STRUKTUR LANTAI PD RUANG KLS LANTAI DANCE (STUDIO) DIRANCANG MEMILIKI KELEBIHAN PD PERMASALAHAN BERIKUT DAN PEREDAM KEBISINGAN SUARA YG DPT MUD RUANG TRANSISI UTK BANGUN VINTARAKATA KOMPAK SPT INI AKAN MEREDAM SUARAZ YG DITIMBUKANA OLEH KAKI. SISTEM INI DISEBUT "RESILIENT SLEEPER SYSTEM"

SANGGAR DANCE DI YOGYAKARTA

2. JENIS LANTAI PD BANGUNAN YG MENGGUNAKAN PASANGKAN BATU BATA. PD KONSTRUKSI LANTAI SPT INI TDR BEBERAPA SLAB YG SECARA LANGSUNG BERTUBUNGAN DGN PERMUKAAN BANGUNAN

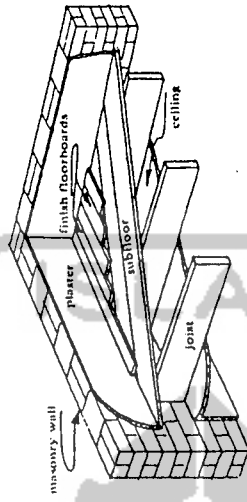

POT. AXONO PASANGKAN KAYU PD DWOTING BATU BATA

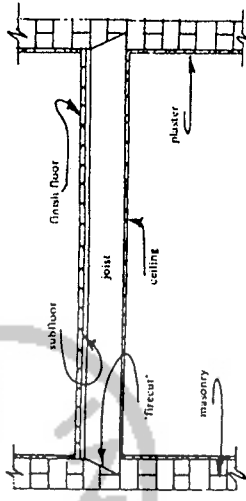

POTONGAN

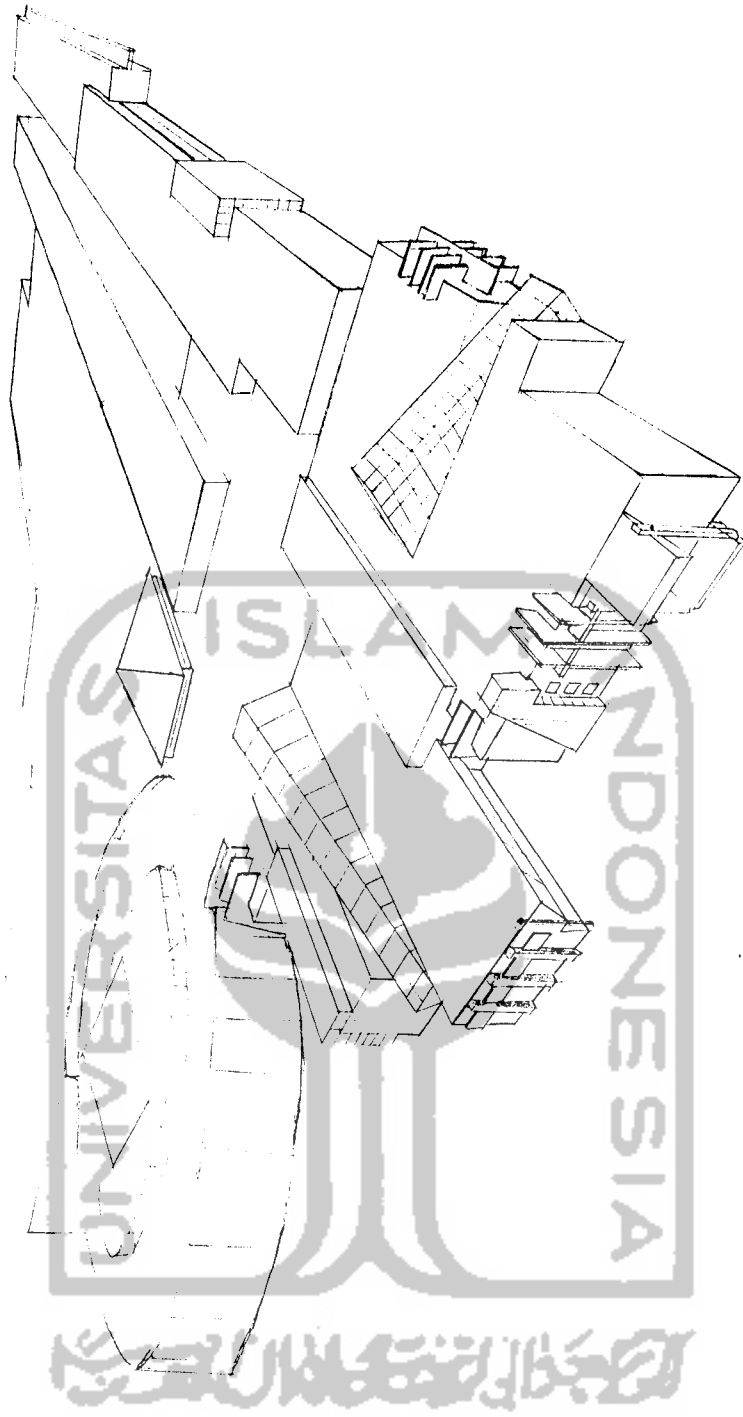

PERSPEKTIF



