

LAMPIRAN

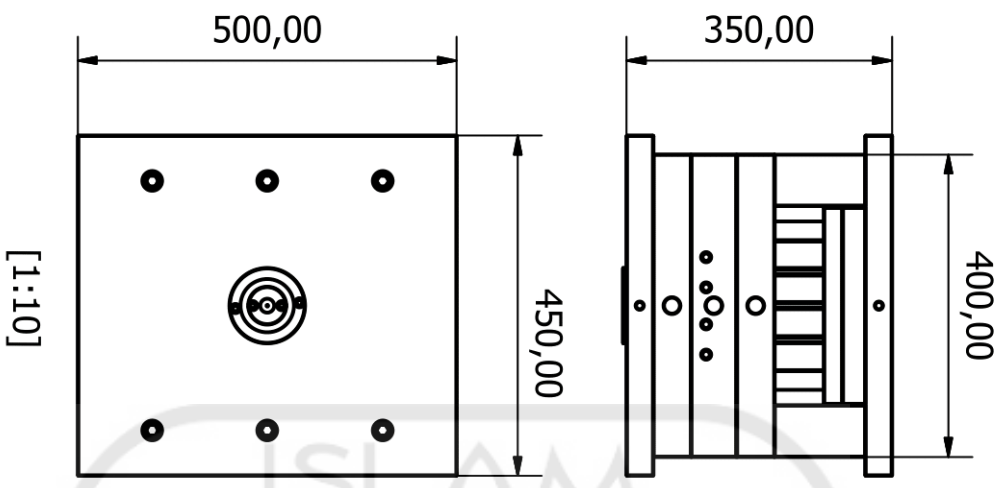

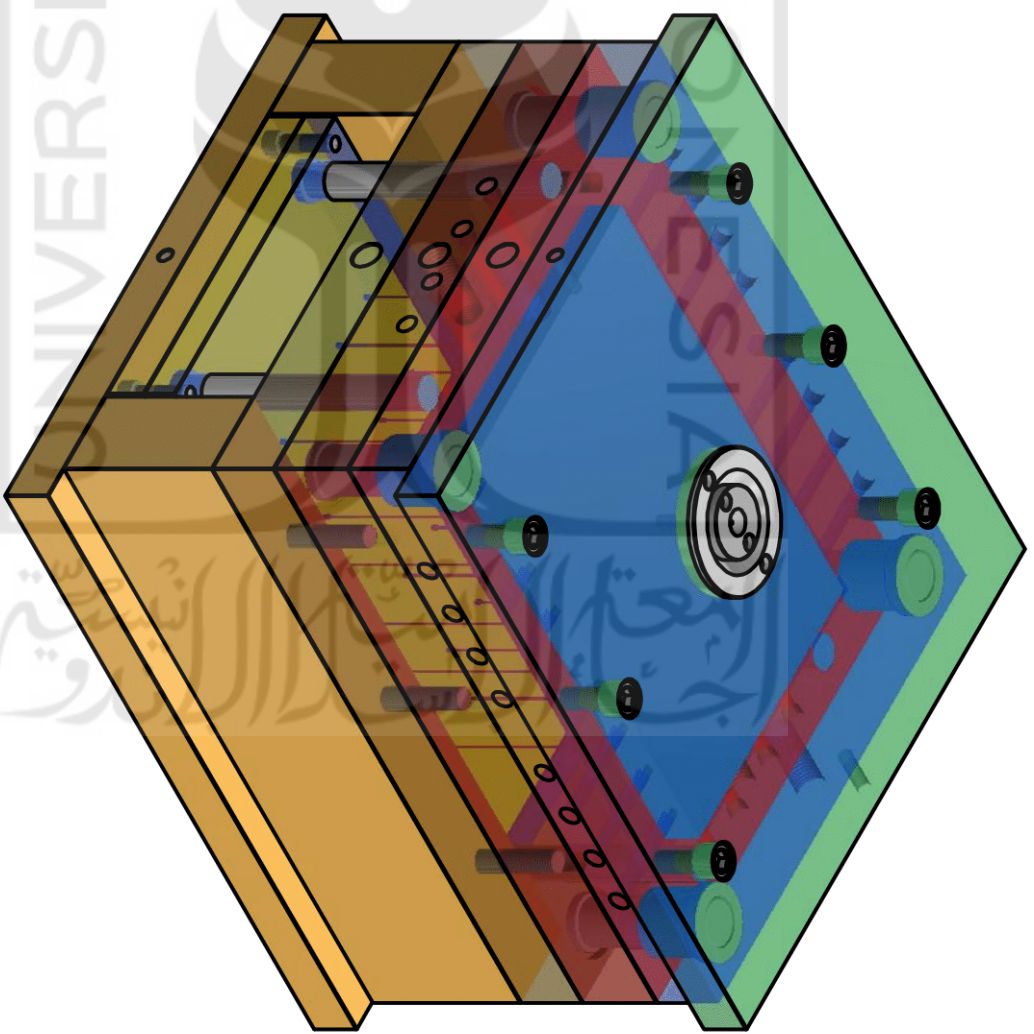

[1:10]



[1 : 5]



Skala :

Satuan Ukuran : mm

Tanggal : 27-06-19

Digambar : Muchlis

NIM : 14525014

Diperiksa : Arif Budi Wicaksono S.T., M.Eng.

Keterangan :

Teknik Mesin-FTI UII

MOLD UNIT GRID

No.

A4

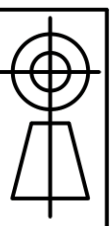
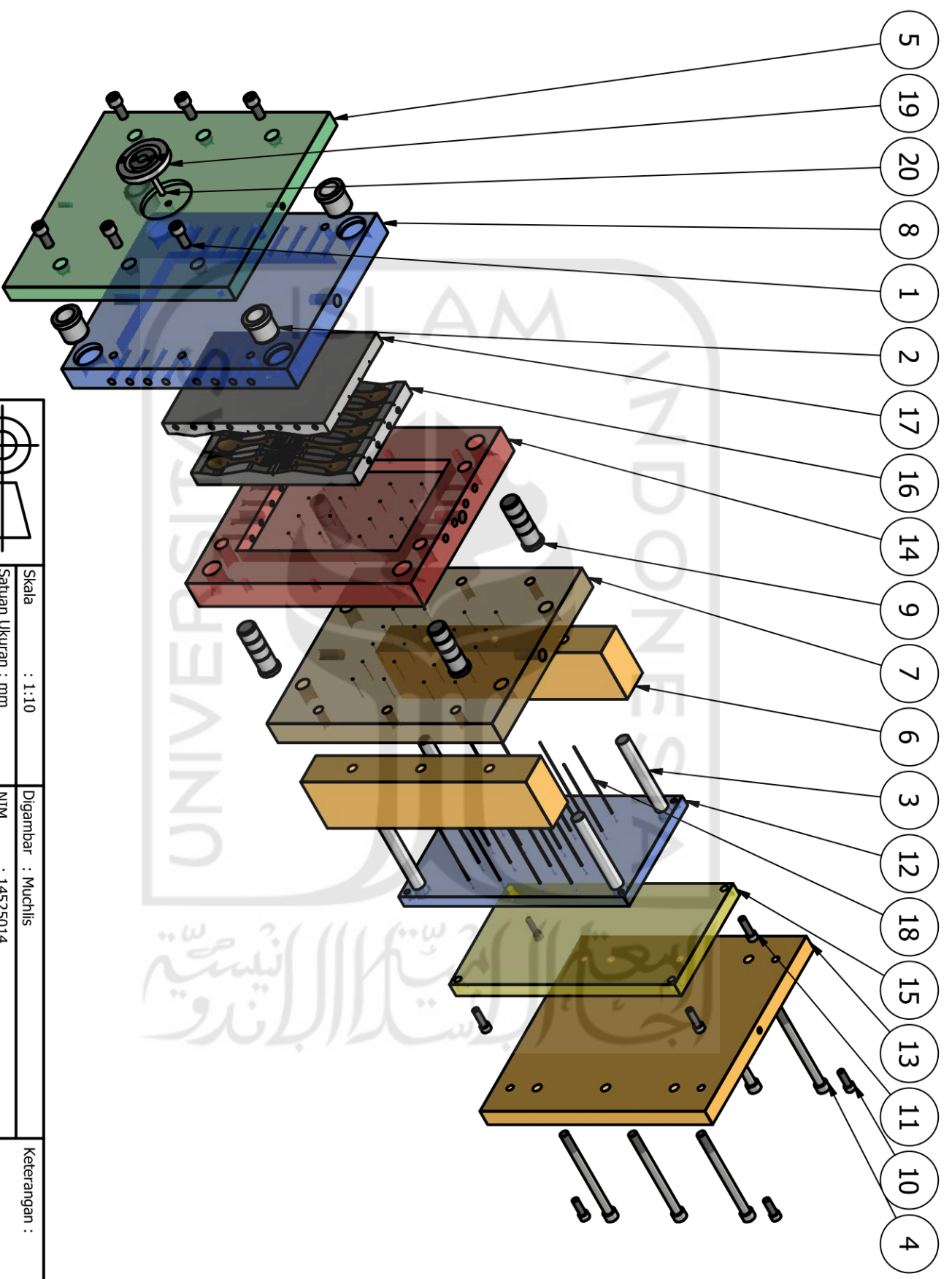

Skala : 1:10

Satuan Ukuran : mm

Tanggal : 27-06-19

Digambar : Muchlis

NIM : 14525014

Diperiksa : Arif Budi Wicaksono S.T., M.Eng.

Keterangan :

Teknik Mesin-FTI UII

MOLD UNIT GRID

No.

A4

PARTS LIST

ITEM	QTY	PART NUMBER	DESCRIPTION	MATERIAL	MASS
1	6	GB 70-85 M16x35	Hexagon Socket Head Cap Screw	Steel, Mild	0,099 kg
2	4	SGB 35x50	Shoulder Guide Bush	SUJ 2	0,368 kg
3	4	RETURN PIN_LKM25x200	Return Pin	SUJ 2	0,784 kg
4	6	GB 70-85 M16x200	Hexagon Socket Head Cap Screw	Steel, Mild	0,360 kg
5	1	S-I-TCP-500x450x35x330	Top Clamping Plate	S 55 C	60,504 kg
6	2	S-I-SB-500x400x120	Spacer Block	S 55 C	31,324 kg
7	1	S-SP-500x400x50	Support Plate	S 55 C	76,752 kg
8	1	S-I-AP-500x400x50	Cavity Plate	S 55 C	53,967 kg
9	4	GP35x110x39	GUIDE PIN	SUJ 2	0,837 kg
10	4	GB 70-85 M12x35	Hexagon Socket Head Cap Screw	Steel, Mild	0,050 kg
11	4	GB 70-85 M12x40	Hexagon Socket Head Cap Screw	Steel, Mild	0,055 kg
12	1	S-ERP-500x260x25	Ejector Retainer Plate	S 55 C	24,968 kg
13	1	S-I-BCP-500x450x35x330	Bottom Clamping Plate	S 55 C	60,909 kg
14	1	S-BP-500x400x60	Core Plate	S 55 C	70,210 kg
15	1	S-EP-500x260x30	Ejector Plate	S 55 C	30,407 kg
16	1	MOLDBASE V3_Combined CR1	Core	SKD 11	2,404 kg
17	1	MOLDBASE V3_Combined CV1	Cavity	SKD 11	16,629 kg
18	20	EP4N2-250	STRAIGHT EJECTOR PINS	SKD 61	0,005 kg
19	1	LR-100-50	Locating Ring	S 45 C	0,608 kg
20	1	SBBE10-75-SR10,5-P2-A1	SPRUE BUSHINGS—NORMAL BOLT TYPE·15mm THICK FLANGE—	Nickel alloy	0,287 kg



Skala : 1:1

Satuan Ukuran : mm

Tanggal : 27-06-19

Digambar : Muchlis

NIM : 14525014

Diperiksa : Arif Budi Wicaksono S.T., M.Eng.

Keterangan :

Teknik Mesin-FTI UJI

PART LIST MOLD UNIT GRID

No.

A4

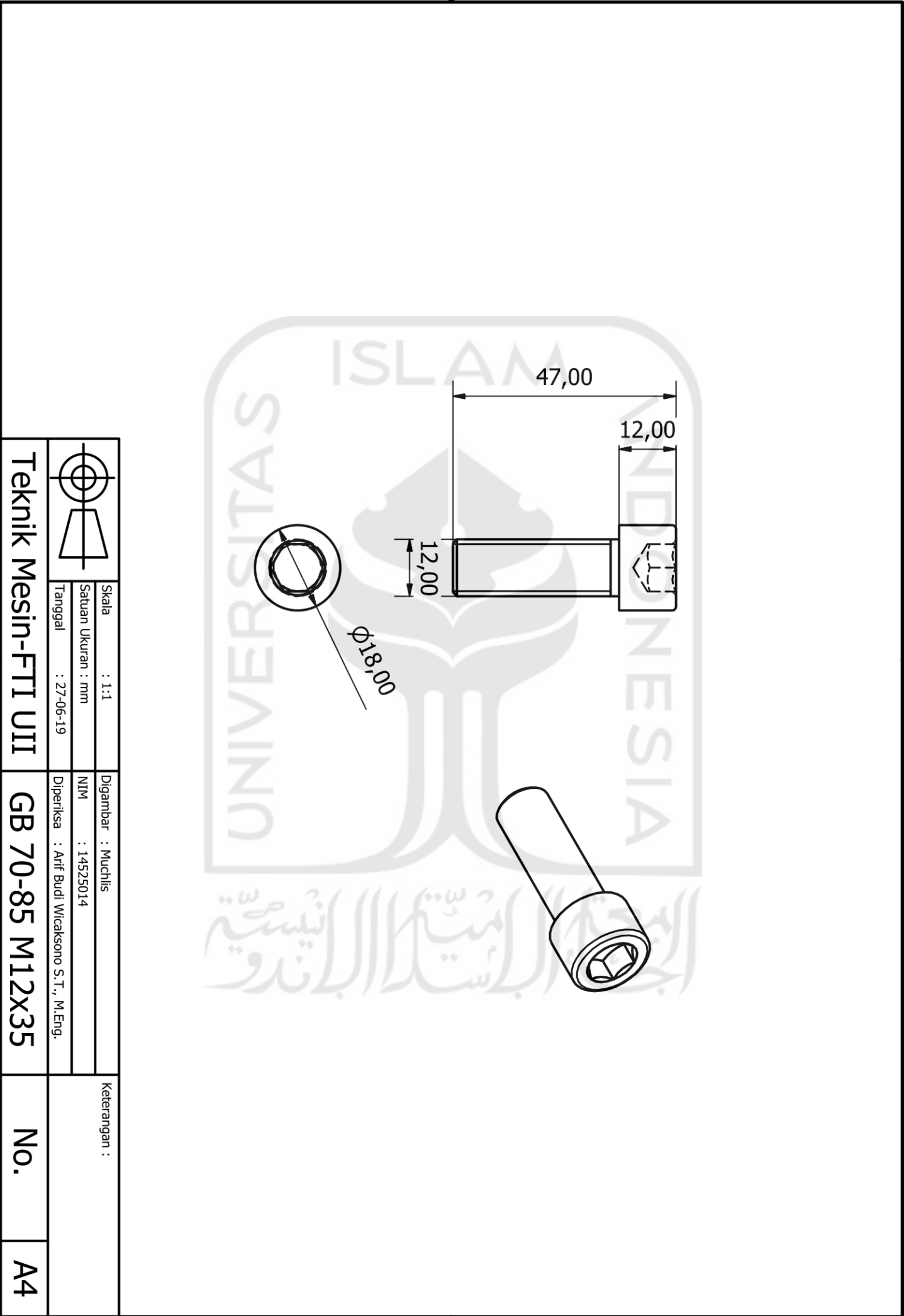

Skala : 1:1

Satuan Ukuran : mm

Tanggal : 27-06-19

Digambar : Muchlis

NIM : 14525014

Diperiksa : Arif Budi Wicaksono S.T., M.Eng.

Keterangan :

Teknik Mesin-FTI UII

GB 70-85 M12x35

No.

A4

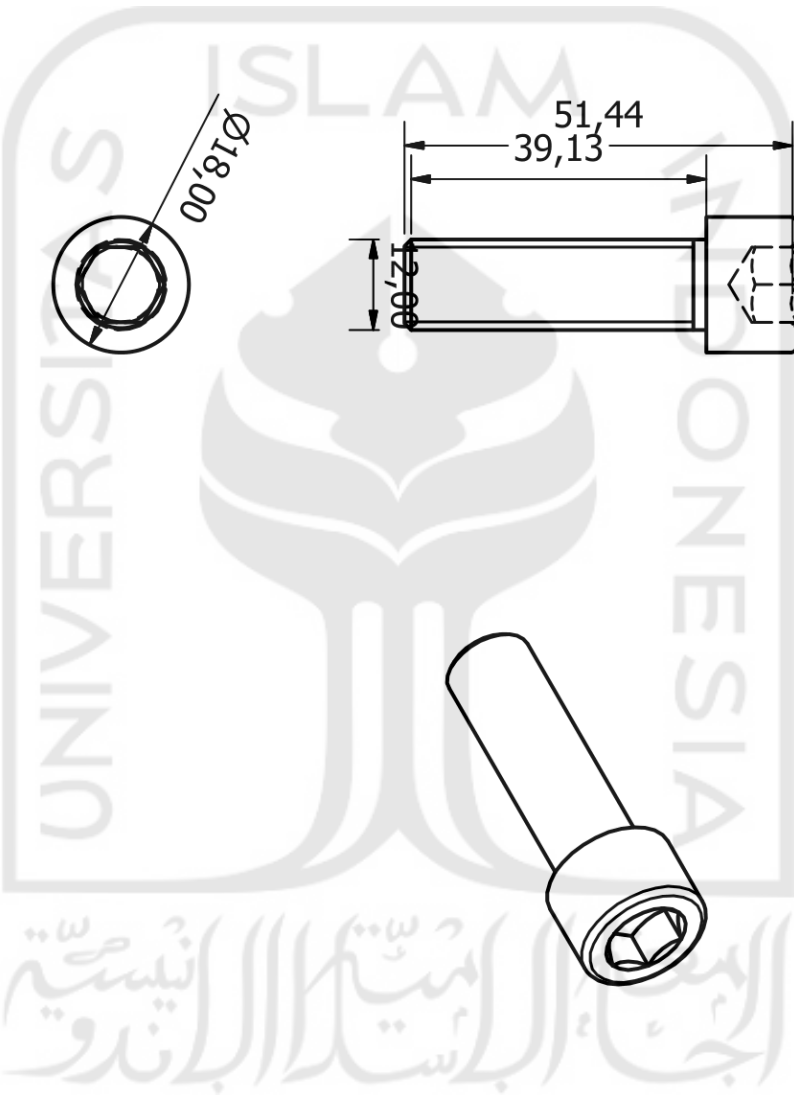
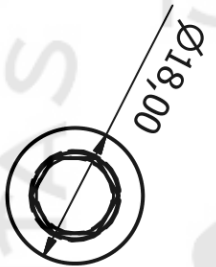
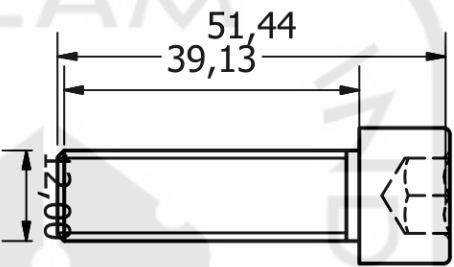

	Skala : 1:1	Digambar : Muchlis	Keterangan :
	Satuan Ukuran : mm	NIM : 14525014	
Tanggal : 27-06-19	Diperiksa : Arif Budi Wicaksono S.T., M.Eng.		
Teknik Mesin-FTI UII		GB 70-85 M12x40	No. A4

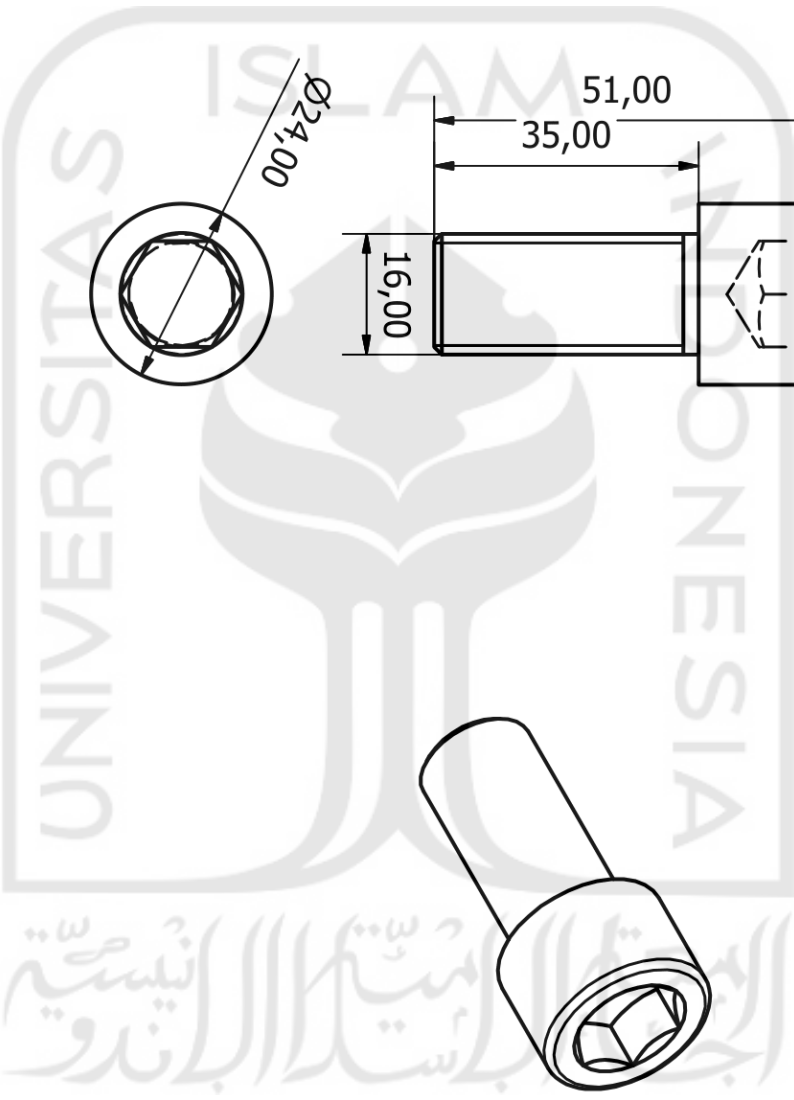
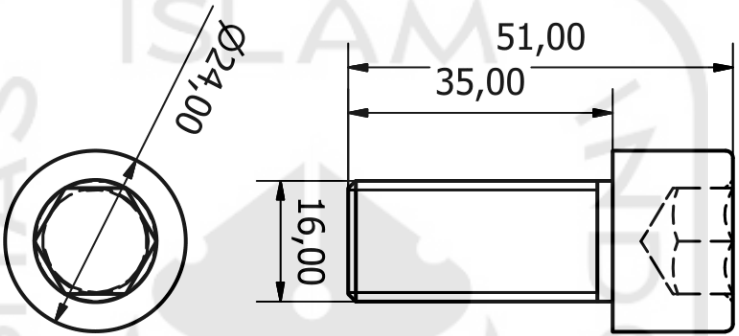

Skala : 1:1
 Satuan Ukuran : mm
 Tanggal : 27-06-19

Digambar : Muchlis
 NIM : 14525014
 Diperiksa : Arif Budi Wicaksono S.T., M.Eng.

Keterangan :

Teknik Mesin-FTI UII

GB 70-85 M16x35

No.

A4

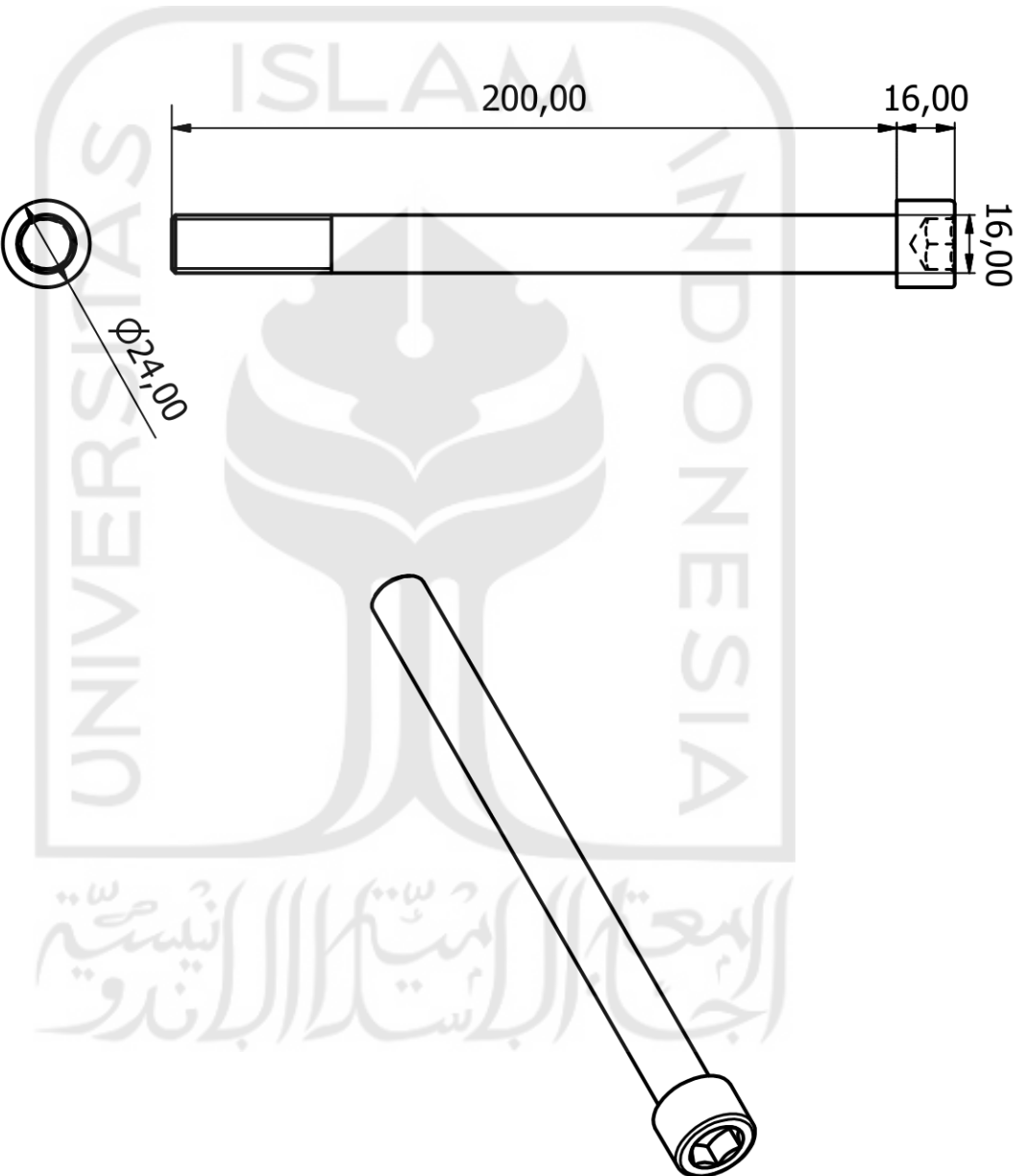

Skala : 1:2
 Satuan Ukuran : mm
 Tanggal : 27-06-19

Digambar : Muchlis
 NIM : 14525014
 Diperiksa : Arif Budi Wicaksono S.T., M.Eng.

Keterangan :

Teknik Mesin-FTI UII

GP 70-85 M16X200

No.

A4

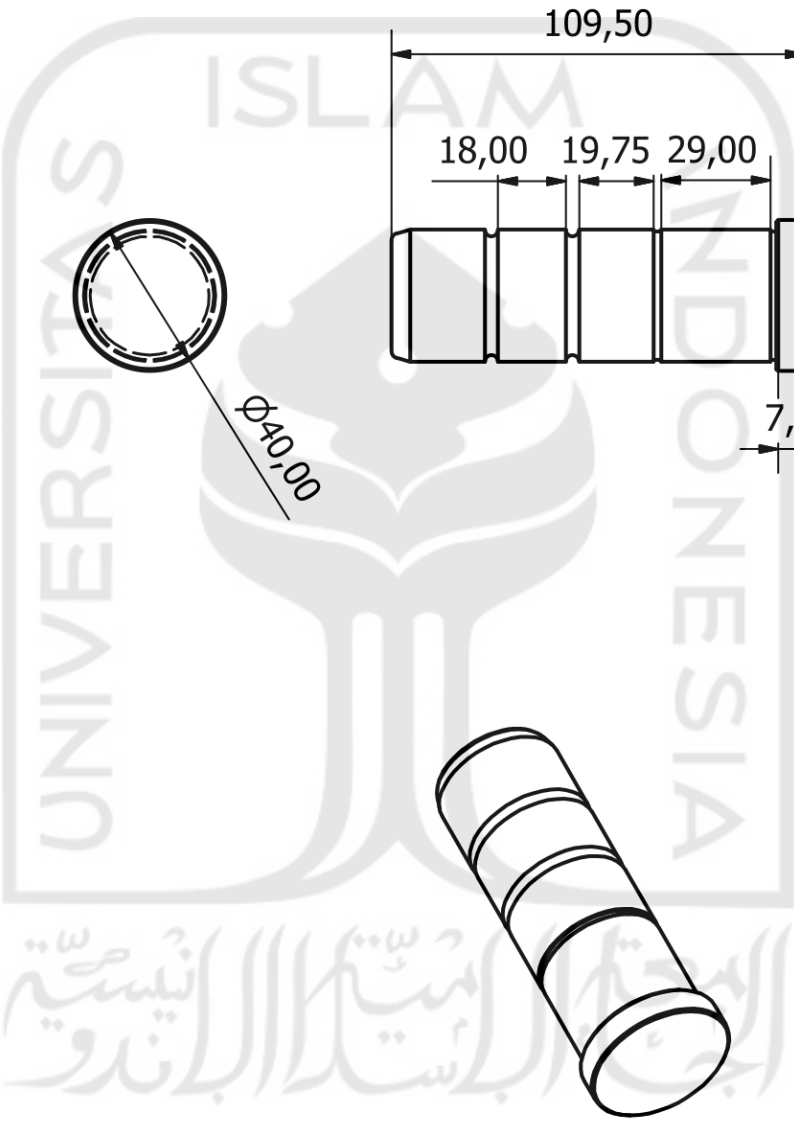
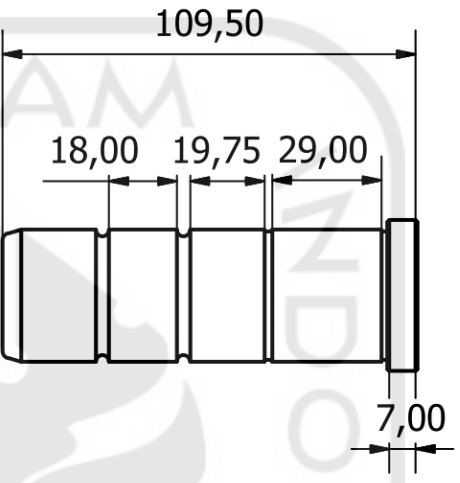

	Skala : 1:4	Digambar : Muchlis	Keterangan :
	Satuan Ukuran : mm	NIM : 14525014	
Tanggal : 27-06-19	Diperiksa : Arif Budi Wicaksono S.T., M.Eng.		
Teknik Mesin-FTI UII		GP 35x110x39	No. A4

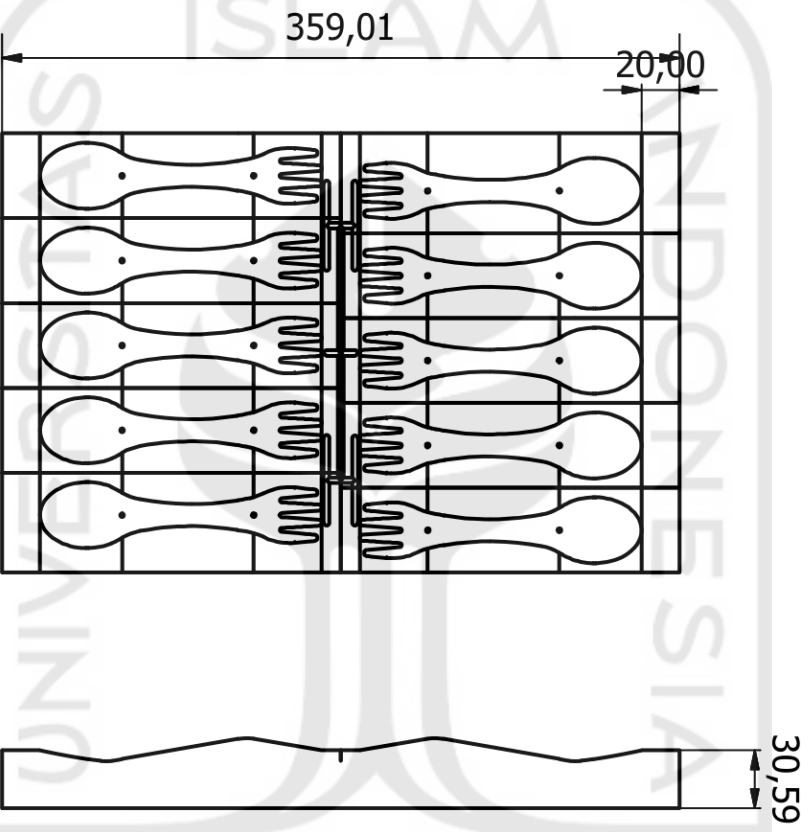
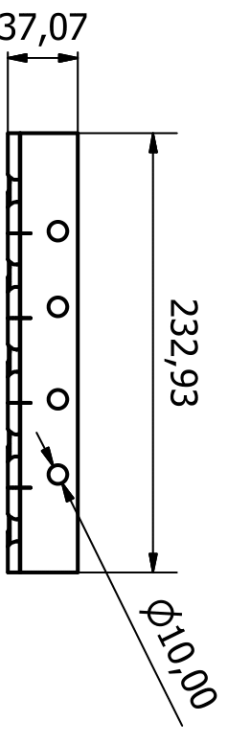

Skala : 1:4
 Satuan Ukuran : mm
 Tanggal : 27-06-19

Digambar : Muchlis
 NIM : 14525014
 Diperiksa : Arif Budi Wicaksono S.T., M.Eng.

Keterangan :

Teknik Mesin-FTI UII

Core

No.

A4

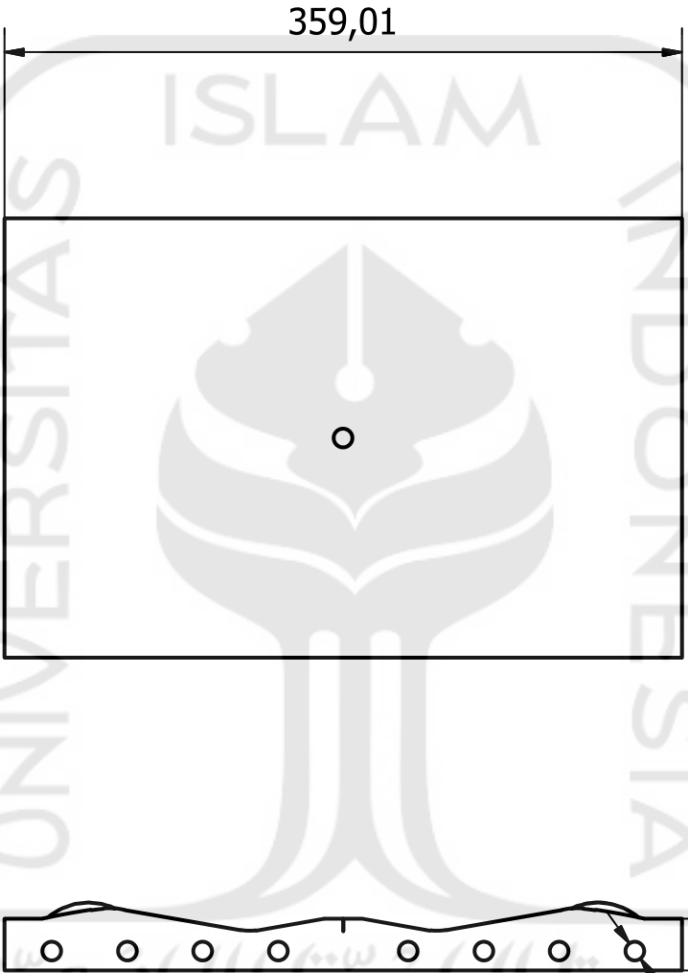
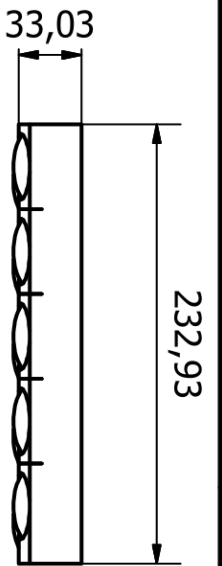

Skala	: 1:4	Digambar	: Muchlis
Satuan Ukuran	: mm	NIM	: 14525014
Tanggal	: 27-06-19	Diperiksa	: Arif Budi Wicaksono S.T., M.Eng.

Keterangan :

Teknik Mesin-FTI UII

Cavity

No.

A4

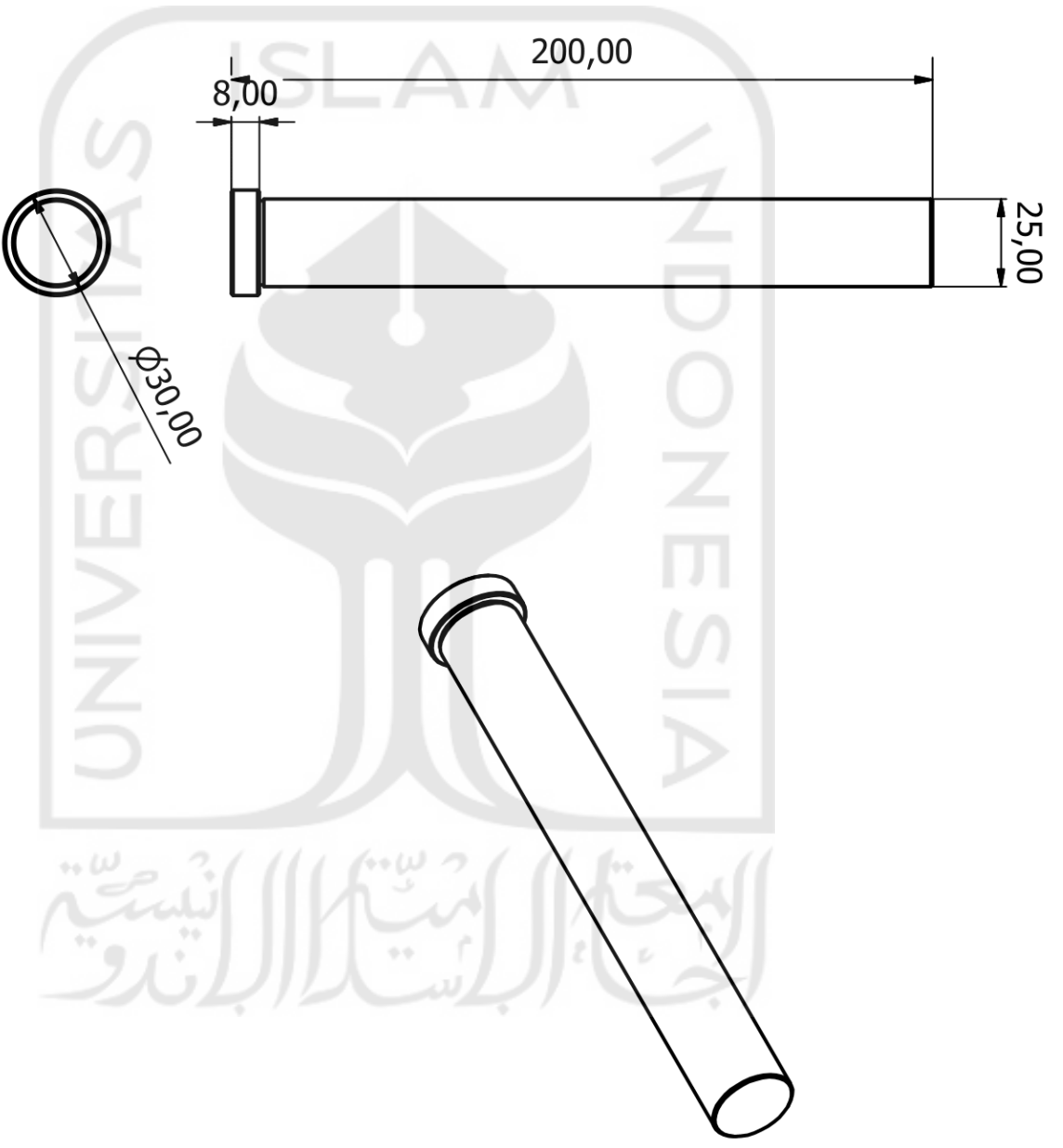

	Skala	: 1:2	Digambar	: Muchlis	Keterangan :
	Satuan Ukuran	: mm	NIM	: 14525014	
Tanggal	: 27-06-19	Diperiksa	: Arif Budi Wicaksono S.T., M.Eng.		
Teknik Mesin-FTI UII		Return Pin		No.	A4

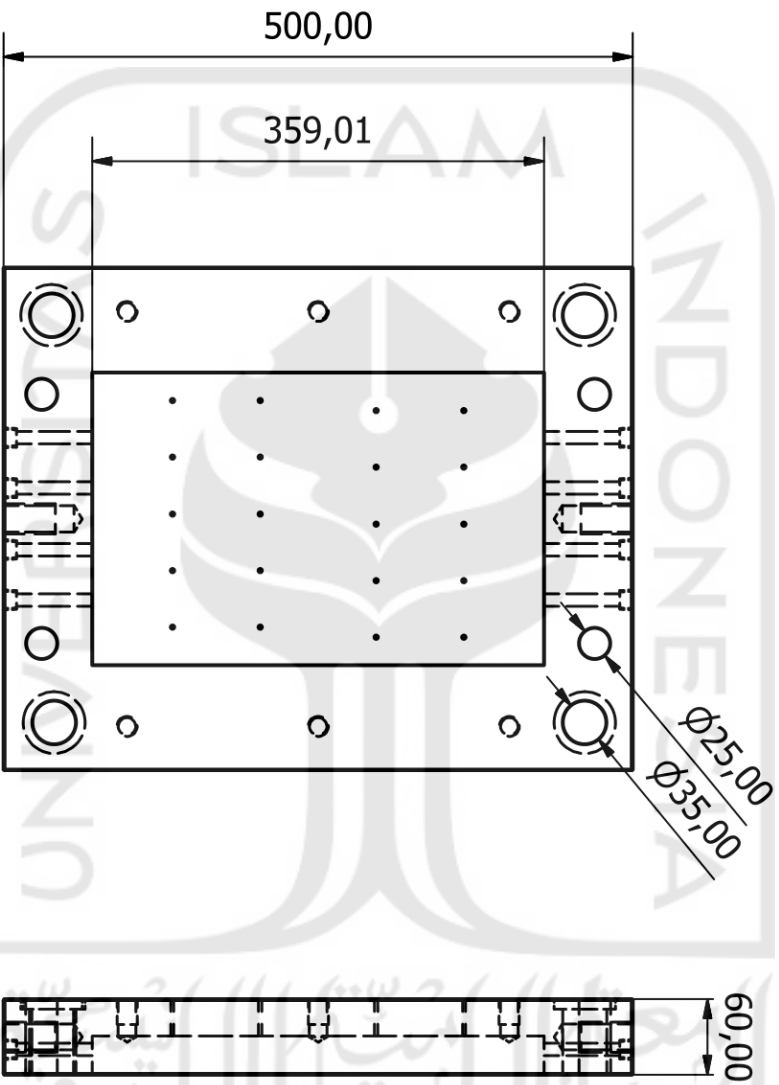
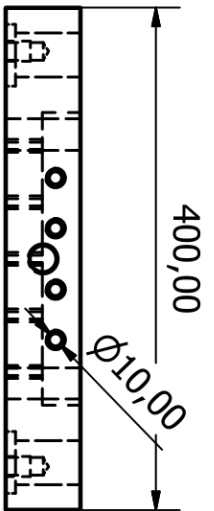

Skala : 1:6
Satuan Ukuran : mm
Tanggal : 27-06-19

Digambar : Muchlis
NIM : 14525014
Diperiksa : Arif Budi Wicaksono S.T., M.Eng.

Keterangan :

Teknik Mesin-FTI UII

Core Plate

No.

A4

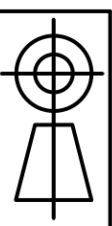
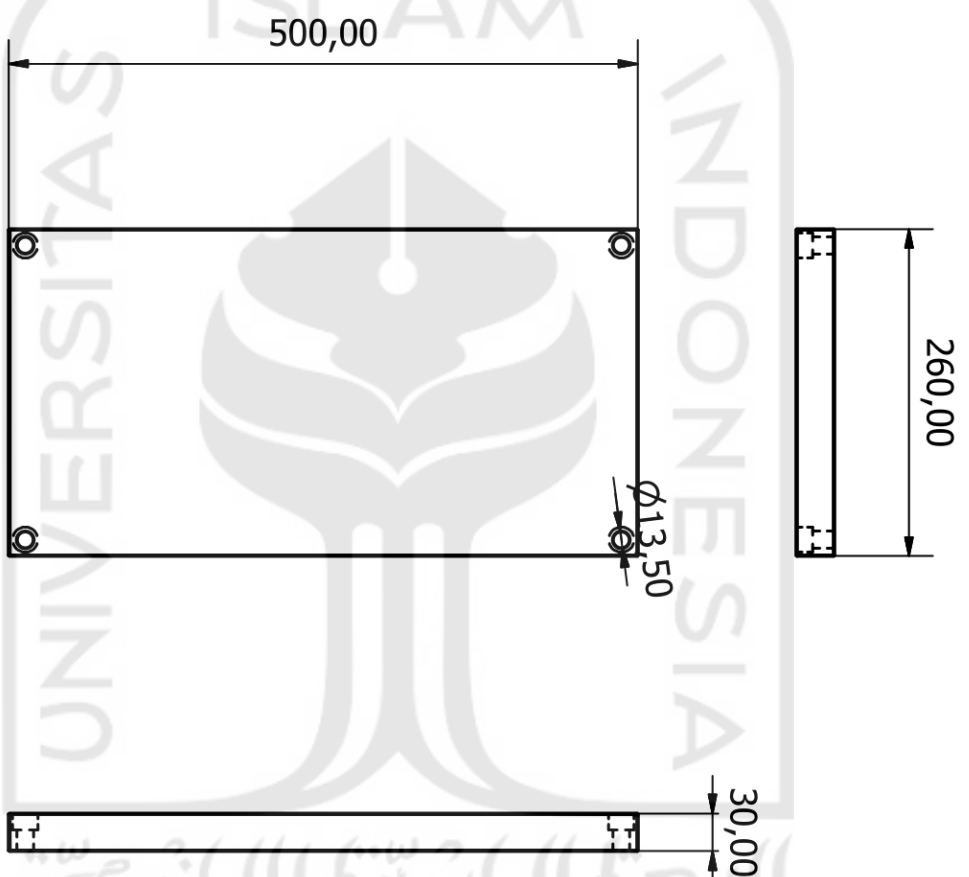
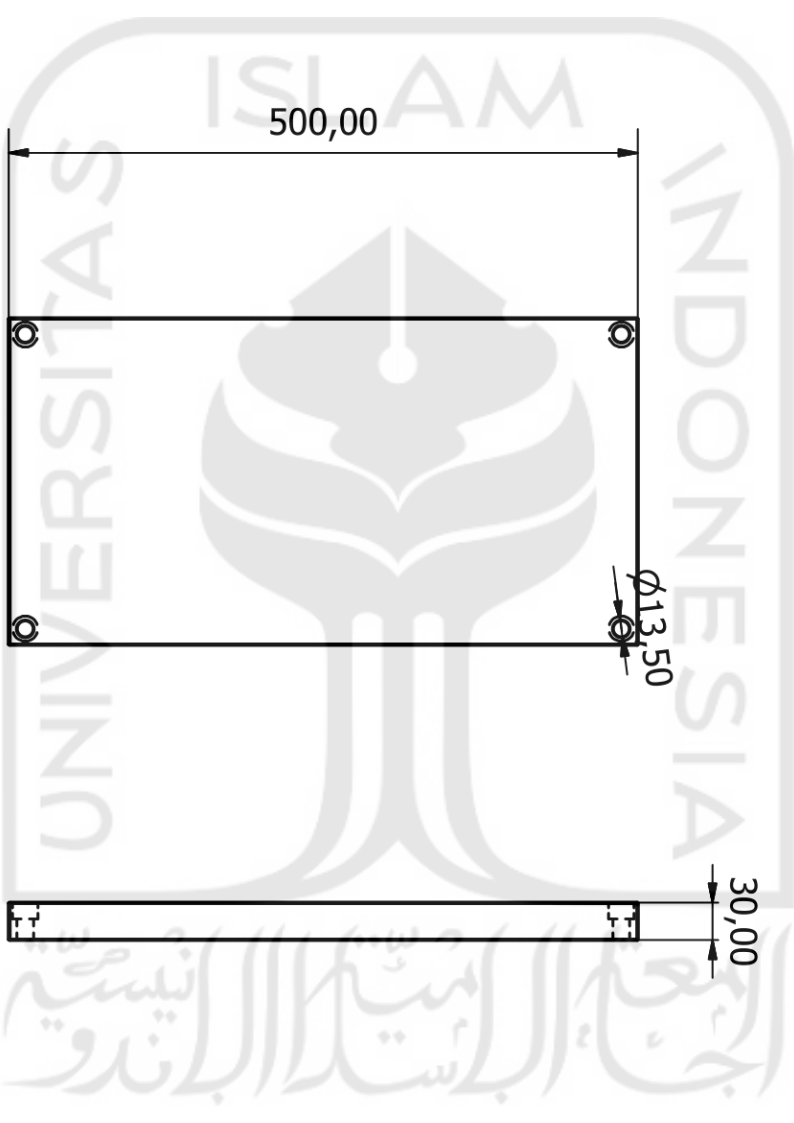

Skala	: 1:6	Digambar	: Muchlis
Satuan Ukuran	: mm	NIM	: 14525014
Tanggal	: 27-06-19	Diperiksa	: Arif Budi Wicaksono S.T., M.Eng.

Keterangan :

Teknik Mesin-FTI UII		Ejector Plate		No.	A4
----------------------	--	---------------	--	-----	----

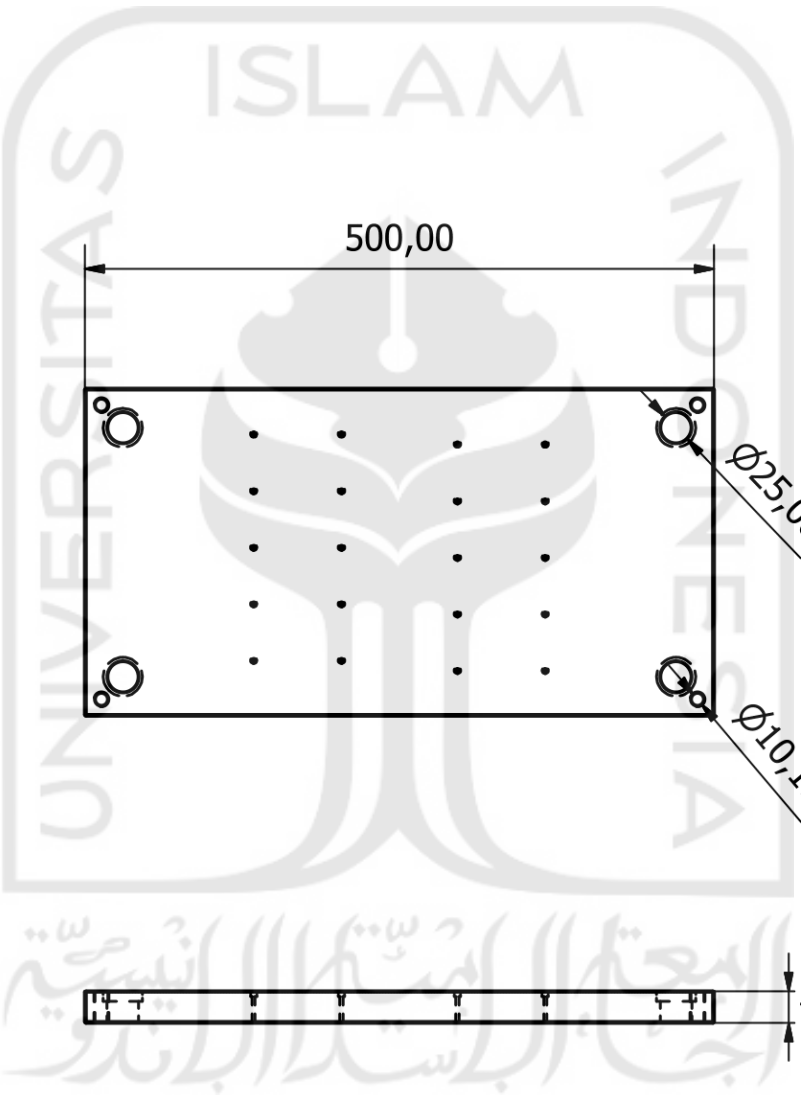
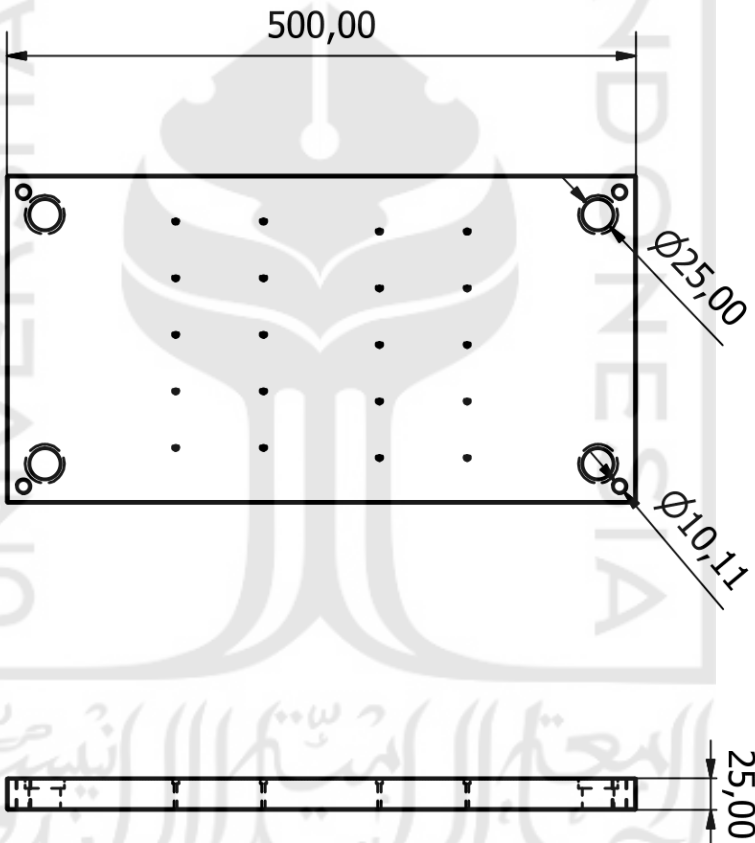
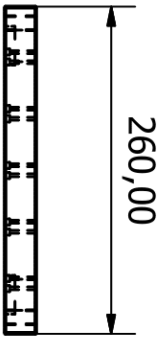

Skala : 1:6
 Satuan Ukuran : mm
 Tanggal : 27-06-19

Digambar : Muchlis
 NIM : 14525014
 Diperiksa : Arif Budi Wicaksono S.T., M.Eng.

Keterangan :

Teknik Mesin-FTI UII

Ejector Retainer

No.

A4

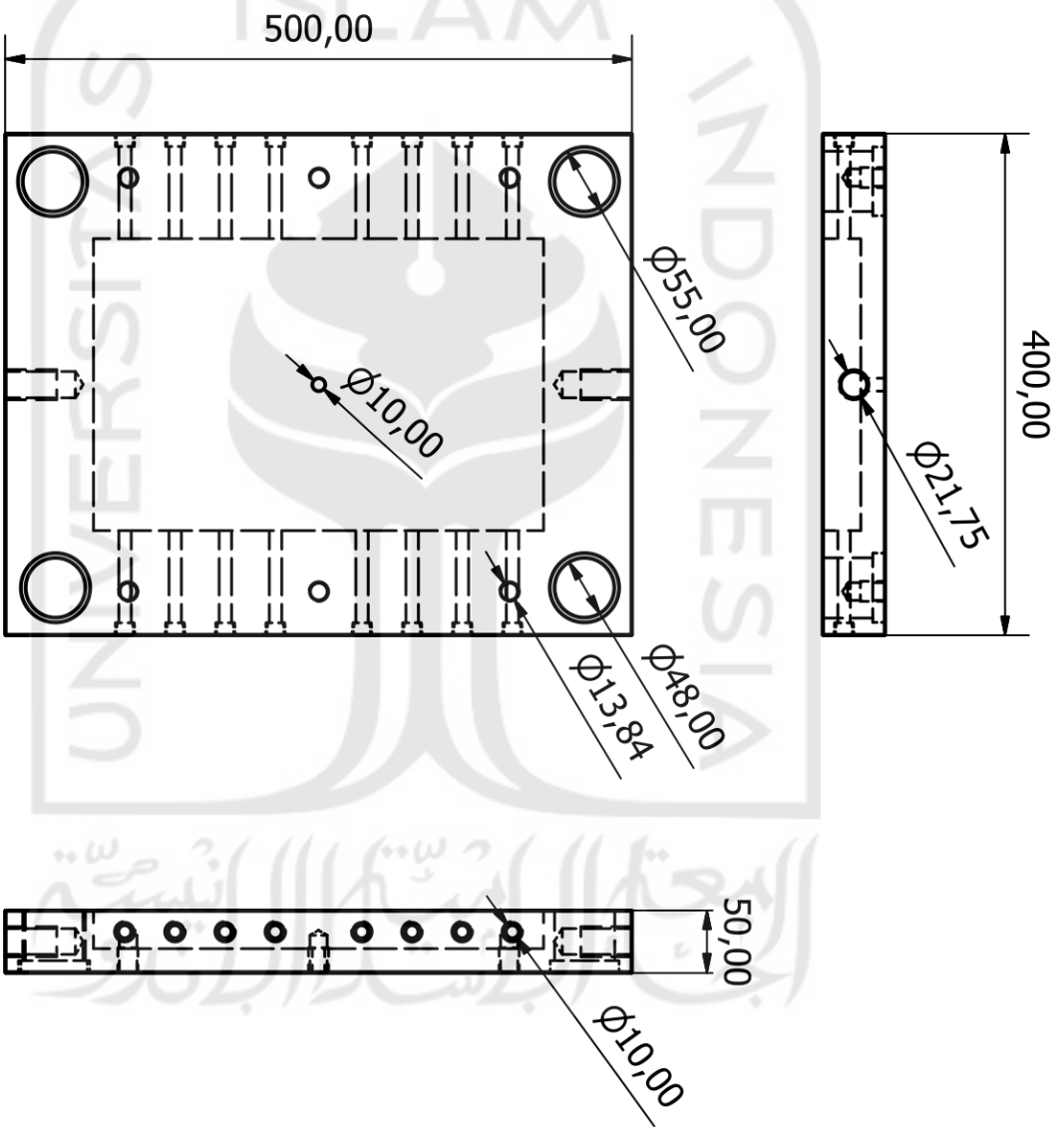

Skala : 1:6
 Satuan Ukuran : mm
 Tanggal : 27-06-19

Digambar : Muchlis
 NIM : 14525014
 Diperiksa : Arif Budi Wicaksono S.T., M.Eng.

Keterangan :

Teknik Mesin-FTI UII

Cavity Plate

No.

A4

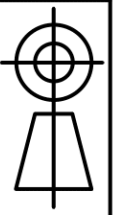
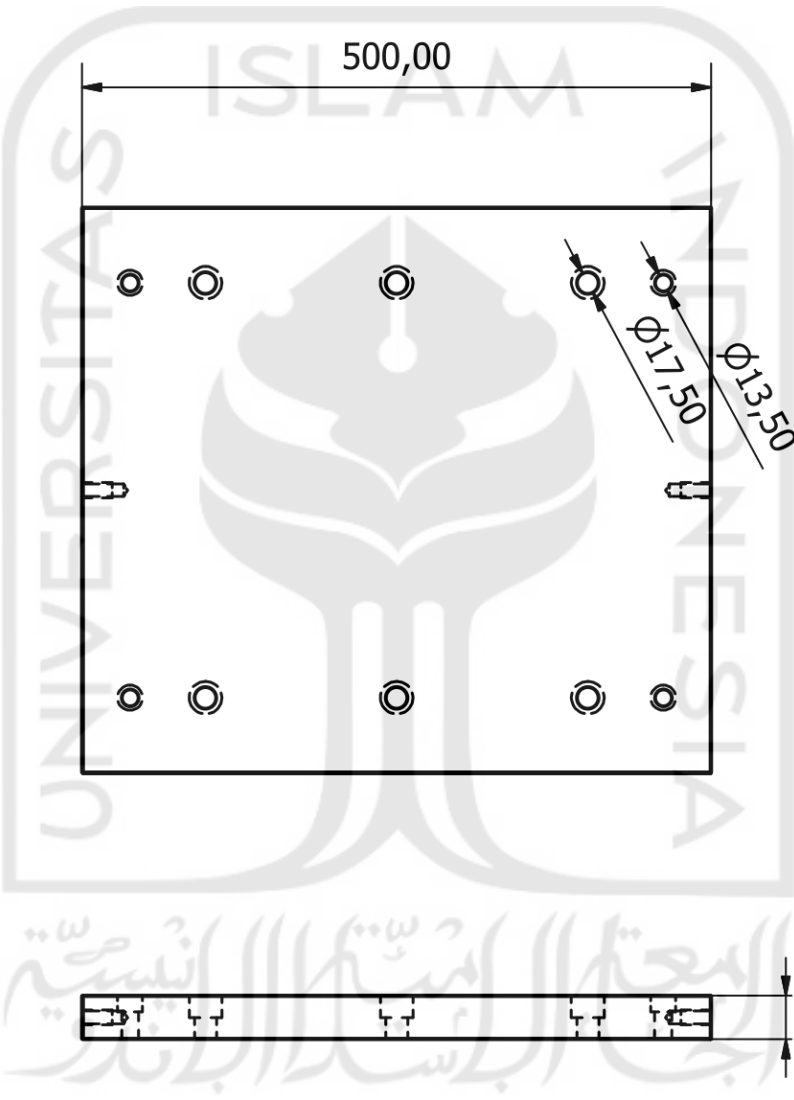
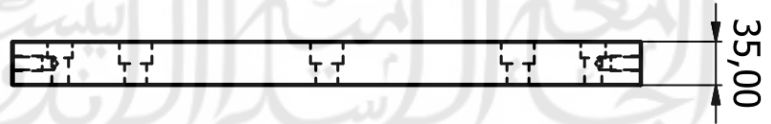
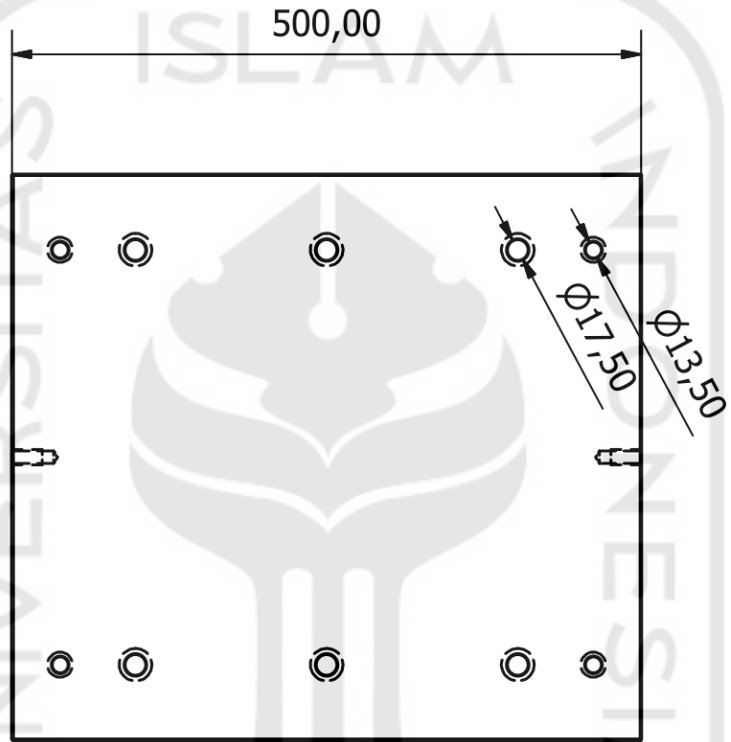
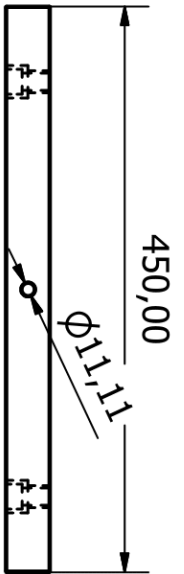

Skala : 1:6
Satuan Ukuran : mm
Tanggal : 27-06-19

Digambar : Muchlis
NIM : 14525014
Diperiksa : Arif Budi Wicaksono S.T., M.Eng.

Keterangan :

Teknik Mesin-FTI UII

Bottom Clamping Plate

No.

A4

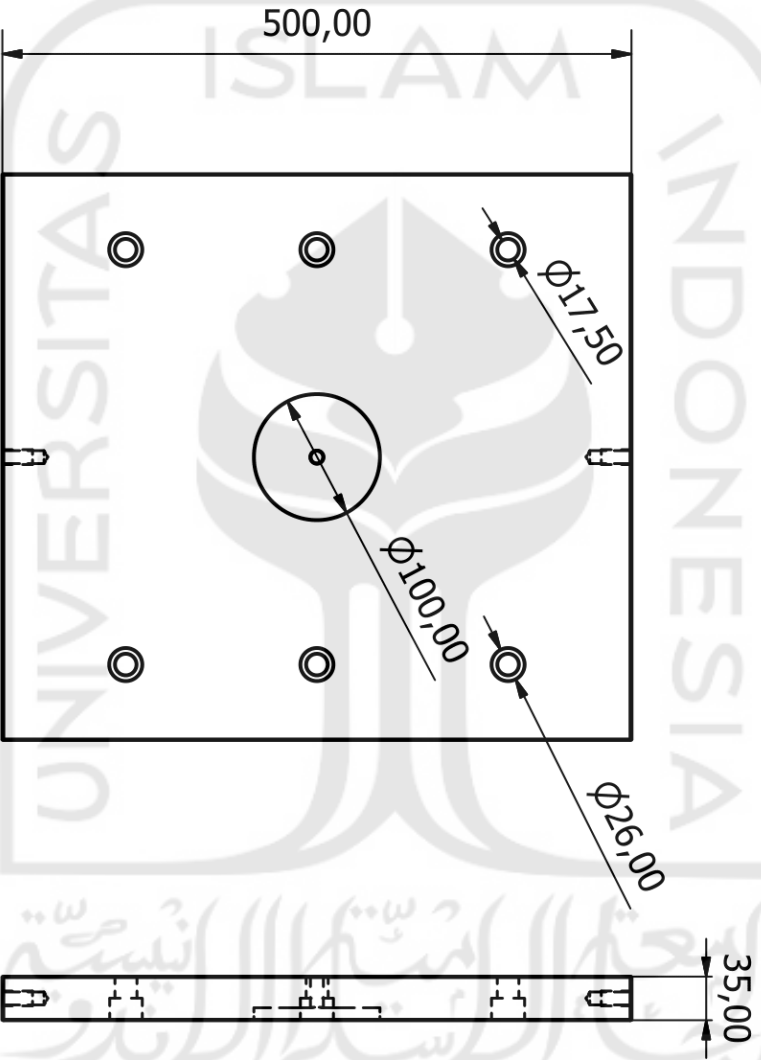
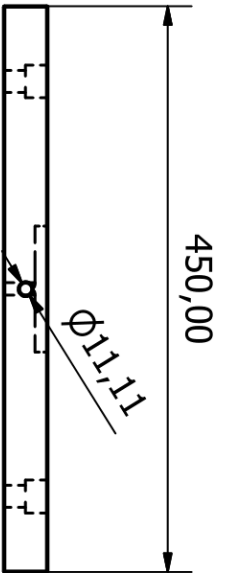

Skala : 1:6
 Satuan Ukuran : mm
 Tanggal : 27-06-19

Digambar : Muchlis
 NIM : 14525014
 Diperiksa : Arif Budi Wicaksono S.T., M.Eng.

Keterangan :

Teknik Mesin-FTI UII

Top Clamping Plate

No.

A4

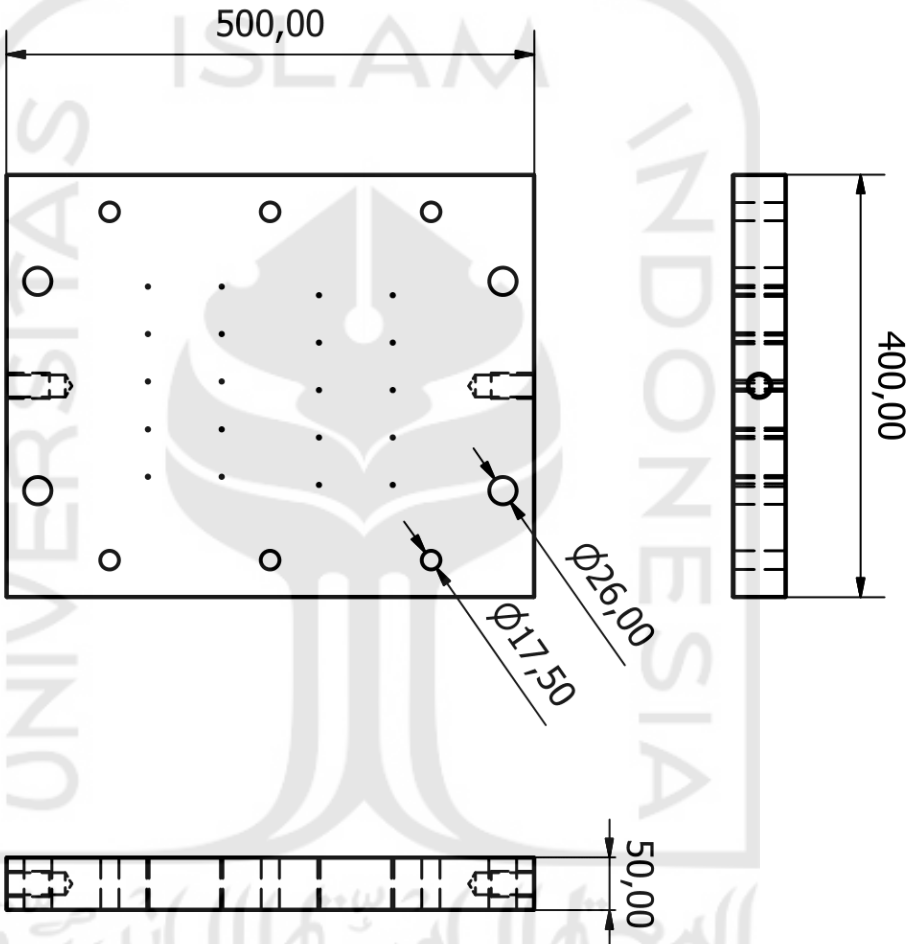

Skala : 1:6
 Satuan Ukuran : mm
 Tanggal : 27-06-19

Digambar : Muchlis
 NIM : 14525014
 Diperiksa : Arif Budi Wicaksono S.T., M.Eng.

Keterangan :

Teknik Mesin-FTI UII

Support Plate

No.

A4

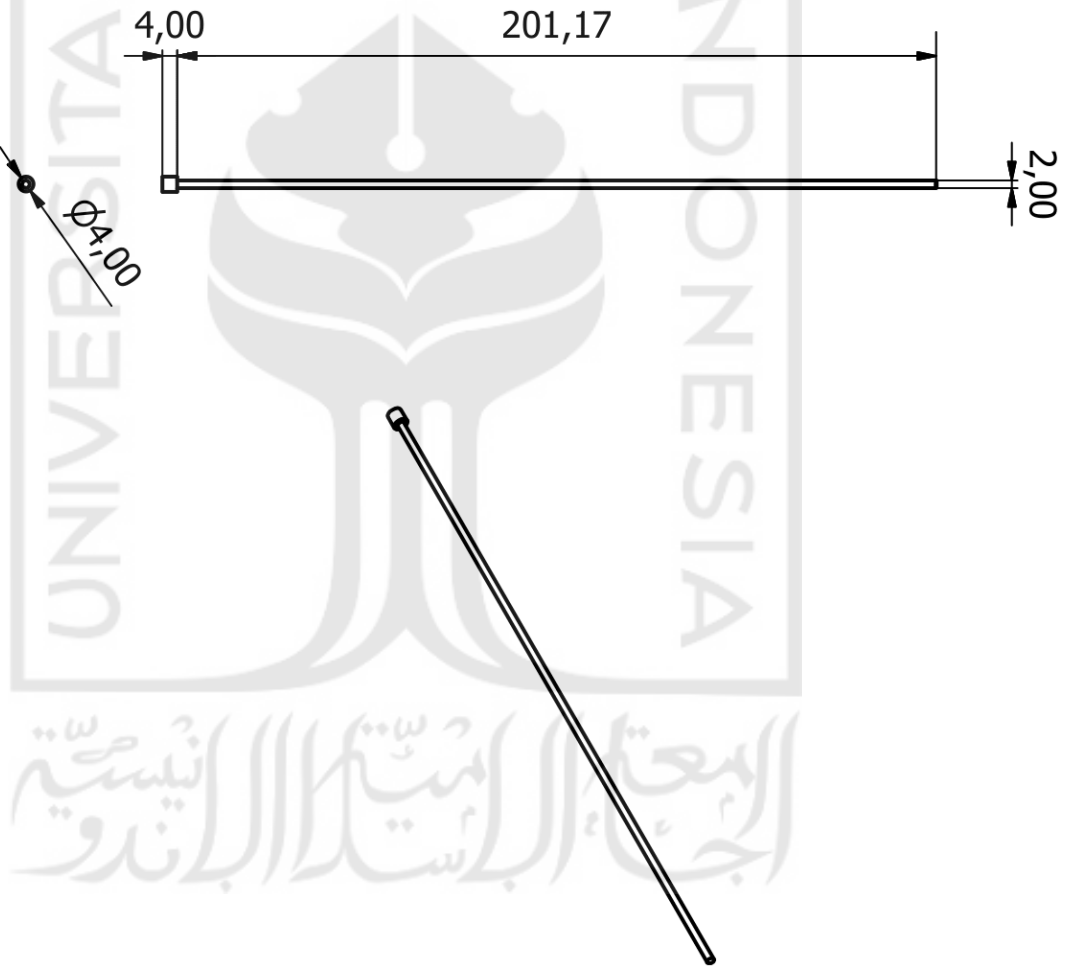
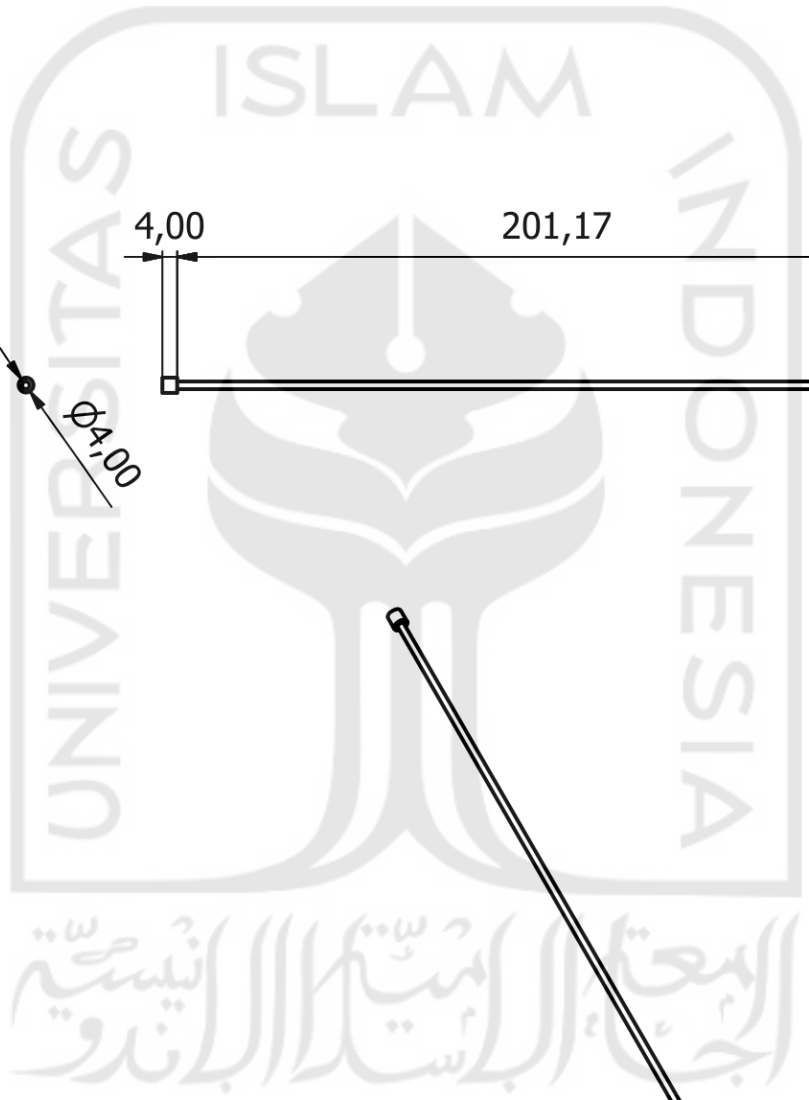

	Skala : 1:2	Digambar : Muchlis	Keterangan :	
	Satuan Ukuran : mm	NIM : 14525014		
Tanggal : 27-06-19	Diperiksa : Arif Budi Wicaksono S.T., M.Eng.			
Teknik Mesin-FTI UII		Pin Ejector 1	No.	A4

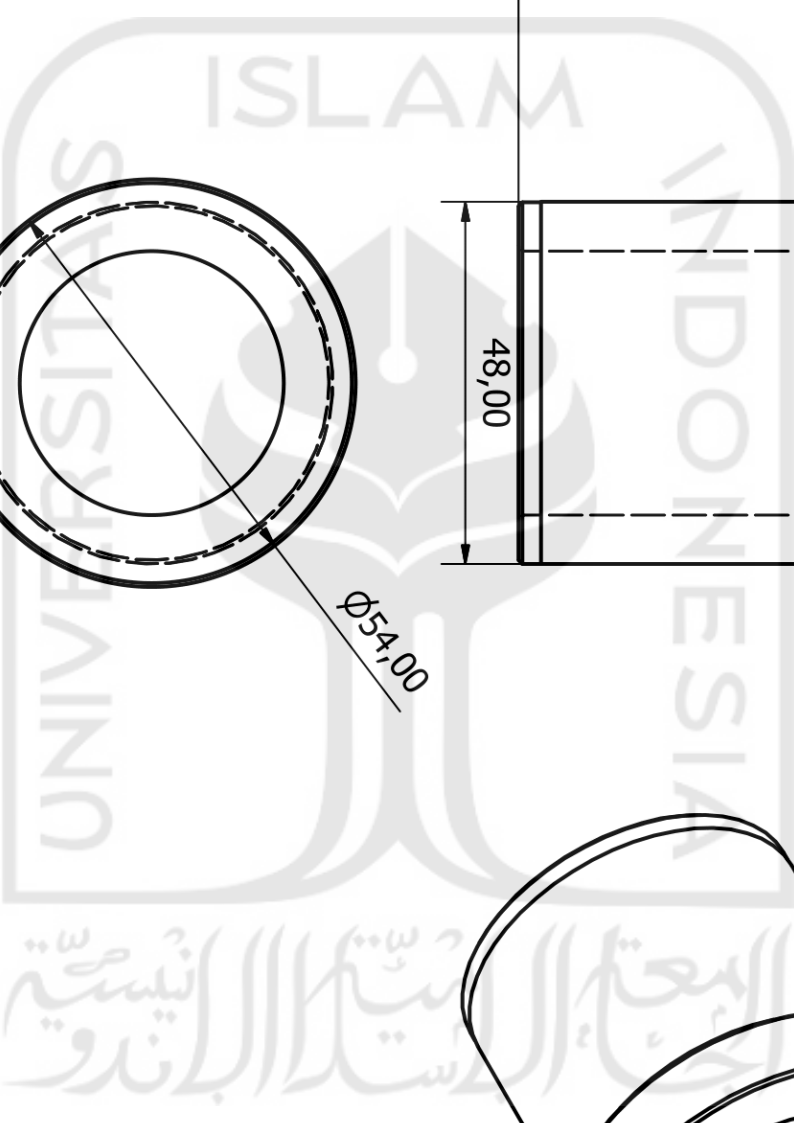
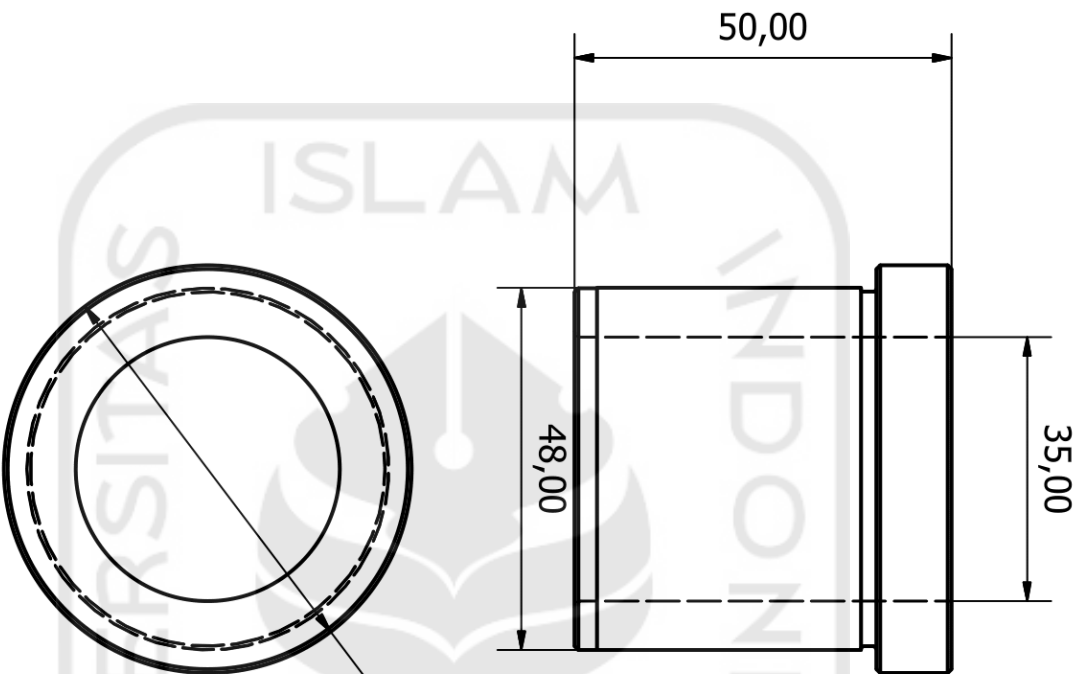

	Skala : 1:1	Digambar : Muchlis	Keterangan :
	Satuan Ukuran : mm	NIM : 14525014	
Tanggal : 27-06-19	Diperiksa : Arif Budi Wicaksono S.T., M.Eng.		
Teknik Mesin-FTI UII		SGB 35x50	
No.		A4	

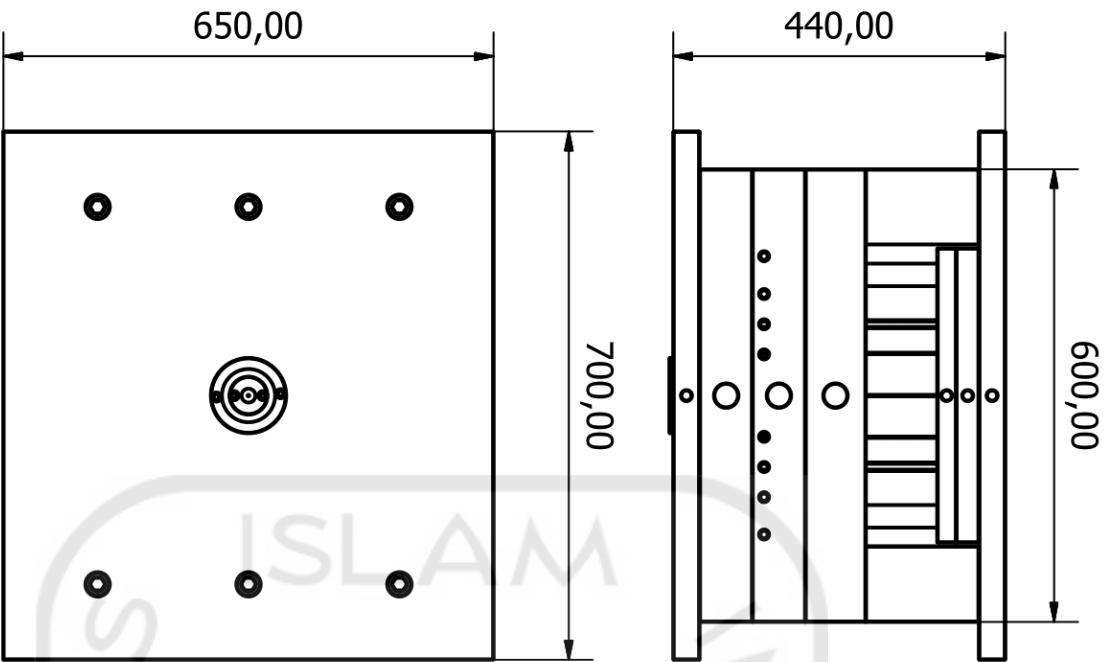

[1:10]

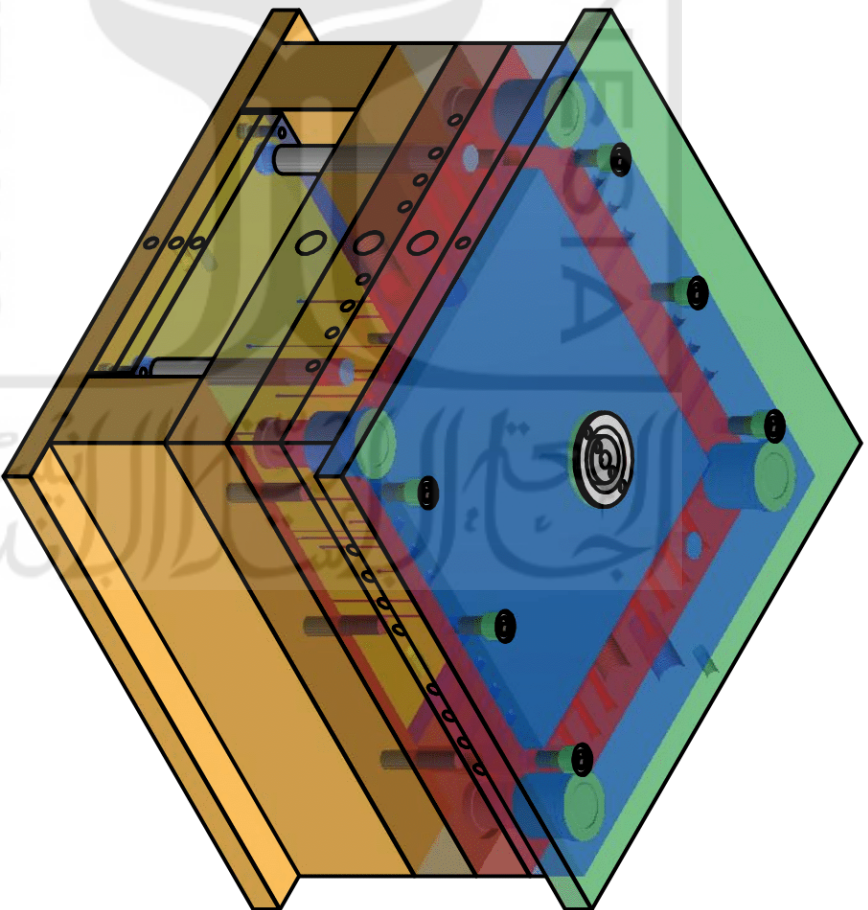

[1:8]



Skala :	Digambar : Muchlis
Satuan Ukuran : mm	NIM : 14525014
Tanggal : 27-06-19	Diperiksa : Arif Budi Wicaksono S.T., M.Eng.

Keterangan :

Teknik Mesin-FTI UII

MOLD UNIT RADIAL

No.

A4

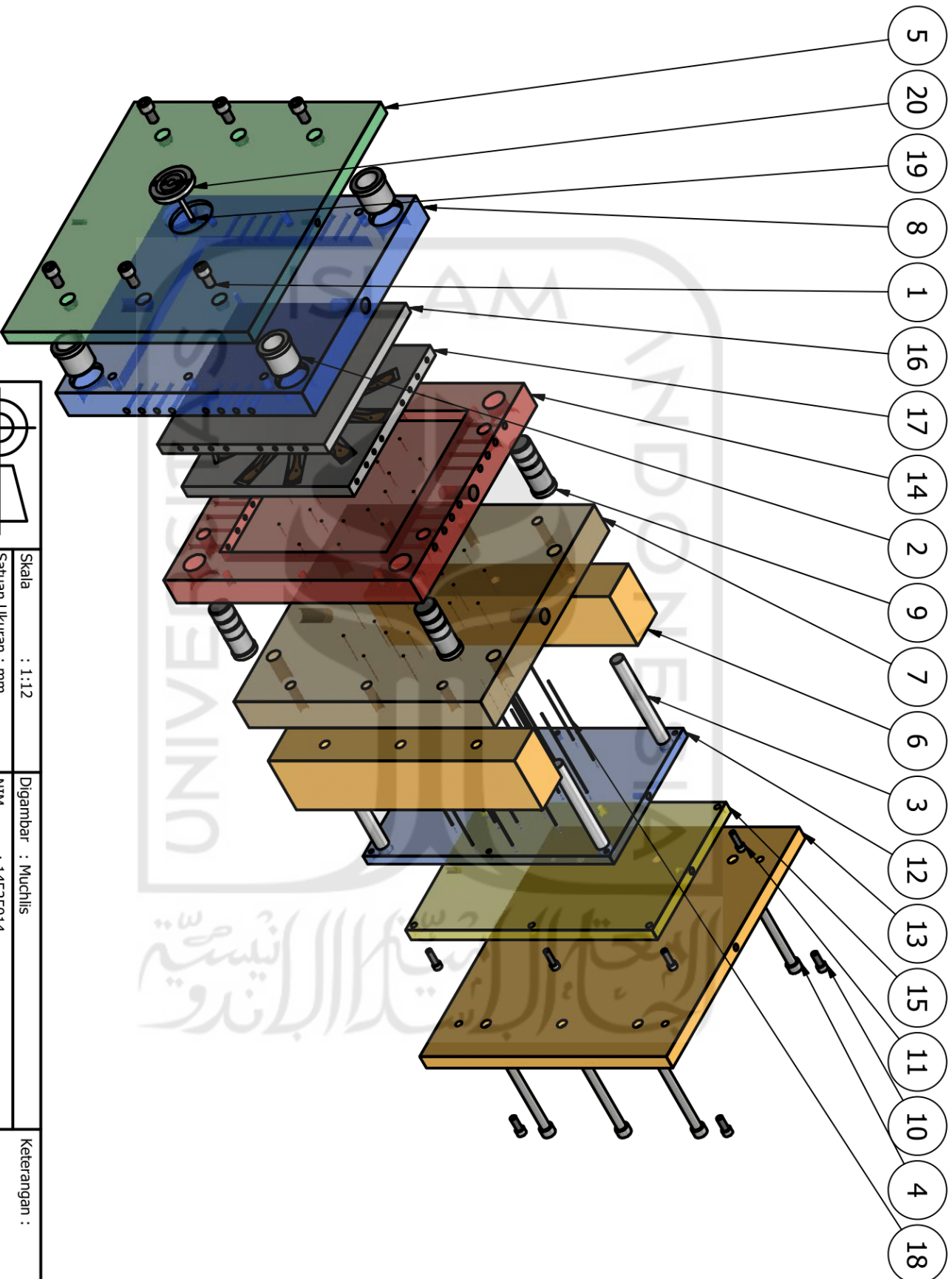

Skala : 1:12
 Satuan Ukuran : mm
 Tanggal : 27-06-19
 Digambar : Muchlis
 NIM : 14525014
 Diperiksa : Arif Budi Wicaksono S.T., M.Eng.

Keterangan :

Teknik Mesin-FTI UII

MOLD UNIT RADIAL

No.

A4

PARTS LIST

ITEM	QTY	PART NUMBER	DESCRIPTION	MATERIAL	MASS
1	6	GB 70-85 M20x35	Hexagon Socket Head Cap Screw	Steel, Mild	0,174 kg
2	4	SGB 50x70	Shoulder Guide Bush	SUJ 2	1,098 kg
3	4	RETURN PIN_LKM30x270	Return Pin	SUJ 2	1,514 kg
4	6	GB 70-85 M20x260	Hexagon Socket Head Cap Screw	Steel, Mild	0,729 kg
5	1	S-I-TCP-650x700x35x500	Top Clamping Plate	S 55 C	123,171 kg
6	2	S-I-SB-650x600x150	Spacer Block	S 55 C	75,182 kg
7	1	S-SP-650x600x80	Support Plate	S 55 C	240,476 kg
8	1	S-I-AP-650x600x70	Cavity Plate	S 55 C	158,216 kg
9	4	GP50x140x59	GUIDE PIN	SUJ 2	2,167 kg
10	4	GB 70-85 M14x35	Hexagon Socket Head Cap Screw	Steel, Mild	0,072 kg
11	6	GB 70-85 M12x40	Hexagon Socket Head Cap Screw	Steel, Mild	0,055 kg
12	1	S-ERP-650x390x25	Ejector Retainer Plate	S 55 C	48,895 kg
13	1	S-I-BCP-650x700x35x500	Bottom Clamping Plate	S 55 C	123,471 kg
14	1	S-BP-650x600x70	Core Plate	S 55 C	160,196 kg
15	1	S-EP-650x390x30	Ejector Plate	S 55 C	59,293 kg
16	1	molunit radial_Combined CV1	Cavity	SKD 11	4,894 kg
17	1	molunit radial_Combined CR1	Core	SKD 11	5,403 kg
18	20	EP4N2-300	STRAIGHT EJECTOR PINS	SKD 61	0,007 kg
19	1	SBBE10-95-SR10,5-P2-A1	SPRUE BUSHINGS—NORMAL BOLT TYPE:15mm THICK FLANGE—	Nickel alloy	0,299 kg
20	1	LR-100-50	Locating Ring	S 45 C	0,608 kg



Skala : 1:1
Satuan Ukuran : mm
Tanggal : 27-06-19

Digambar : Muchlis
NIM : 14525014
Diperiksa : Arif Budi Wicaksono S.T., M.Eng.

Keterangan :

Teknik Mesin-FTI UII

PART LIST MOLD UNIT RADIAL

No.

A4

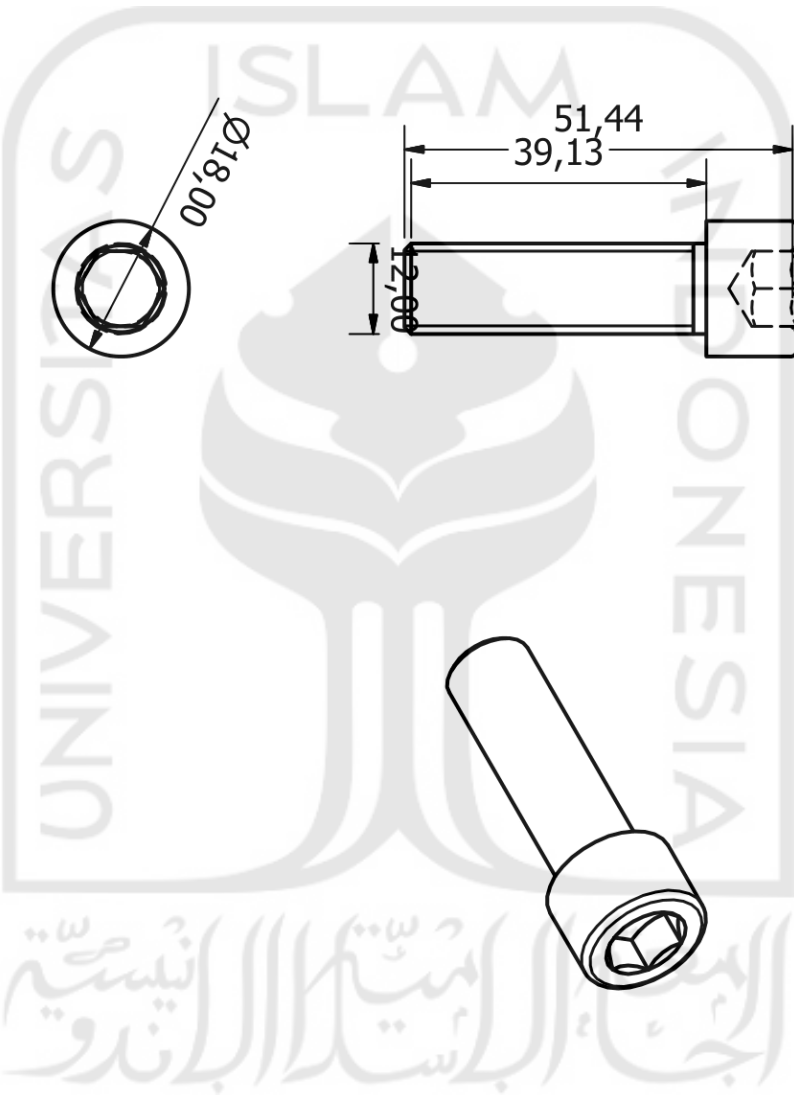
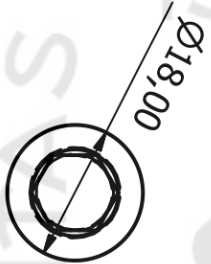
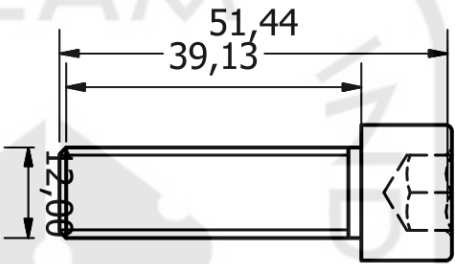

Skala : 1:1
 Satuan Ukuran : mm
 Tanggal : 27-06-19

Digambar : Muchlis
 NIM : 14525014
 Diperiksa : Arif Budi Wicaksono S.T., M.Eng.

Keterangan :

Teknik Mesin-FTI UII

GB 70-85 M12x40

No.

A4

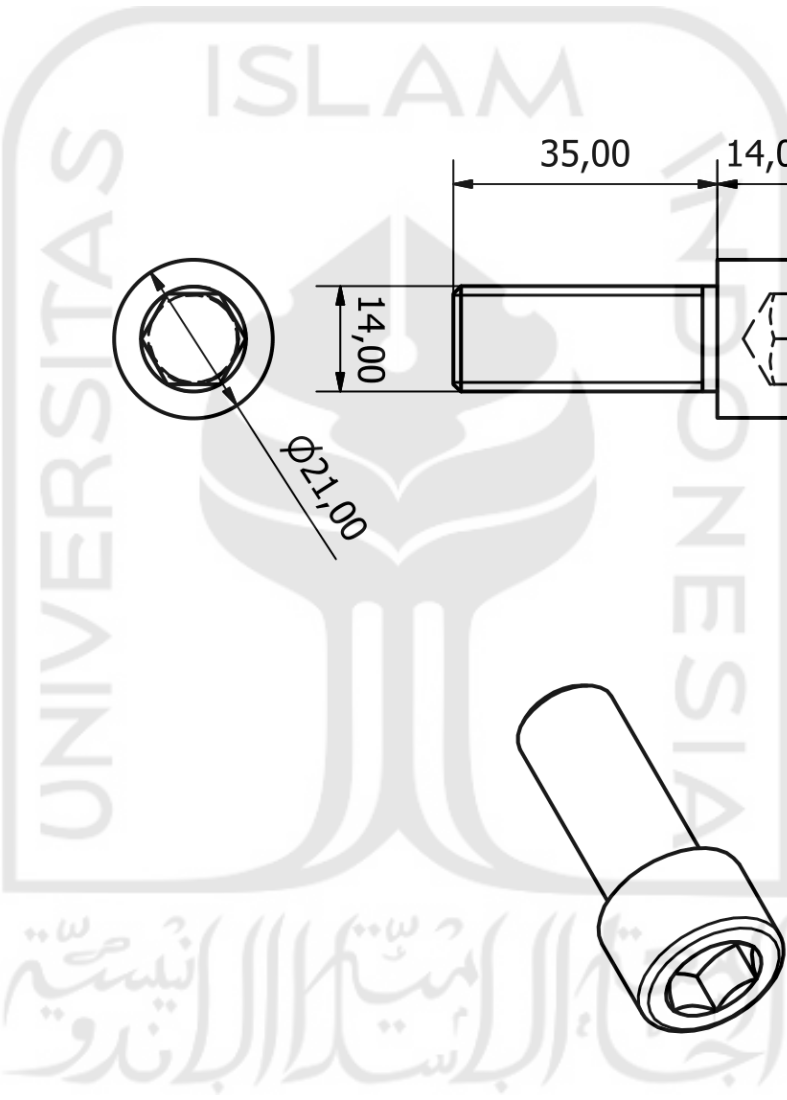
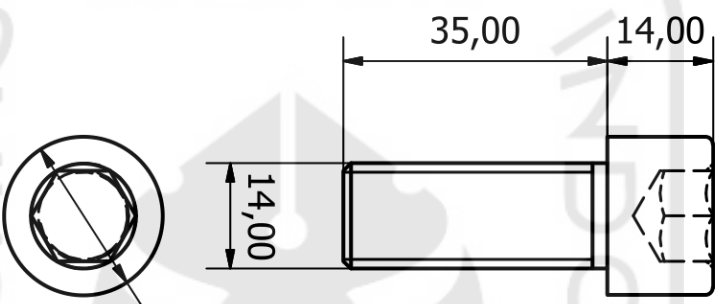

Skala : 1:1	Digambar : Muchlis
Satuan Ukuran : mm	NIM : 14525014
Tanggal : 27-06-19	Diperiksa : Arif Budi Wicaksono S.T., M.Eng.

Keterangan :

Teknik Mesin-FTI UII		GB 70-85 M14x35		No.		A4	
----------------------	--	-----------------	--	-----	--	----	--

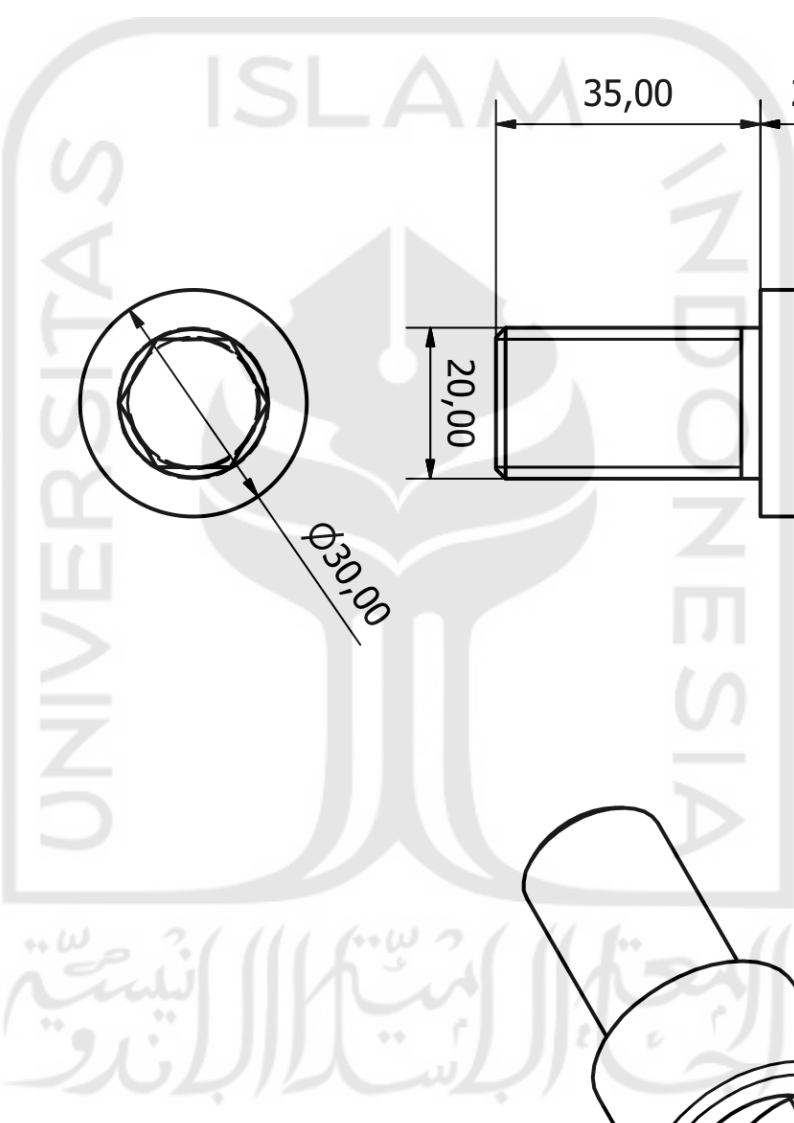
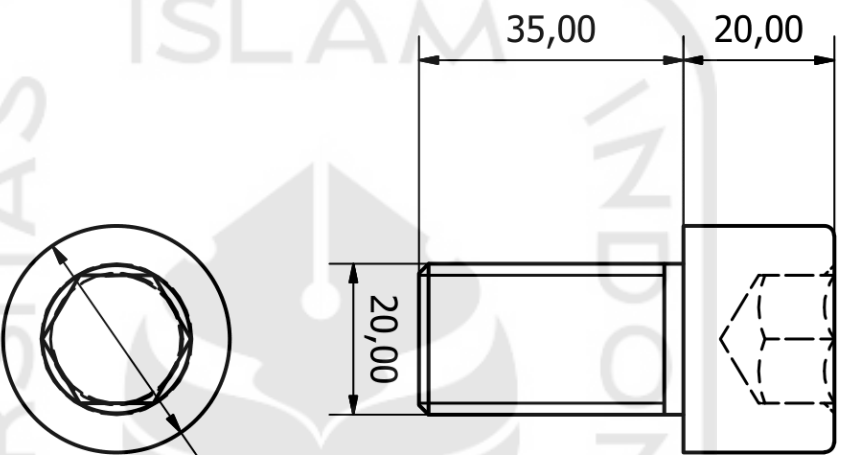

Skala : 1:1
 Satuan Ukuran : mm
 Tanggal : 27-06-19

Digambar : Muchlis
 NIM : 14525014
 Diperiksa : Arif Budi Wicaksono S.T., M.Eng.

Keterangan :

Teknik Mesin-FTI UII

GB 70-85 M20x35

No.

A4

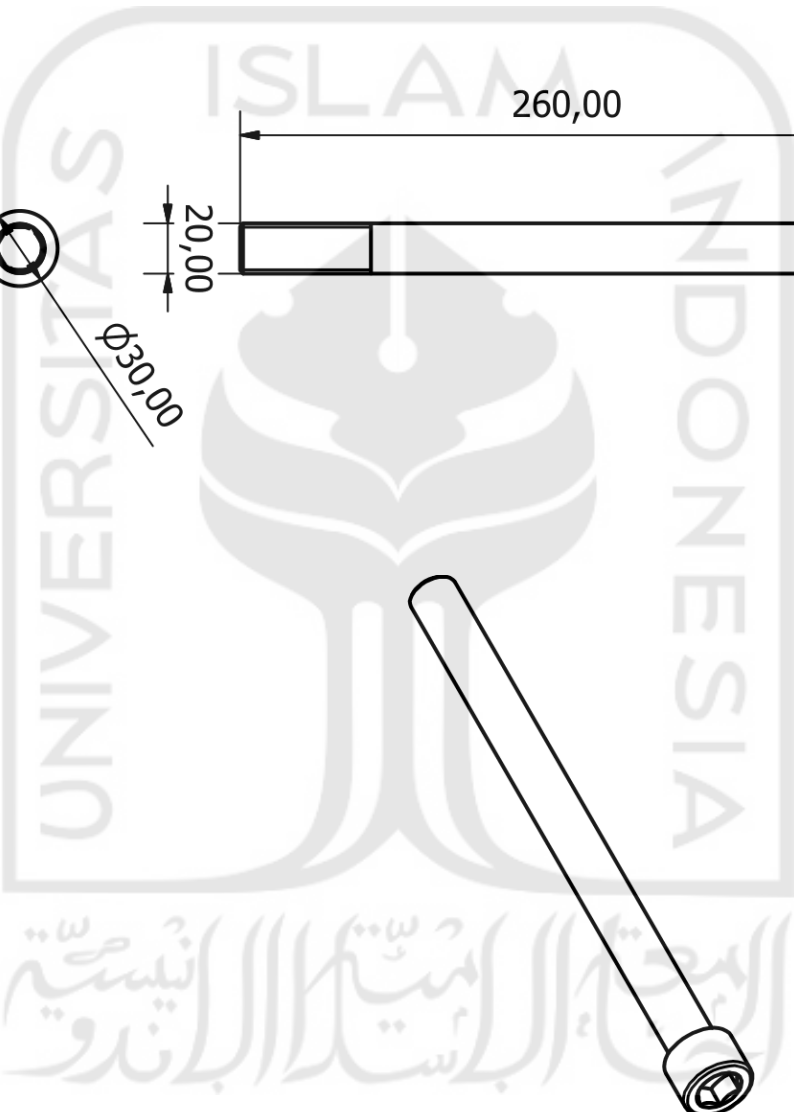
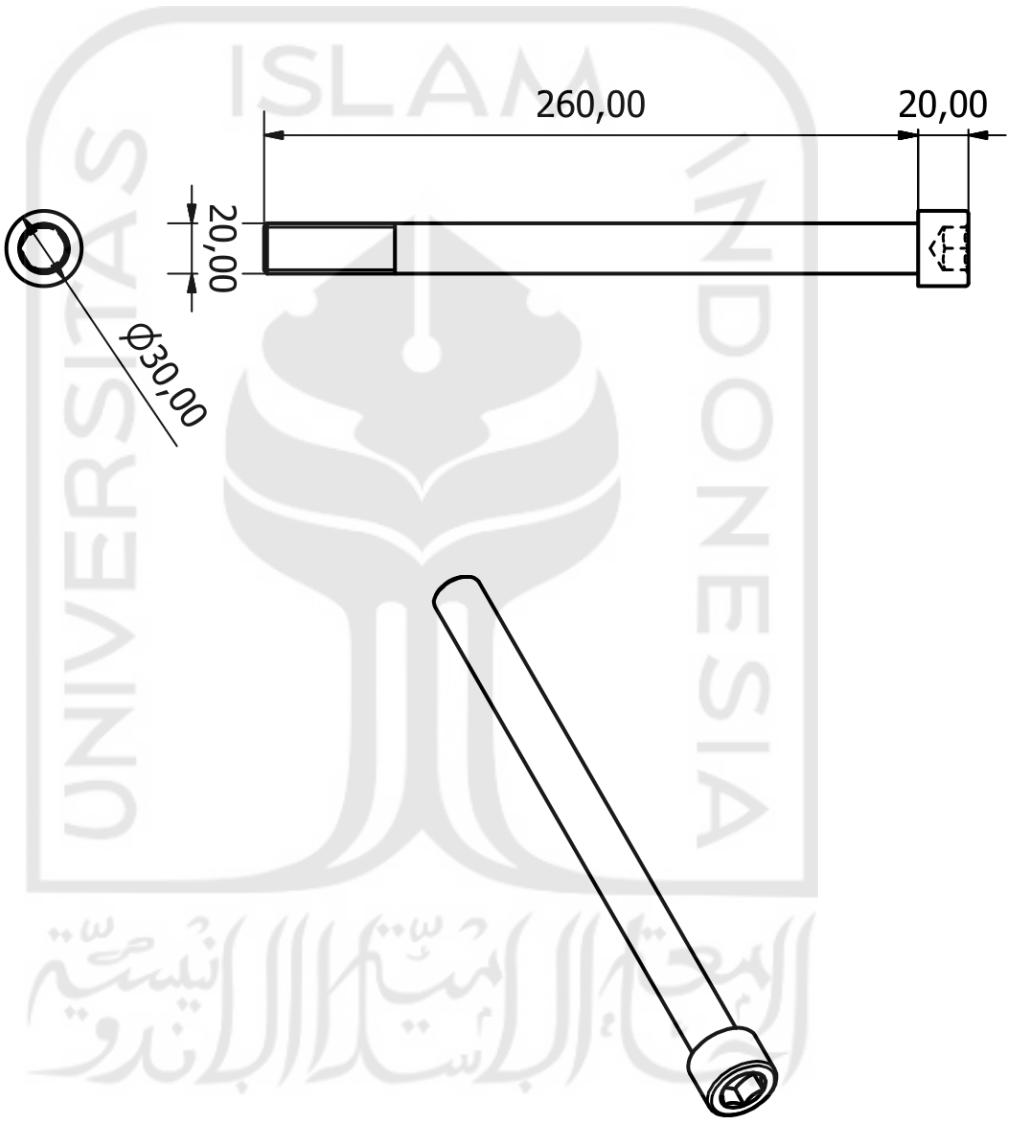

	Skala : 1:3	Digambar : Muchlis	Keterangan :
	Satuan Ukuran : mm	NIM : 14525014	
Tanggal : 27-06-19	Diperiksa : Arif Budi Wicaksono S.T., M.Eng.		
Teknik Mesin-FTI UII		GB 70-85 M20x260	No. A4

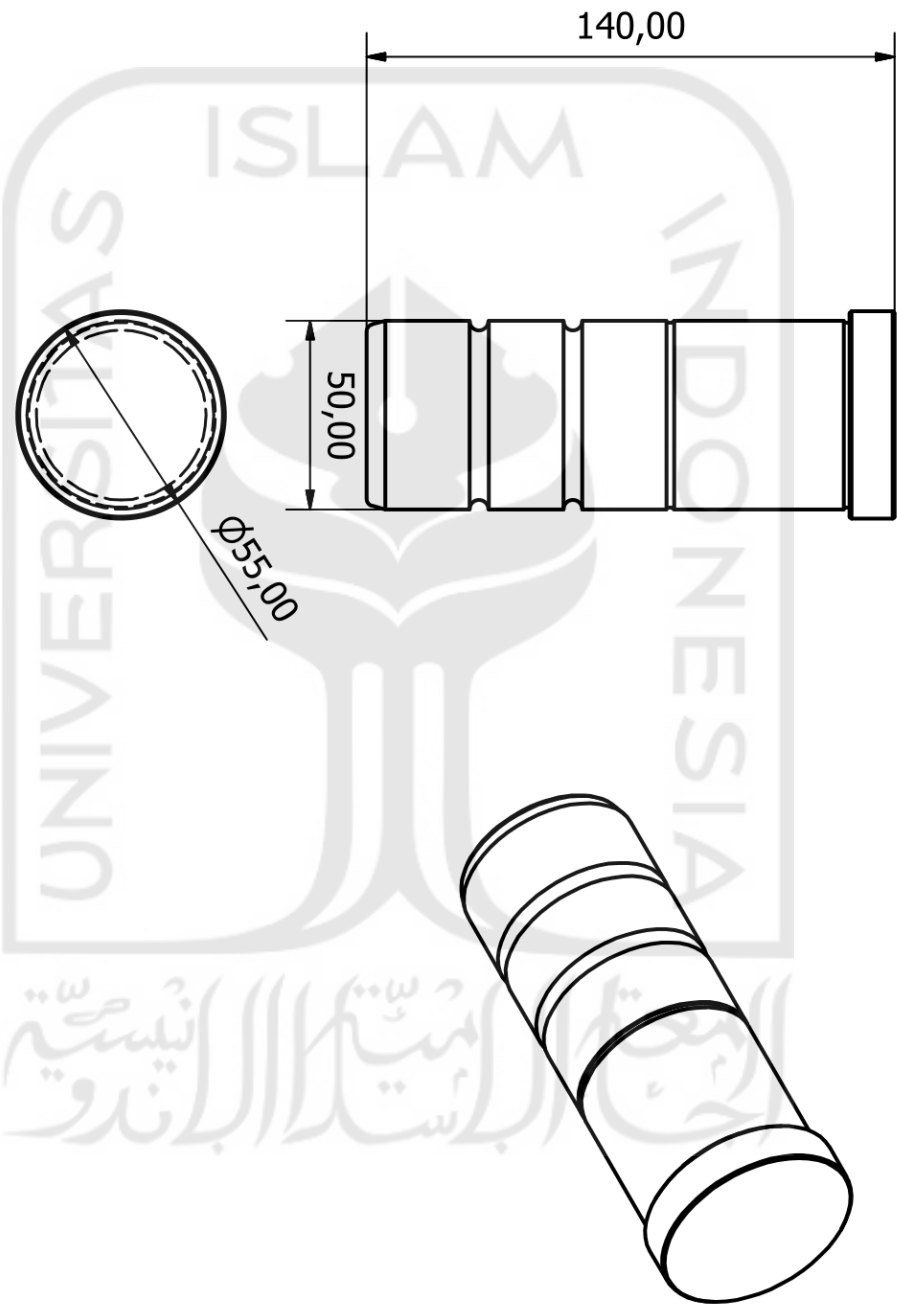

Skala : 1:2
 Satuan Ukuran : mm
 Tanggal : 27-06-19

Digambar : Muchlis
 NIM : 14525014
 Diperiksa : Arif Budi Wicaksono S.T., M.Eng.

Keterangan :

Teknik Mesin-FTI UII

GB 50X140X59

No.

A4

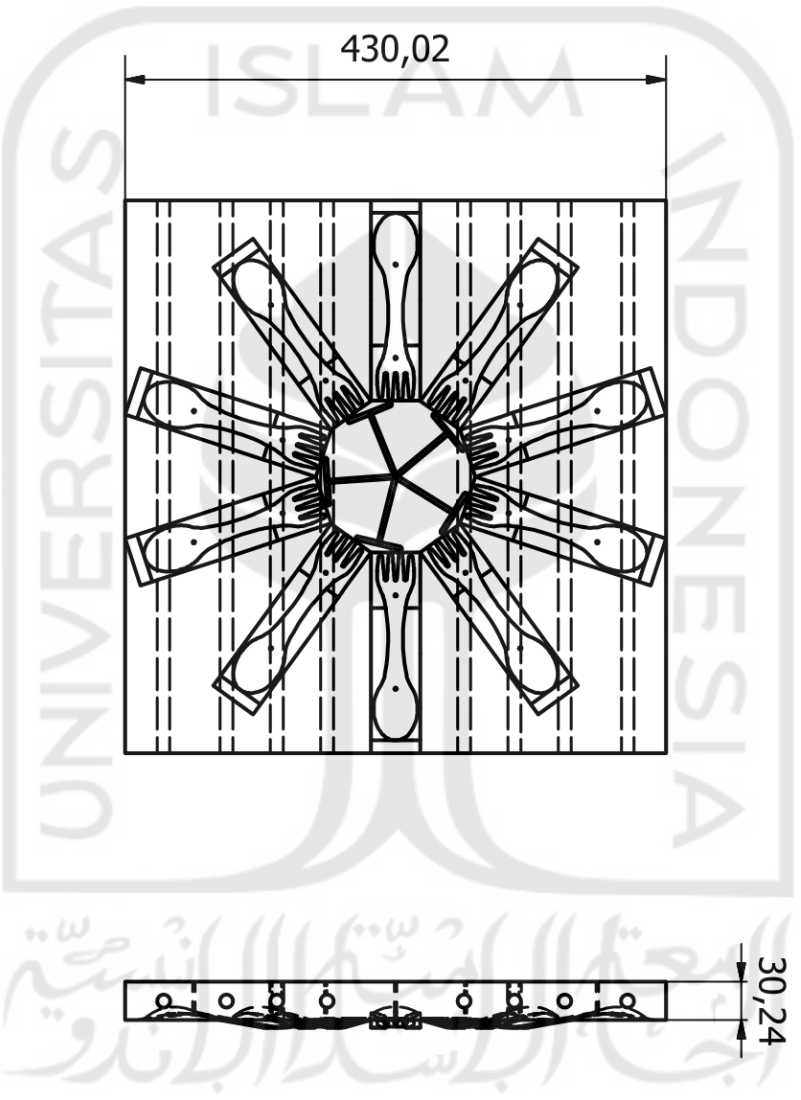
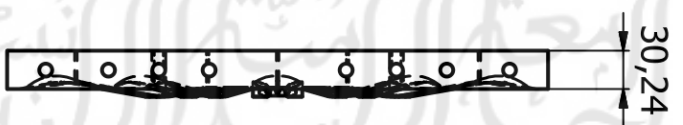
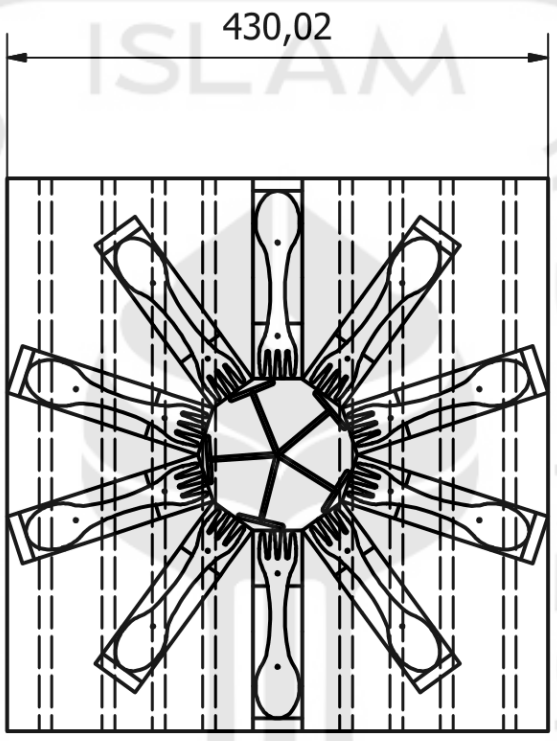
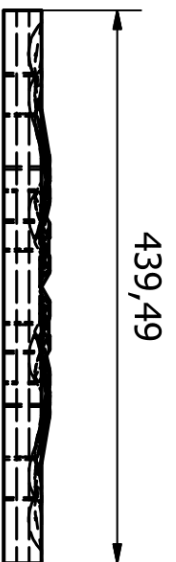

Skala : 1:6	Digambar : Muchlis
Satuan Ukuran : mm	NIM : 14525014
Tanggal : 27-06-19	Diperiksa : Arif Budi Wicaksono S.T., M.Eng.

Keterangan :

Teknik Mesin-FTI UII

Core

No.

A4

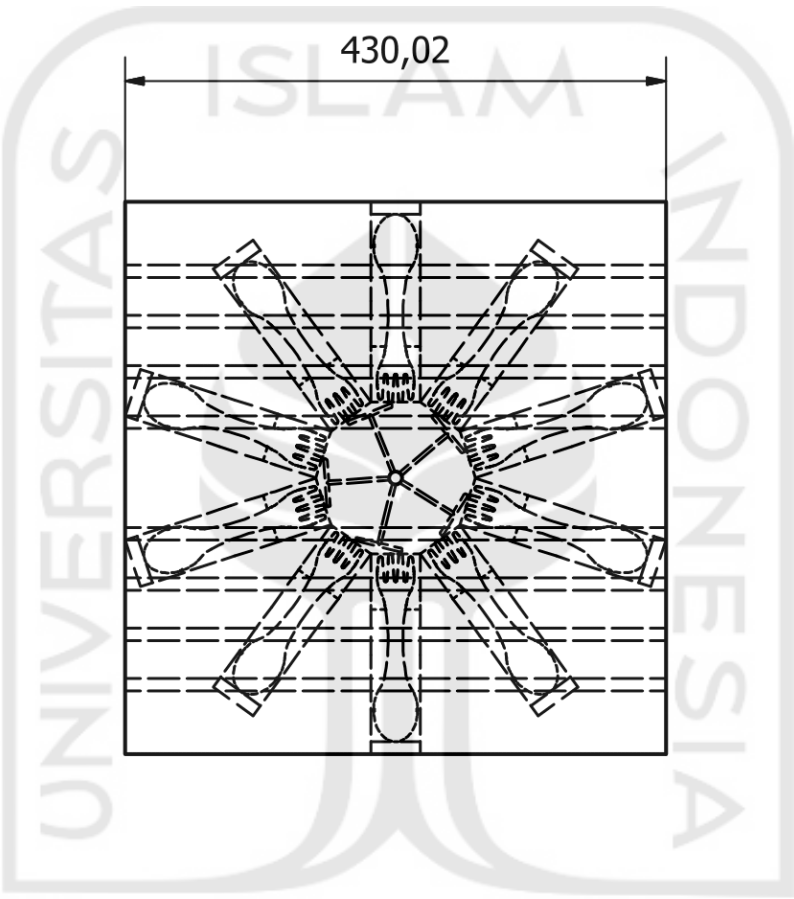
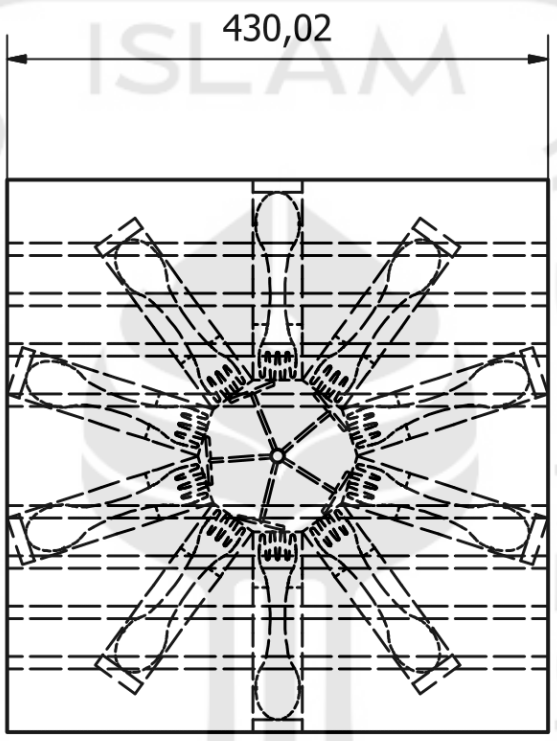
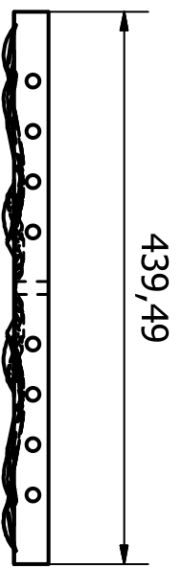

Skala	: 1:6	Digambar	: Muchlis
Satuan Ukuran	: mm	NIM	: 14525014
Tanggal	: 27-06-19	Diperiksa	: Arif Budi Wicaksono S.T., M.Eng.

Keterangan :

Teknik Mesin-FTI UII

Cavity

No.

A4

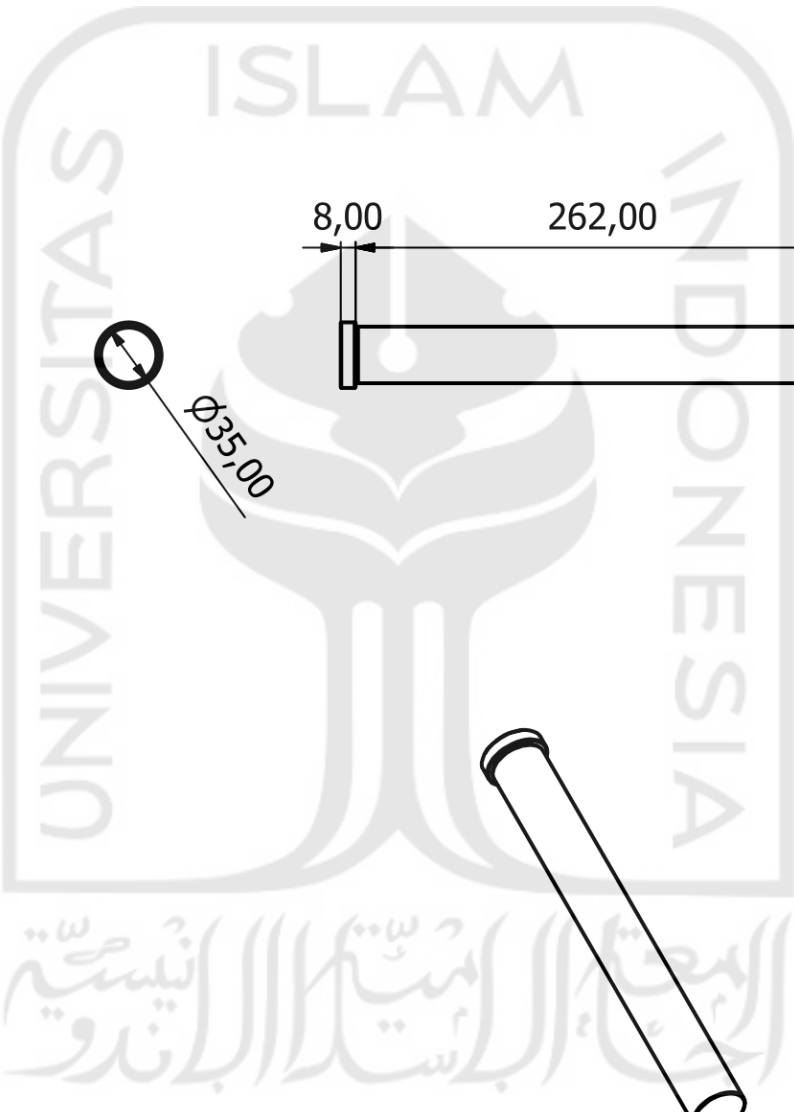

Skala : 1:4

Satuan Ukuran : mm

Tanggal : 27-06-19

Digambar : Muchlis

NIM : 14525014

Diperiksa : Arif Budi Wicaksono S.T., M.Eng.

Keterangan :

Teknik Mesin-FTI UII

Return Pin

No.

A4

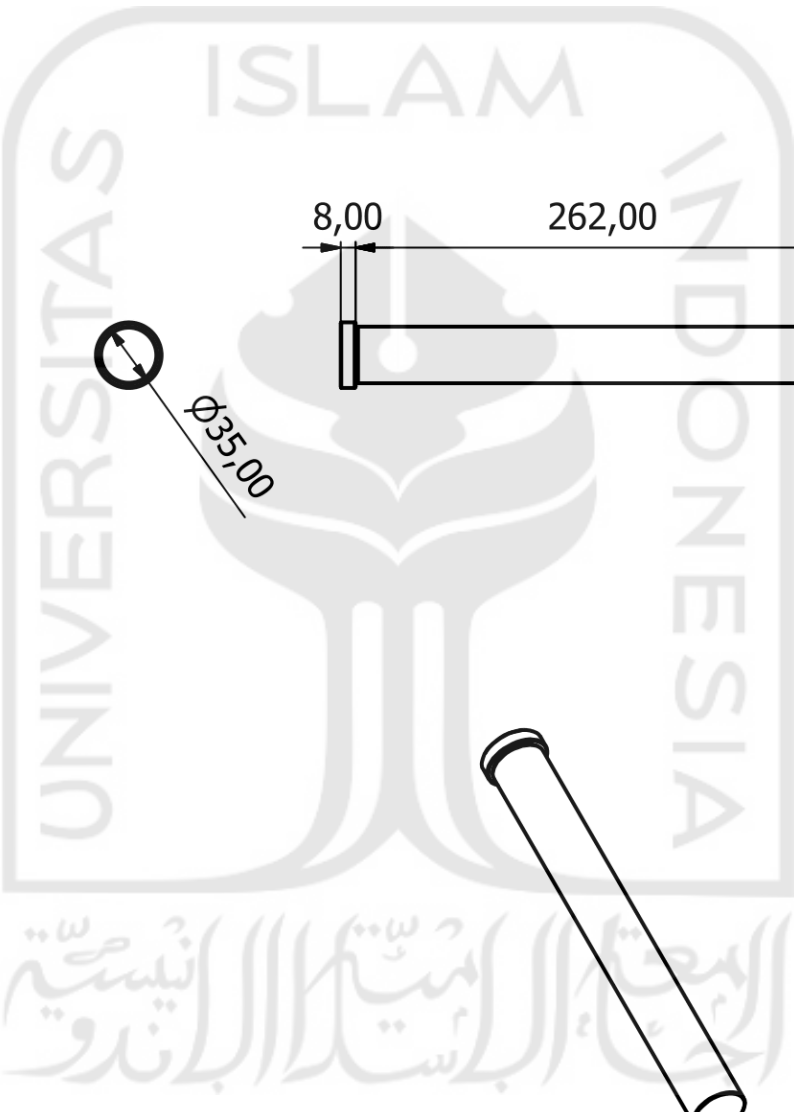

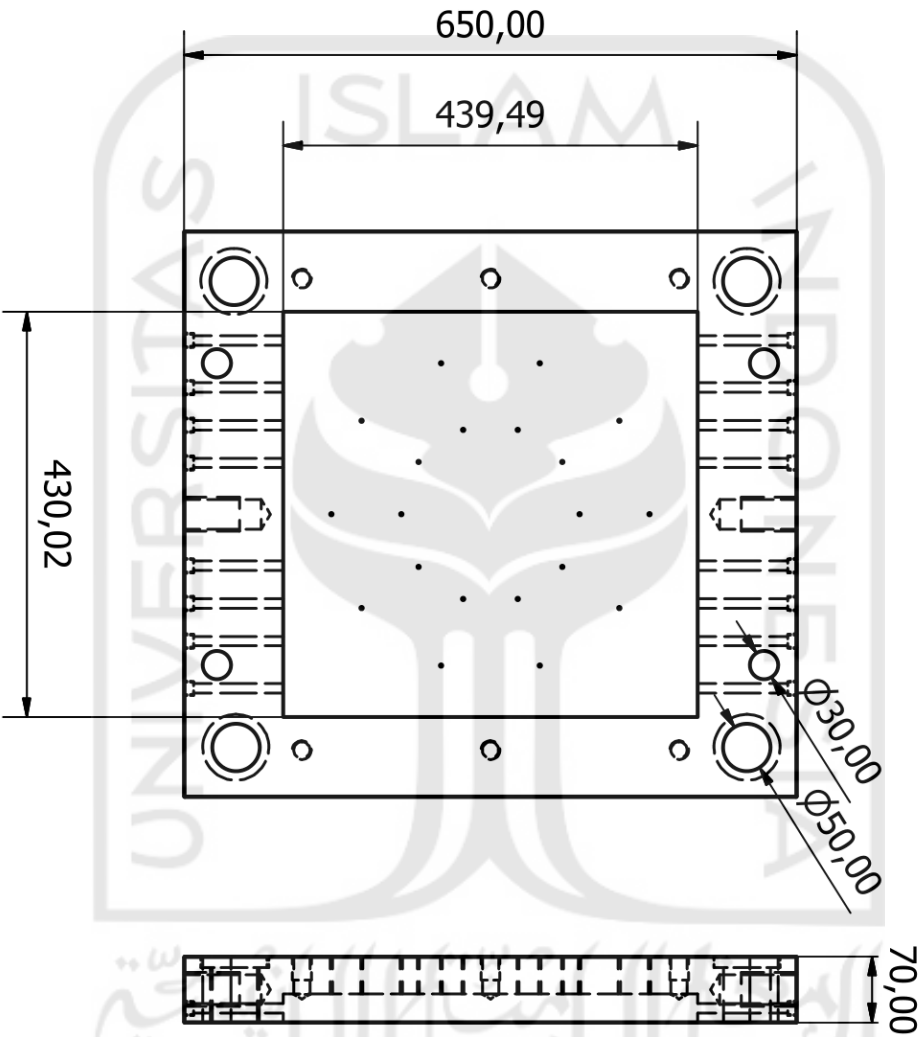
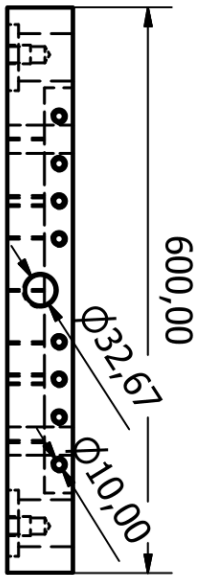

Skala : 1:8
 Satuan Ukuran : mm
 Tanggal : 27-06-19

Digambar : Muchlis
 NIM : 14525014
 Diperiksa : Arif Budi Wicaksono S.T., M.Eng.

Keterangan :

Teknik Mesin-FTI UII

Core Plate

No.

A4

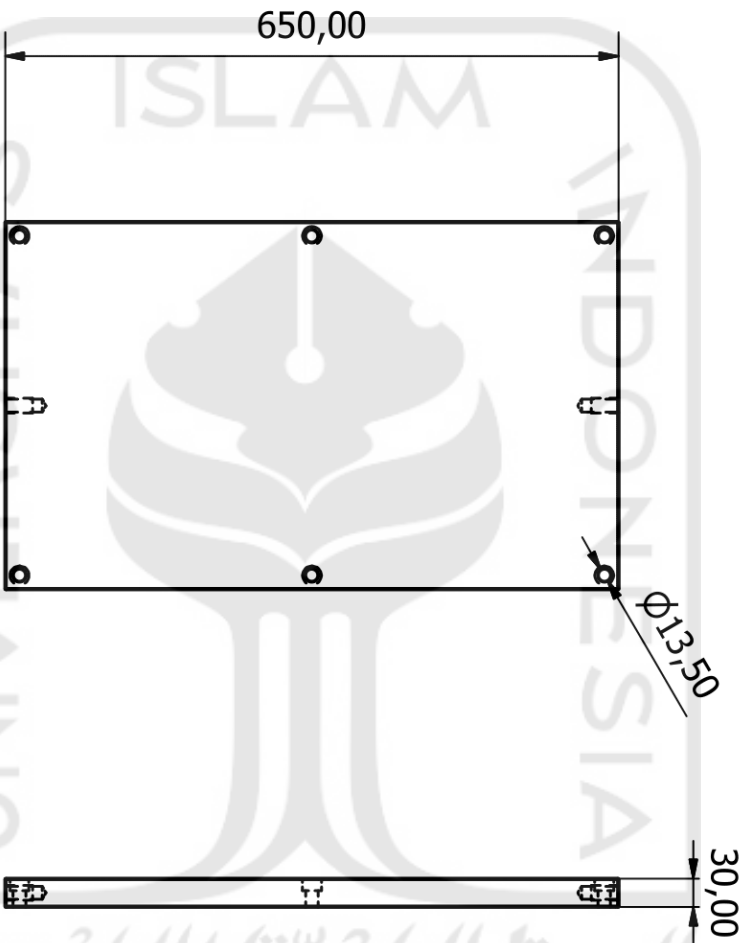
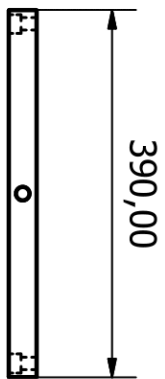

Skala : 1:8

Satuan Ukuran : mm

Tanggal : 27-06-19

Digambar : Muchlis

NIM : 14525014

Diperiksa : Arif Budi Wicaksono S.T., M.Eng.

Keterangan :

Teknik Mesin-FTI UII

Ejector Plate

No.

A4

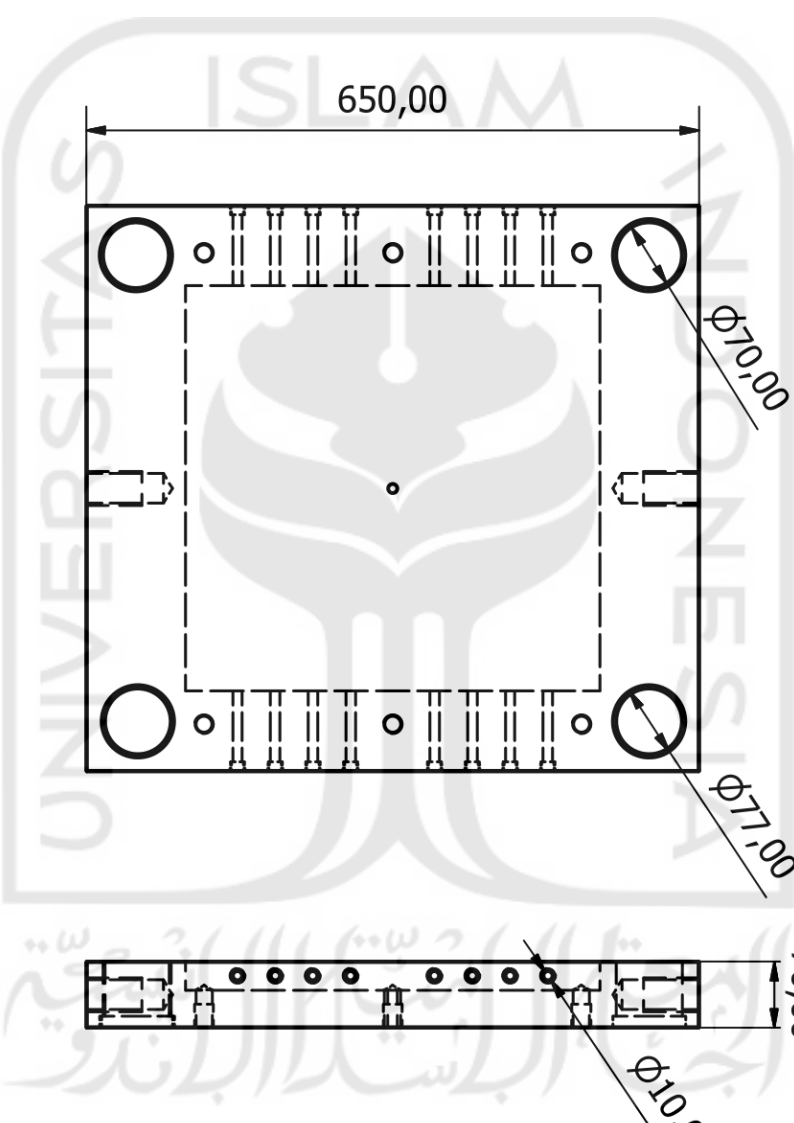

Skala : 1:8
Satuan Ukuran : mm
Tanggal : 27-06-19

Digambar : Muchlis
NIM : 14525014
Diperiksa : Arif Budi Wicaksono S.T., M.Eng.

Keterangan :

Teknik Mesin-FTI UII

Cavity Plate

No. A4

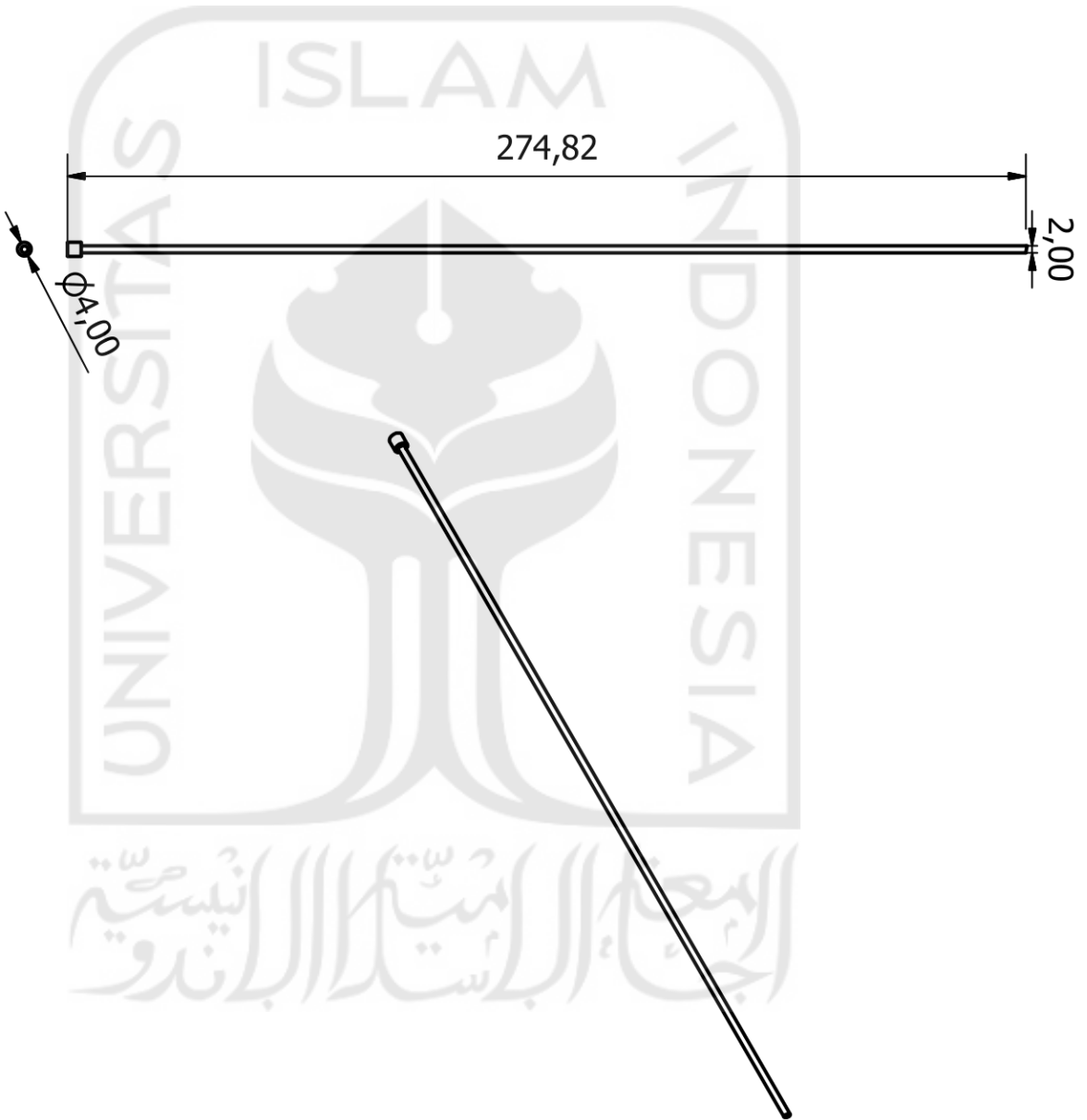

	Skala : 1:2	Digambar : Muchlis	Keterangan :
	Satuan Ukuran : mm	NIM : 14525014	
Tanggal : 27-06-19	Diperiksa : Arif Budi Wicaksono S.T., M.Eng.		
Teknik Mesin-FTI UII		Pin Ejector 1	No. A4

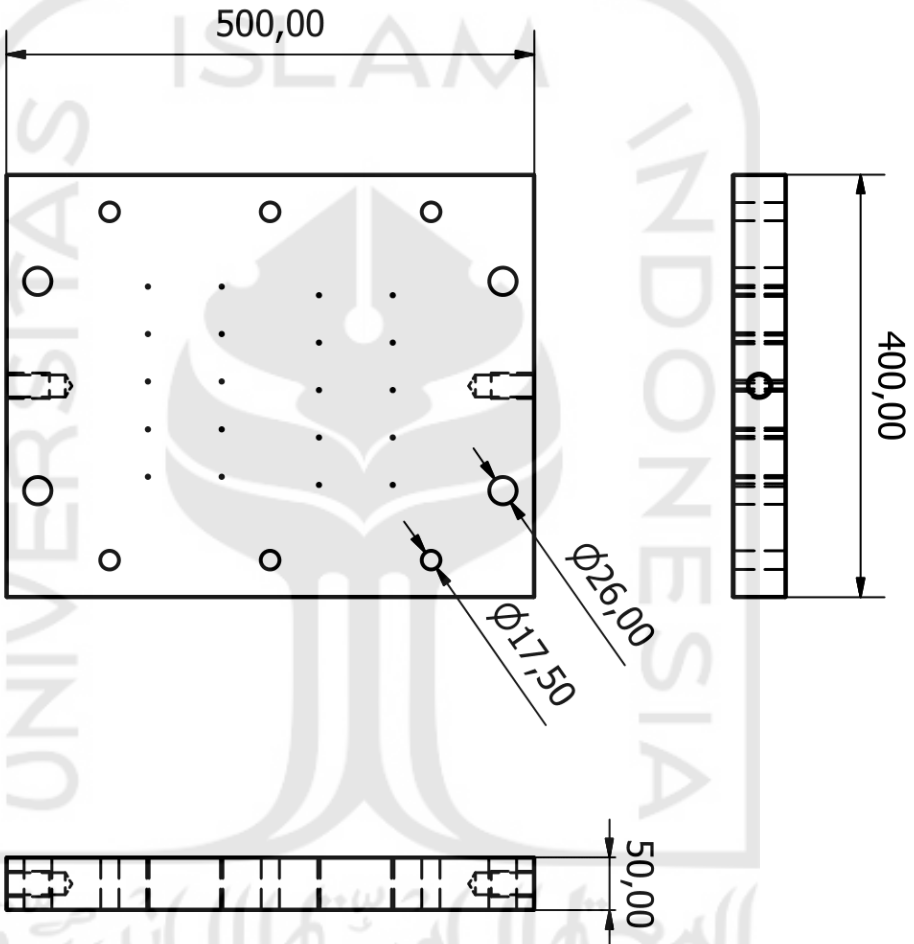

Skala : 1:6
 Satuan Ukuran : mm
 Tanggal : 27-06-19

Digambar : Muchlis
 NIM : 14525014
 Diperiksa : Arif Budi Wicaksono S.T., M.Eng.

Keterangan :

Teknik Mesin-FTI UII

Support Plate

No.

A4

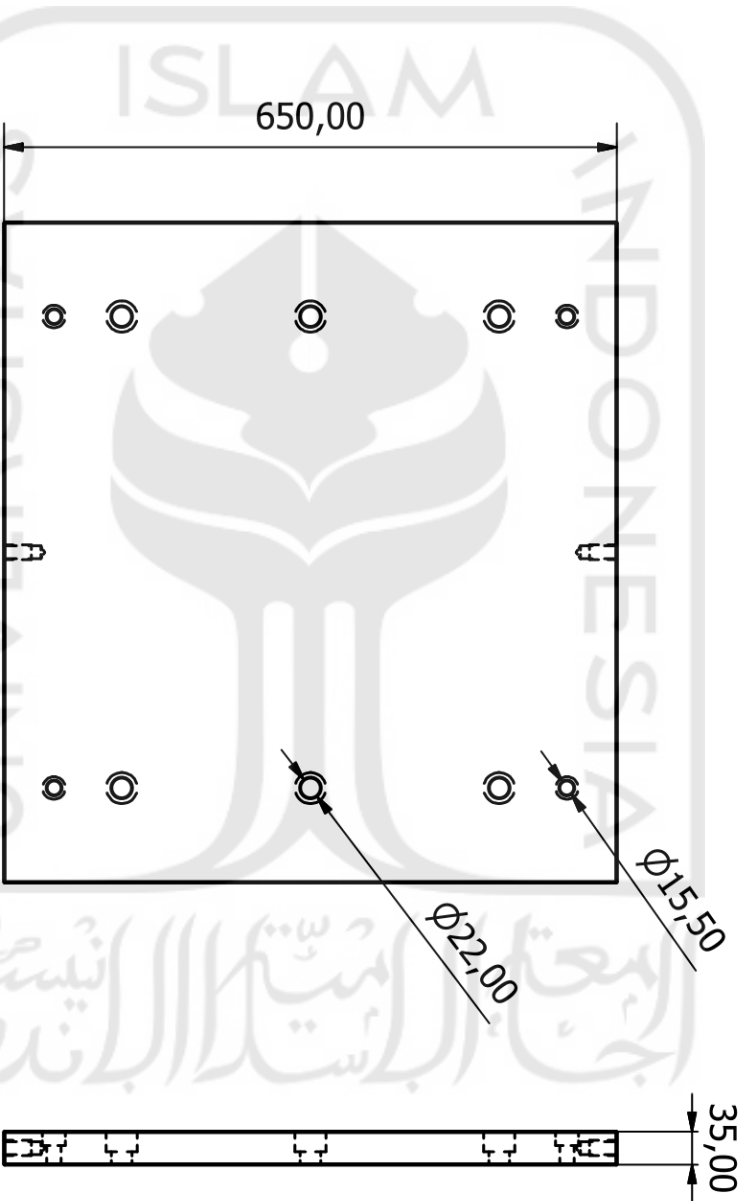
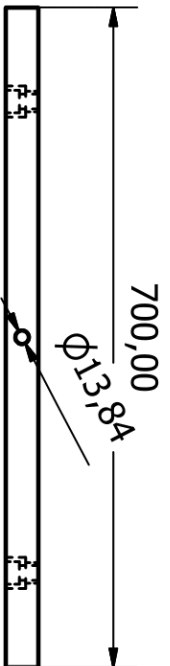

Skala : 1:8
Satuan Ukuran : mm
Tanggal : 27-06-19

Digambar : Muchlis
NIM : 14525014
Diperiksa : Arif Budi Wicaksono S.T., M.Eng.

Keterangan :

Teknik Mesin-FTI UII

Bottom Clamping Plate

No.

A4

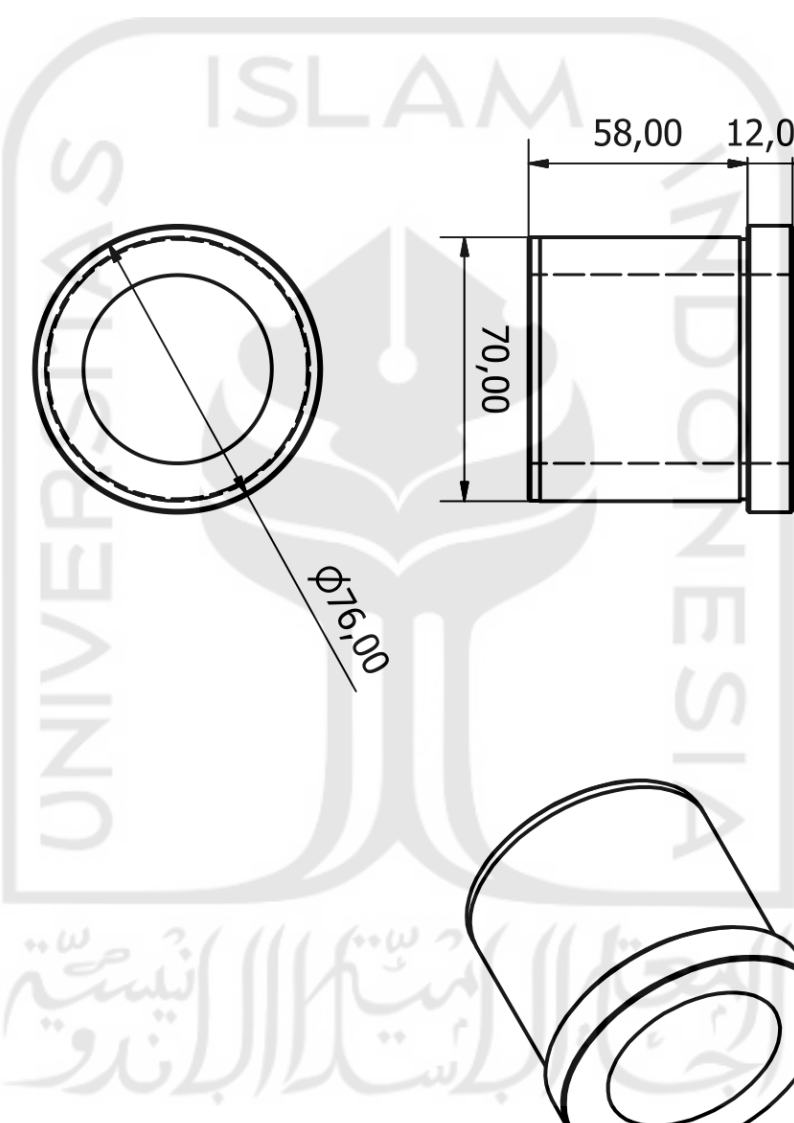
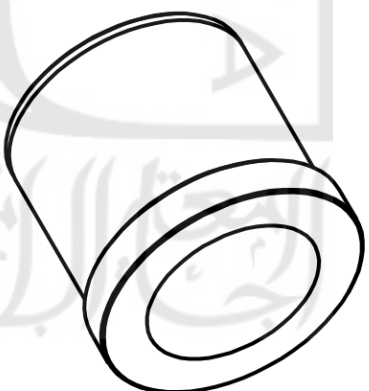
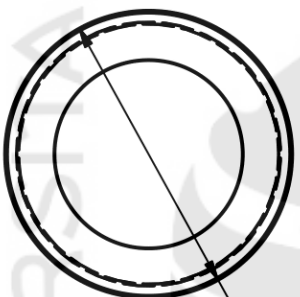
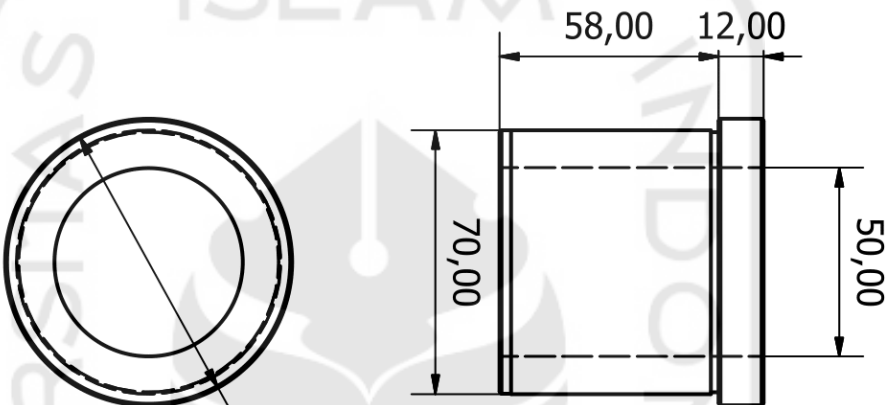

Skala : 1:1
 Satuan Ukuran : mm
 Tanggal : 27-06-19

Digambar : Muchlis
 NIM : 14525014
 Diperiksa : Arif Budi Wicaksono S.T., M.Eng.

Keterangan :

Teknik Mesin-FTI UII

SGB 50X70

No.

A4