

TOURISM INFORMATION & EXHIBITION

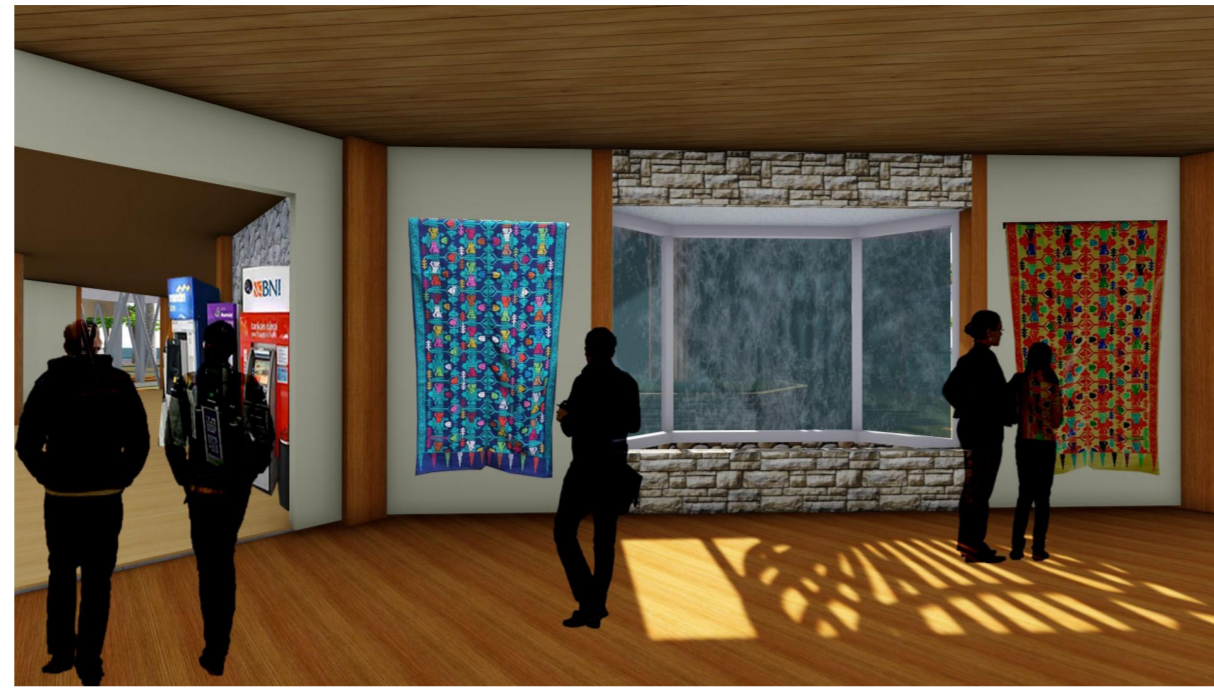

ATM CENTER & WATER WALL



PENITIPAN BARANG



AREA DISPLAY A & STORAGE TENUN

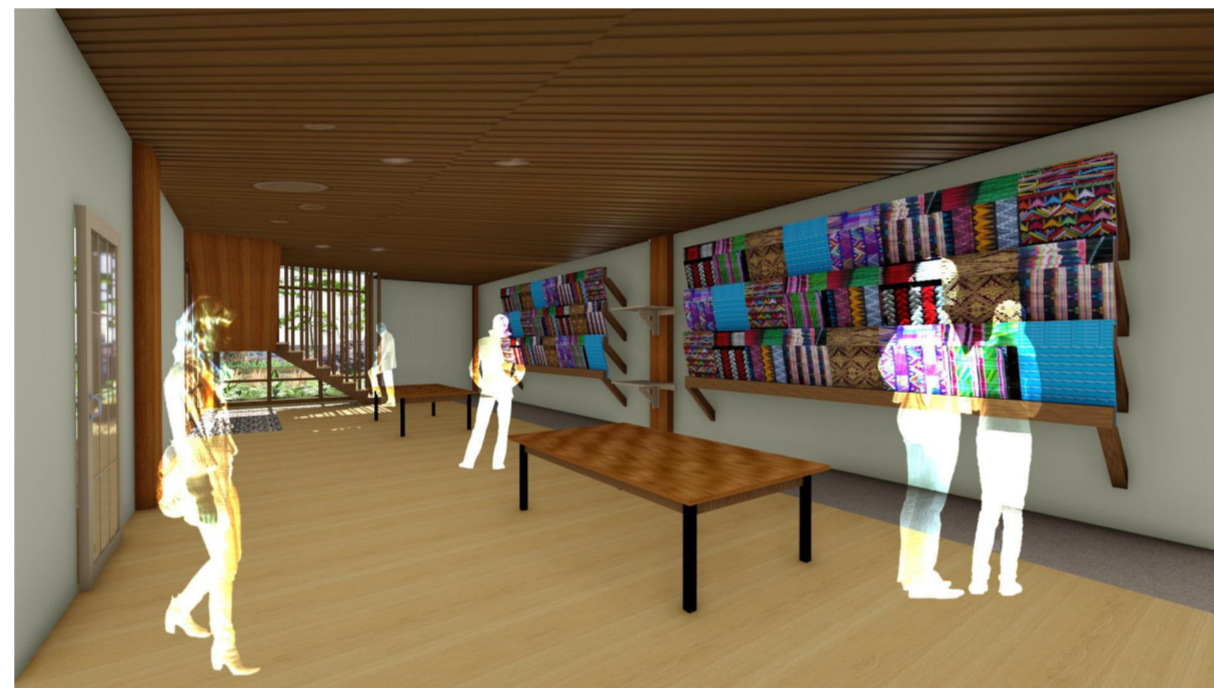

AREA DISPLAY B



INTERIOR ORNAMEN FASAD & SUN SHADING



AREA WORKSHOP TENUN



AREA DISPLAY & WORKSHOP TENUN



INTERIOR AREA DISPLAY & WORKSHOP



DEPARTMENT OF
ARCHITECTURE
FAKULTAS TEKNIK SIPIL
DAN PERENCANAAN
JL. KALIURANG KM 14,5 SLEMAN
YOGYAKARTA 55584

PROJECT NAME

Pusat Kerajinan
di Lawata Bima NTB

PROJECT YEAR

2018

PROJECT LOCATION

Lawata Kota Bima

STUDENT

NUTFAH ARISTA SAFITRI
14512120

LECTURE 1

Ir. Tony Kunto Wibisono, M.Sc

LECTURE 2

Ir. Hastuti Saptorini, M.A.

DRAWING TITLE

PRESPEKTIF INTERIOR

DRAWING SCALE

NOTE