

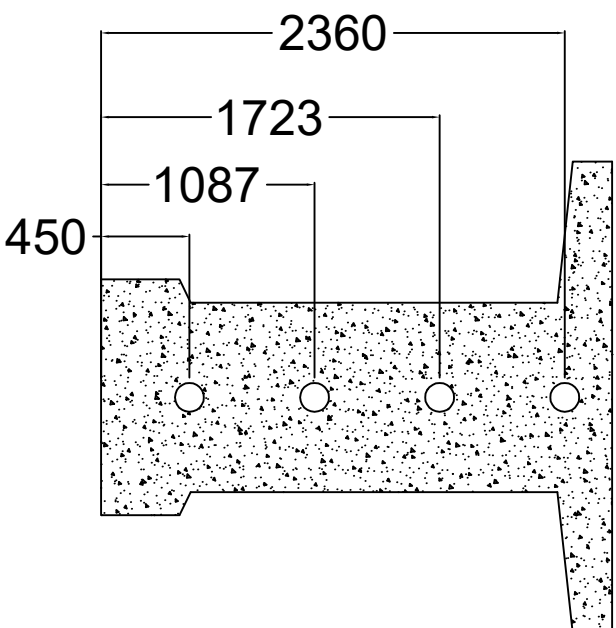

Detail Letak Tendon di Tengah Bentang Balok T Girder
skala 1 : 25

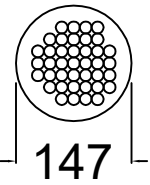

Detail Letak Tendon di Tumpuan Bentang Balok T Girder
skala 1 : 25



Detail Tendon Balok T Girder
skala 1 : 100

		TUGAS AKHIR	
Dosen Pembimbing Ir. Suharyatno, M., T.		Nama Mahasiswa Ardwiya Wulan S R 13 511 280	
Catatan 1. Beton K-800 ($f'c$) = 66,4 Mpa 2. Penulangan $D > 12$ mm (f_y) = 240 Mpa $D < 12$ mm (f_y) = 390 Mpa Baja Prategang (f_{pu}) = 1860 Mpa (f_{py}) = 1676 Mpa 3. Semua satuan dalam millimeter		Nomor Lampiran <h1 style="text-align: center;">4</h1>	